



**THT, Radial E-Cap., Snap-In, Long Life, Load Life of 5000hrs, at 105°C , ROHS Conform, Packing Box**

Items		Performance Characteristics									
Operating temperature range	-40°C +105°C (10~250V, -25°C ~ +105°C ( 350~500V)										
Leakage current max.	I=3 √cv (µA) (after 5 minutes)										
Capacitance tolerance	±20% at 120Hz, 20°C										
Dissipation factor max. (at 120Hz, 20°C)	WV	10	16	25	35	50	63	80, 100	160~400	450~500	
	TanQ	0,55	0,50	0,40	0,35	0,30	0,25	0,20	0,15	0,20	
Load life ( after application of the rated voltage for 5000hrs at 105°C)	Leakage Current									Less than specified Value	
	Capacitance Change									Within ±25% off initial Value	
	TanQ									Less than 250% of specified value	
Shelf life (at 105°C)	After 1000 hours no load test, leakage current, capacitance and tanQ are same as load life value.										

**FREQUENCY COEFFICIENT OF PERMISSIBLE RIPPLE CURRENT**

WV	Frequency	50HZ	120Hz	300Hz	1kHz	10kHz≤
~ 100		0,85	1,00	1,06	1,15	1,20
160 ~ 250		0,85	1,00	1,20	1,25	1,45
350 ~		0,85	1,00	1,15	1,20	1,40

**Technical Details**

Range (µF)	1200	∅D(mm)	25,0
Voltage	80	L(mm)	25,0
Impedance (Ω)	-.	F(mm)	10,0
Ripple Current (mA)	1,5	∅d(mm)	0
ESR (Ω) max.at 20°C 10KHz	-.	α(mm)	0
Lifetime (hrs)	5000		2,0
Operating- Temperature Range (°C)	-.40°C ~ +105°C		-.

∅D ≤ 40

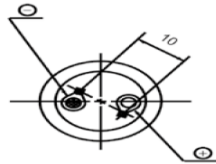
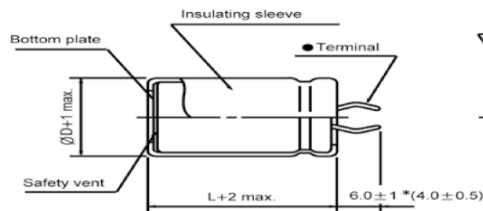

PC Board Mounting Holes

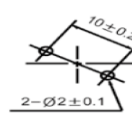

Terminal

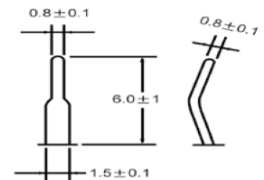

\* Shorter terminal(4.0 ± 0.5) is also available upon request.  
 Terminal length of height 20mm products is applied shorter terminal to standard terminal type.

∅D = 35, 40

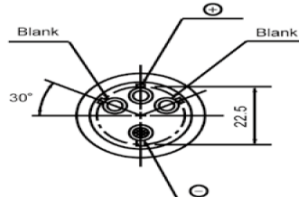
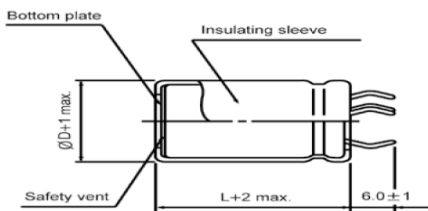

PC Board Mounting Holes

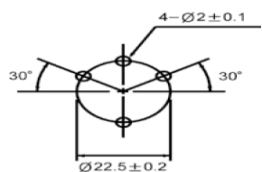

DRW:	Lexua	CHKD	Wilson	MATL:	ChuChu	DATE	15.01.2025
APPD:	Jimmy			FINISH	Josy	Sheet	1 from 2

Copyright by S.Tiede



THT, Radial E-Cap., Snap-In, Long Life, Load Life of 5000hrs, at 105°C , ROHS Conform, Packing Box

**Ordering Informations:**

Serie-No. / Voltage / Range / Size	Capacity Tolerance	ROHS	Packing
------------------------------------	--------------------	------	---------

I14085-8001222525	M	R	BU
-------------------	---	---	----

Serie	Voltage (V)	Range $\mu$ H)	D * L (mm)	Tolerance Order Code	R= ROHS N= NON ROHS	BU= Bulk-Ware (Box)

**Soldering Information**

**Lead Solder Performance**

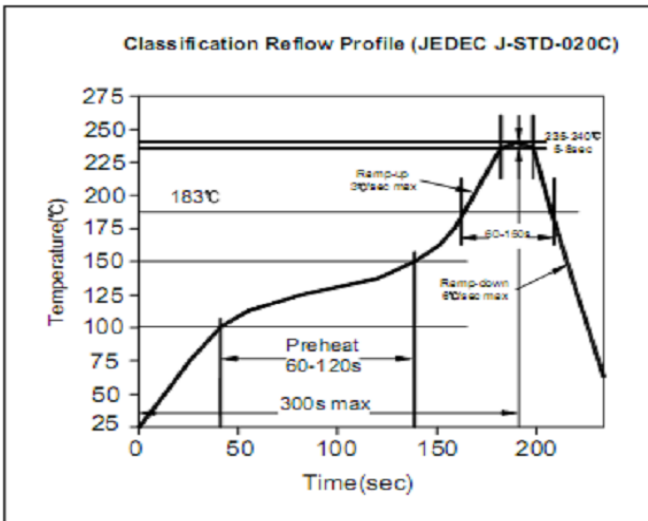

**Lead free Solder Performance**

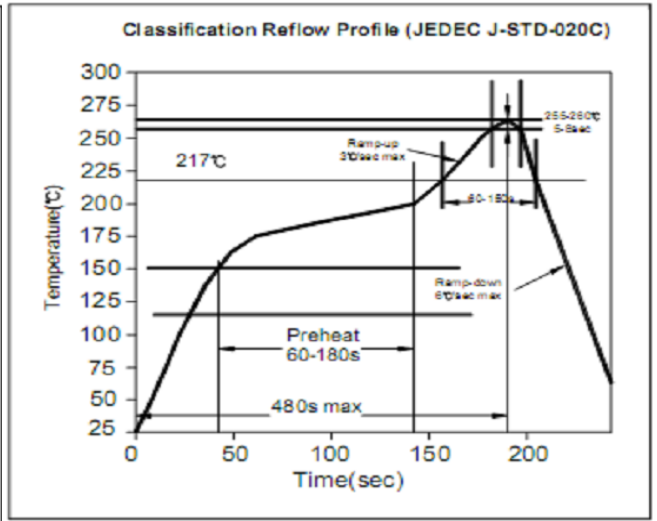

DRW:	Lexua	CHKD	Wilson	MATL:	ChuChu	DATE	15.01.2025
APPD:	Jimmy			FINISH	Josy	Sheet	2 from 2