



THT, Radial E-Cap., Snap-In, High Voltage, High Capacitance, Load Life of 3000 hrs at 85°C, ROHS Conform, Packing Box

Items		Performance Characteristics									
Operating temperature range		-40°C +85°C (10~250V, -25°C ~ +85°C (350~500V)									
Leakage current max.		I=3 √cv (µA) (after 5 minutes)									
Capacitance tolerance		±20% at 120Hz, 20°C									
Dissipation factor max. (at 120Hz, 20°C)		WV	10	16	25	35	50	63	80, 100	160~400	450~500
		TanQ	0,55	0,50	0,40	0,35	0,30	0,25	0,20	0,15	0,20
Load life (after application of the rated voltage for 3000hrs at 85°C)		Leakage Current					Less than specified Value				
		Capacitance Change					Within ±20% off initial Value				
		TanQ					Less than 200% of specified value				
Shelf life (at 85°C)		After 1000 hours no load test, leakage current, capacitance and tanQ are same as load life value.									

FREQUENCY COEFFICIENT OF PERMISSIBLE RIPPLE CURRENT

WV	Frequency	50HZ	120Hz	300Hz	1kHz	10kHz≤
~ 100		0,85	1,00	1,06	1,15	1,20
160 ~ 250		0,85	1,00	1,20	1,25	1,45
350 ~		0,85	1,00	1,15	1,20	1,40

Technical Details

Range (µF)	1800	∅D(mm)	22,0
Voltage	100	L(mm)	40,0
Impedance (Ω)	-.-	F(mm)	10,0
Ripple Current (mA)	2,76	∅d(mm)	0
ESR (Ω) max.at 20°C 10KHz	-.-	α(mm)	0
Lifetime (hrs)	3000	-.-	2,0
Operating- Temperature Range (°C)	-40°C ~ +85°C	-.-	-.-

∅D ≤ 40

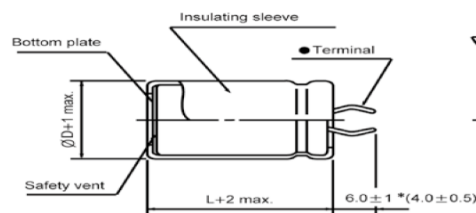

PC Board Mounting Holes

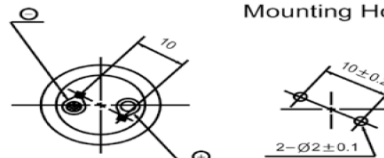

Terminal

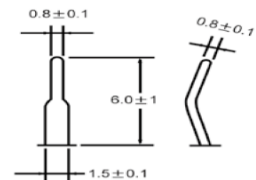

* Shorter terminal(4.0 ± 0.5) is also available upon request.
 Terminal length of height 20mm products is applied shorter terminal to standard terminal type.

∅D = 35, 40

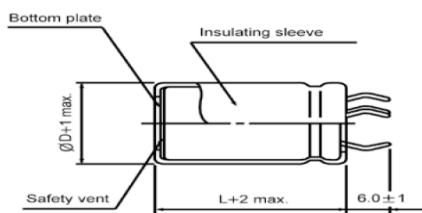

PC Board Mounting Holes

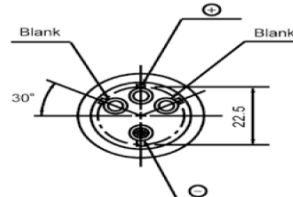

DRW:	Lexua	CHKD	Wilson	MATL:	ChuChu	DATE	03.02.2025
APPD:	Jimmy			FINISH	Josy	Sheet	1 from 2



THT, Radial E-Cap., Snap-In, High Voltage, High Capacitance, Load Life of 3000 hrs at 85°C, ROHS Conform, Packing Box

Ordering Informations:

Serie-No. / Voltage / Range / Size	Capacity Tolerance	ROHS	Packing
------------------------------------	--------------------	------	---------

I14079-1011822240	M	R	BU
-------------------	---	---	----

Serie	Voltage (V)	Range μ H)	D * L (mm)	Tolerance Order Code	R= ROHS N= NON ROHS	BU= Bulk-Ware (Box)

Soldering Information

Lead Solder Performance

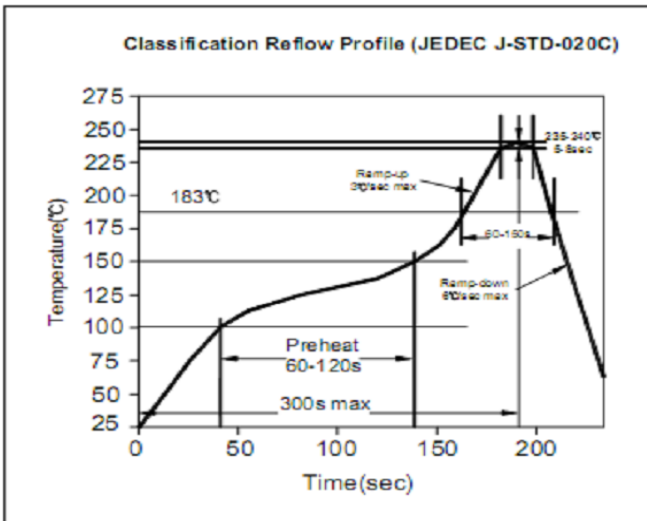

Lead free Solder Performance

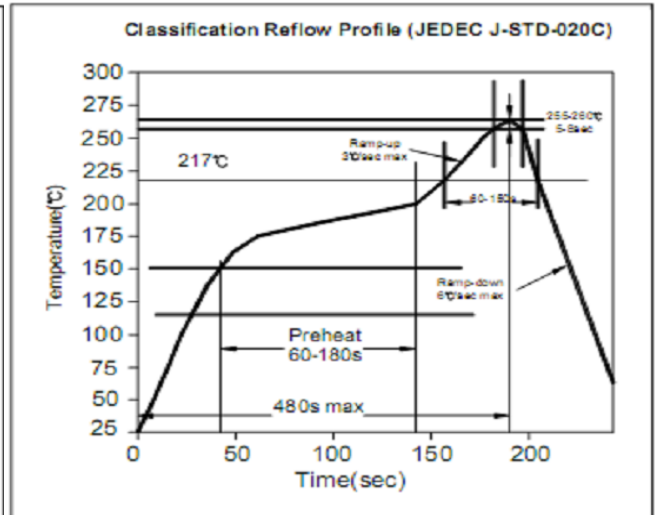

DRW:	Lexua	CHKD	Wilson	MATL:	ChuChu	DATE	03.02.2025
APPD:	Jimmy			FINISH	Josy	Sheet	2 from 2

Copyright by S.Tiede