

# EDCON-COMPONENTS

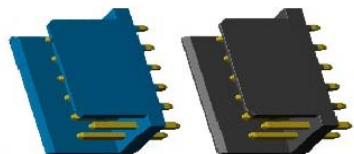

## Technical Description

Insulator: PBT, glass reinforced rated UL94V-0  
 Contact Material: Brass  
 Current Rating: 2A  
 Contact Resistance: 30mΩ max.  
 Insulation Resistance: 3000MΩ min.  
 Dielectric Withstandng Voltage: 500VAC for 1 Minute  
 Operating Temperature: -40°C to + 105°C

## Drawing

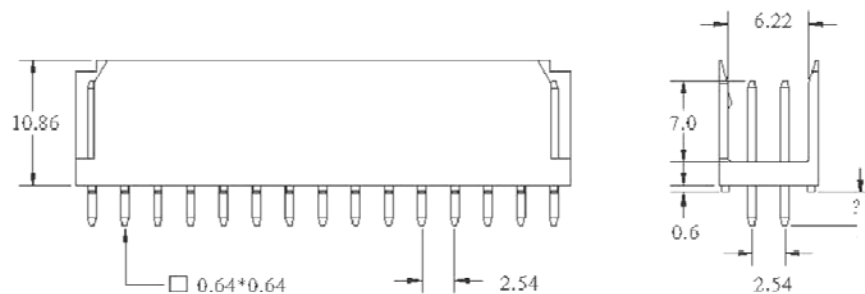
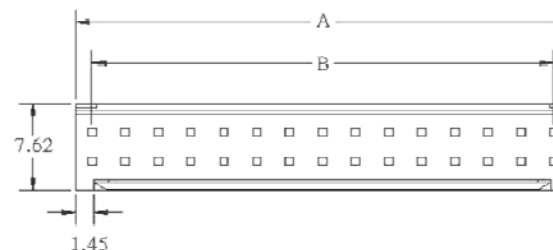

PCB Layout

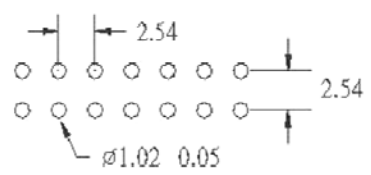

## Specifications

No. of Pos.	A (mm)	B (mm)	No. of Pos.	A (mm)	B (mm)
4	5,08	2,43	40	50,80	48,26
6	7,62	5,08			
8	10,16	7,62			
10	12,70	10,16			
12	15,24	12,70			
14	17,78	15,24			
16	20,32	17,78			
18	22,80	20,32			
20	25,40	22,80			
22	27,94	25,40			
24	30,48	27,94			
26	33,02	30,48			
28	35,56	33,02			
30	38,10	35,56			
32	40,64	38,10			
34	43,18	40,64			
36	45,72	43,18			
38	48,26	45,72			

## Two Wall Pin Header Dual Straight Pin

Part No.: **T68N049**  
 Customer:

DRW:	Jason	CHKD	Wilson	MATL:	Wilson	TOLERANCE	Mason	DATE	18.10.2017
APPD:	Schumi			FINISH	Jamy		Sheet No.		1 from 3

# EDCON-COMPONENTS

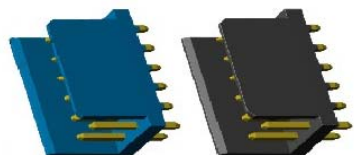

## Ordering Informations

Serie	No. Of Position	Contact Plating	Color of Body	ROHS	Packing					
-------	-----------------	-----------------	---------------	------	---------	--	--	--	--	--

<b>T68N049</b>	<b>04</b>	<b>GF</b>	<b>BK</b>	<b>R</b>	<b>BU</b>					
----------------	-----------	-----------	-----------	----------	-----------	--	--	--	--	--

<b>04=</b> 4Pos.	<b>GF=</b> Gold Flash	<b>BK=</b> Black	<b>R=</b> ROHS Conform	<b>BU=</b> Bulk-Ware
	<b>TN=</b> tinned	<b>BL=</b> Blue		
		<b>RD=</b> Red		
		<b>YE=</b> Yellow		

<b>Two Wall Pin Header Dual Straight Pin</b>	
Part No.:	<b>T68N049</b>
Customer:	

DRW:	Jason	CHKD	Wilson	MATL:	Wilson	TOLERANCE	Mason	DATE	18.10.2017
APPD:	Schumi			FINISH	Jamy			Sheet No.	2 from 3

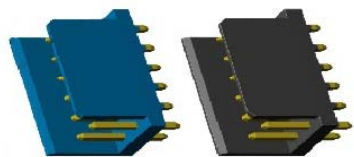

Soldering Profile Curve

Classification Reflow Profile (JEDEC J-STD-020C)

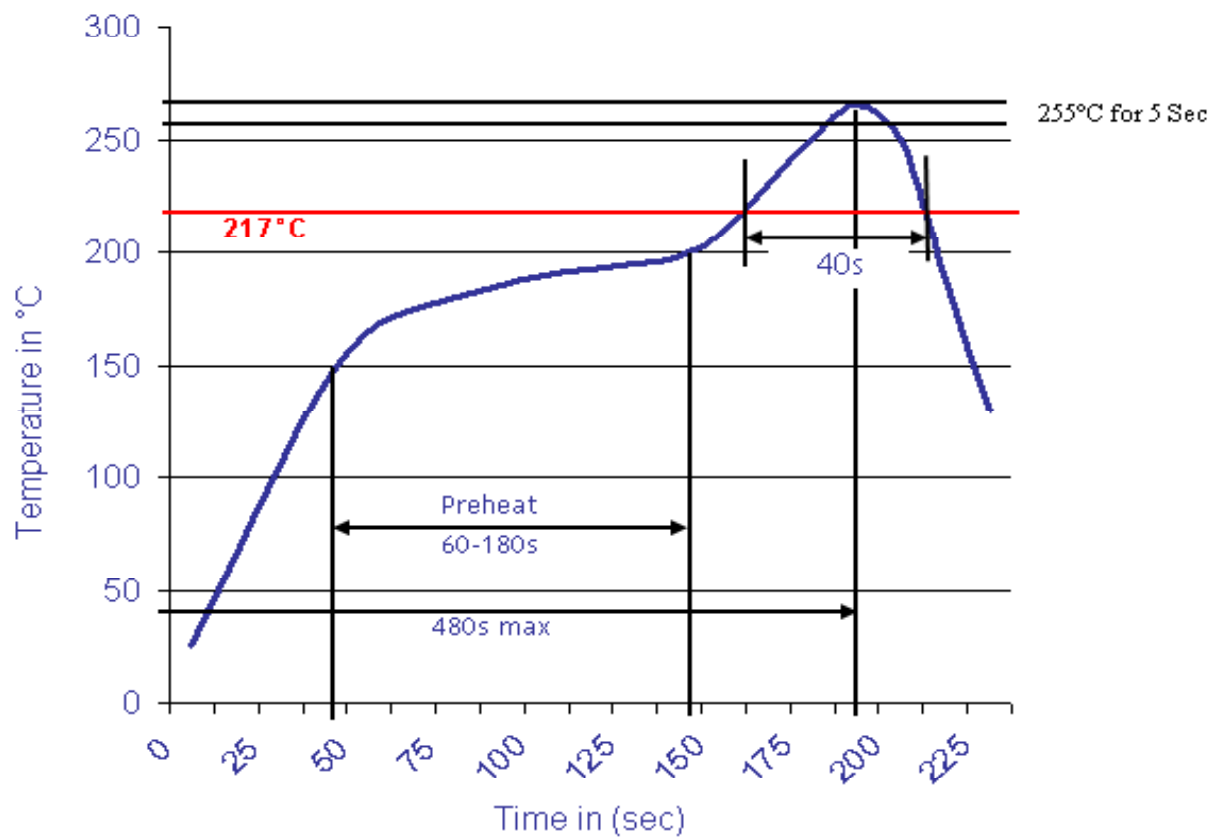

**Two Wall Pin Header Dual  
Straight Pin**

Part No.: **T68N049**

Customer:

DRW:	Jason	CHKD	Wilson	MATL:	Wilson	TOLERANCE	Mason	DATE	18.10.2017
APPD:	Schumi			FINISH	Jamy		Sheet No.	3 from 3	