

# EDCON-COMPONENTS



## Specifications

Current Rating:	1,5A
Insulation Resistance:	500M Ohm min.
Contact Resistance:	20milli Ohm max.
Dielectric Voltage:	1000V AC for one minute
Operating Temperature:	. -40°C ~ to +105°C
Insulator Material:	PBT+30% G.F.(UL94V-0)
Contact Pin:	Brass
Contact Plating:	Gold or Sn over Ni.

## Drawing

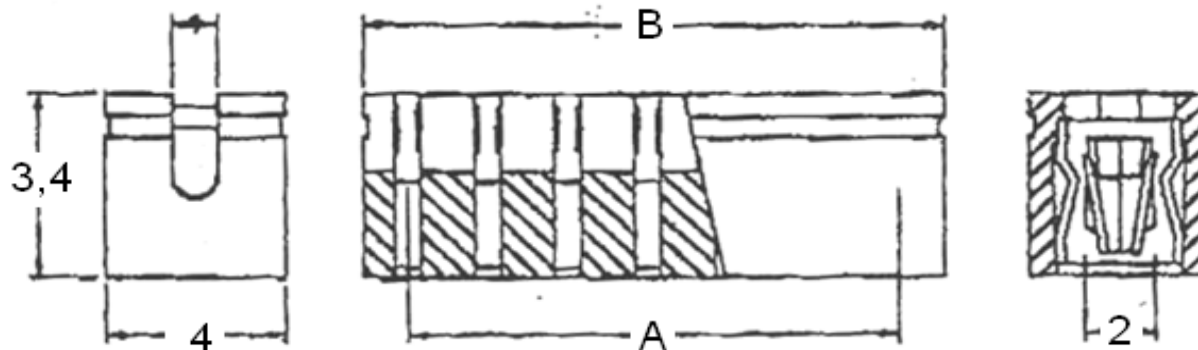

No. of. Pos.	Dim (A) (mm)	Dim (B) (mm)
2	2	4
3	4	6
4	6	8
5	8	10
6	10	12
7	12	14
8	14	16
9	16	18
10	18	20

**Jumper Pitch 2,00mm P**  
**Height 3,4mm**

Part No.: **T37B006**

DRW:	Jason	CHKD	Wilson	MATL:	Wilson	TOLERANCE	Mason	DATE	10.04.2009
APPD:	Schumi			FINISH	Jamy		Sheet No.	1 from 4	Customer:

[www.edcon-components.com](http://www.edcon-components.com)

email: [info@edcon-components.com](mailto:info@edcon-components.com)

# EDCON-COMPONENTS



## Ordering Informations

Serie	No. of Pos.	Contact Plating	Material	Color of Body	ROHS	Packing				
<b>T37B006</b>	<b>02</b>	<b>G0</b>	<b>PB</b>	<b>BK</b>	<b>R</b>	<b>BU</b>				

02 ~ 10

<b>G0</b> = Gold Flash	<b>PB</b> = PBT +30% GF	<b>BK</b> = Black	<b>N</b> =NO ROHS conform	<b>BU</b> = Bulk Ware
<b>T0</b> = Tin plated			<b>R</b> =ROHS conform	
<b>GA</b> = 3µ Gold Plating				
<b>GB</b> = 5µ Gold Plating				
<b>GC</b> = 10µ Gold Plating				
<b>GD</b> = 30µ Gold Plating				
<b>S0</b> = Selectiv Plating Gold Flash / Tin				
<b>SD</b> = Selectiv Tin/ 5µGold				
<b>SD</b> = Selectiv Tin/ 10µ Gold Flash				
<b>SD</b> = Selectiv Tin/ 20µ Gold	<b>SD</b> = Selectiv Tin/ 30µ Gold			

**Jumper Pitch 2,00mm P**  
**Height 3,4mm**

Part No.: **T37B006**

DRW:	Jason	CHKD	Wilson	MATL:	Wilson	TOLERANCE	Mason	DATE	10.04.2009
APPD:	Schumi			FINISH	Jamy		Sheet No.		3 from 4

Customer: