

EDCON-COMPONENTS

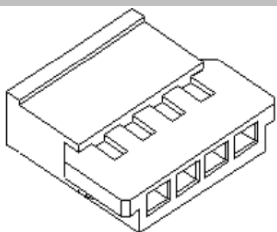

Specifications

Voltage Rating:	200 V AC/DC
Current Rating:	2A AC/DC
Operating Temperature:	-25°C to +85°C
Contact Resistance:	10 mΩ
Withstanding Voltage:	800 V AC/Minute
Insulation Resistance:	1000MΩ min.
Material Housing:	PBTP
Color:	Natural / (White)

Drawing (dimensions all into mm)

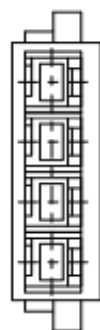
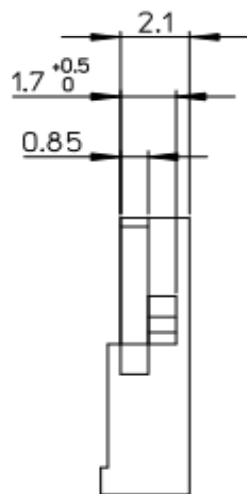
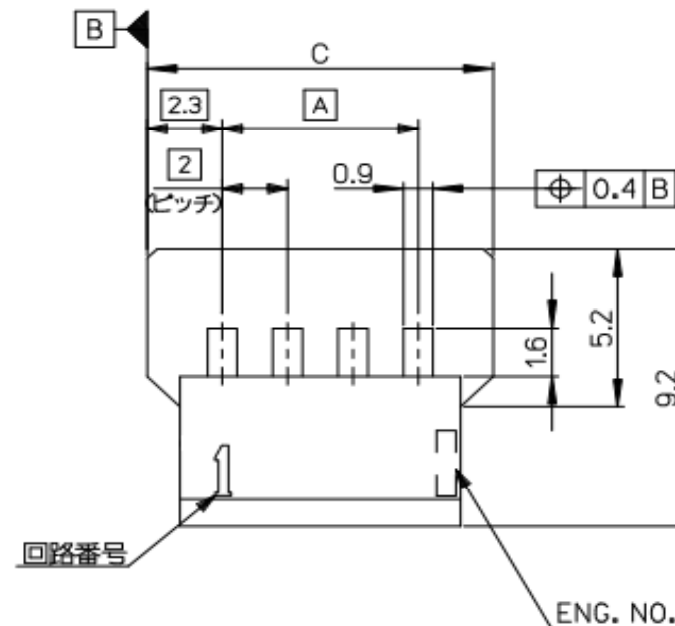
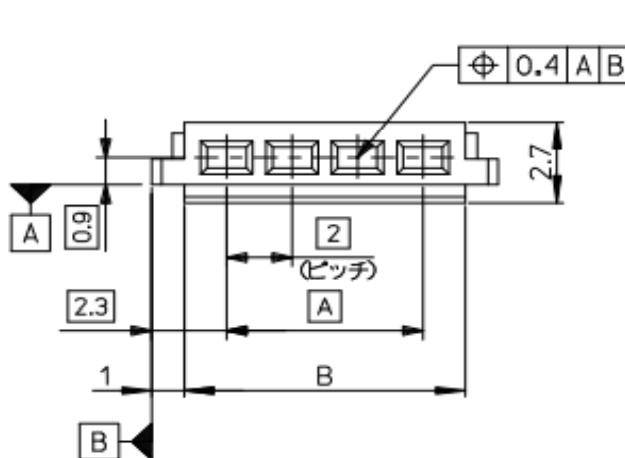

No. P	A	B	C
2	2	4,6	6,6
3	4	6,6	8,6
4	6	8,6	10,6
5	8	10,6	12,6

Housing Serie T68Txxxx Pitch 2,00mm	
Part No.:	T68T313 -
Customer:	

DRW:	Jason	CHKD	Wilson	MATL:	Wilson	TOLERANCE	Mason	DATE	24.07.2021
APPD:	Schumi			FINISH	Jamy		Sheet No.	1 from 2	

EDCON-COMPONENTS

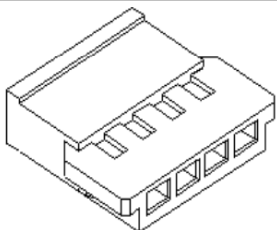

Ordering Informations

Serie	Number of Pos.	Color of Body	ROHS	Packing						
-------	----------------	---------------	------	---------	--	--	--	--	--	--

T68T313 -	02	WH	R	BU						
------------------	-----------	-----------	----------	-----------	--	--	--	--	--	--

xx = Pos.	WH= White	R= ROHS Conform	BU= Bulk Packing						
	BK= Black	N= NON ROHS Conform							
	RD= Red								

Housing Serie T68Txxxx Pitch 2,00mm

Part No.: **T68T313 -**

DRW:	Jason	CHKD	Wilson	MATL:	Wilson	TOLERANCE	Mason	DATE	24.07.2021
APPD:	Schumi			FINISH	Jamy		Sheet No.		2 from 2

Customer: