

EC7921 SERIES

7.92~5.00mm pitch wire to board connector

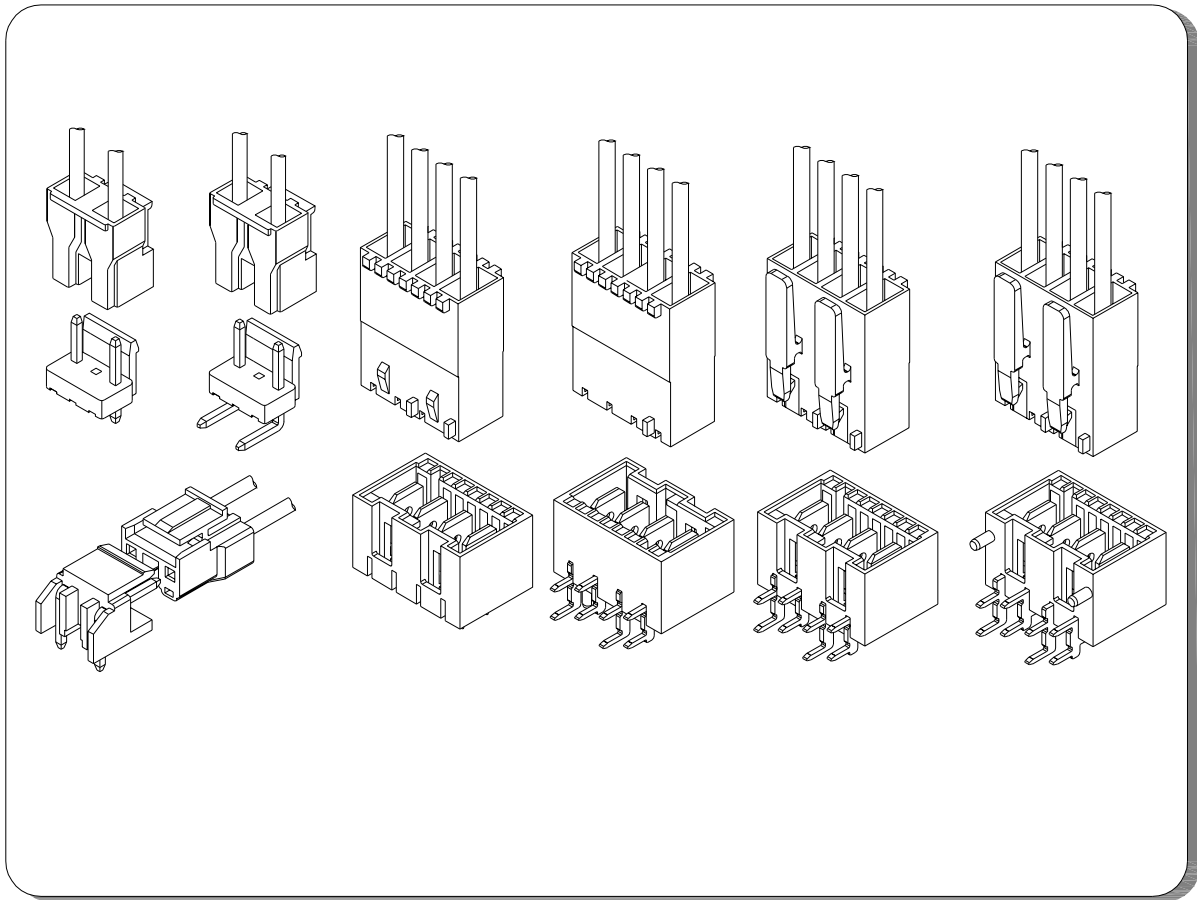

Specifications(Ordinary)

Current rating:10A AC,DC
Voltage rating:250V AC,DC
Temperature range:-40°C~+105°C
Contact resistance:10mΩMax.
Insulation resistance:1000MΩMin.
Withstanding voltage:1500V AC/minute
Meet the HF/Halogen Free,GWT/Glow wire Test (IEC60335-1) request,need to customize
Contact EC for details

Specifications(Special)

Current rating:16A AC,DC
Voltage rating:380V AC,DC
Temperature range:-40°C~+105°C
Contact resistance:20mΩMax.
Insulation resistance:1000MΩMin.
Withstanding voltage:1800V AC/minute
Meet the HF/Halogen Free,GWT/Glow wire Test (IEC60335-1) request,need to customize
Contact EC for details

Standards



Assembly layout

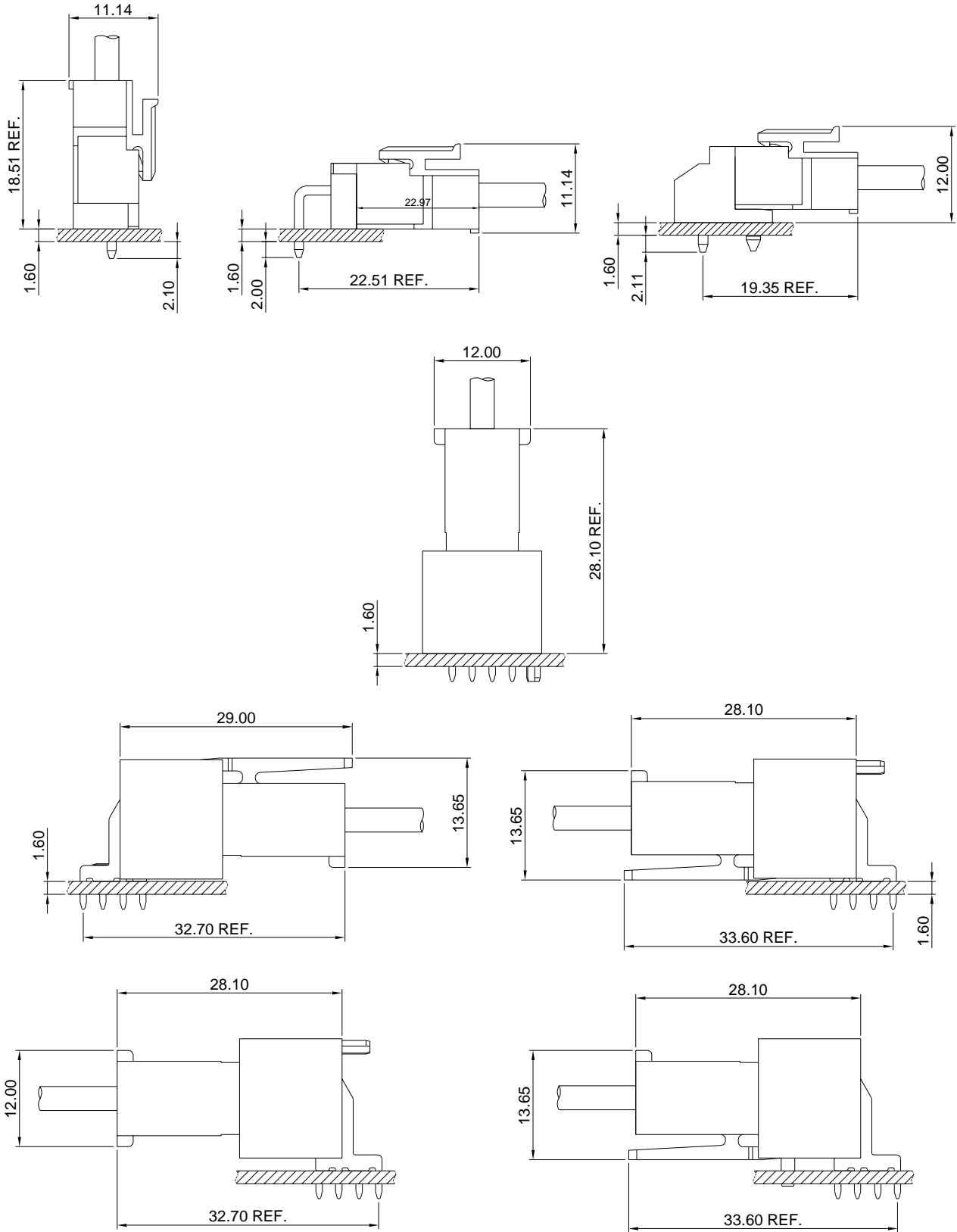

EC7921 SERIES

7.92mm pitch wire to board connector

EC7921-T

7.92mm pitch Crimp Terminal

Reference Informations:

*Used in-EDCON - EC7921 series Housing

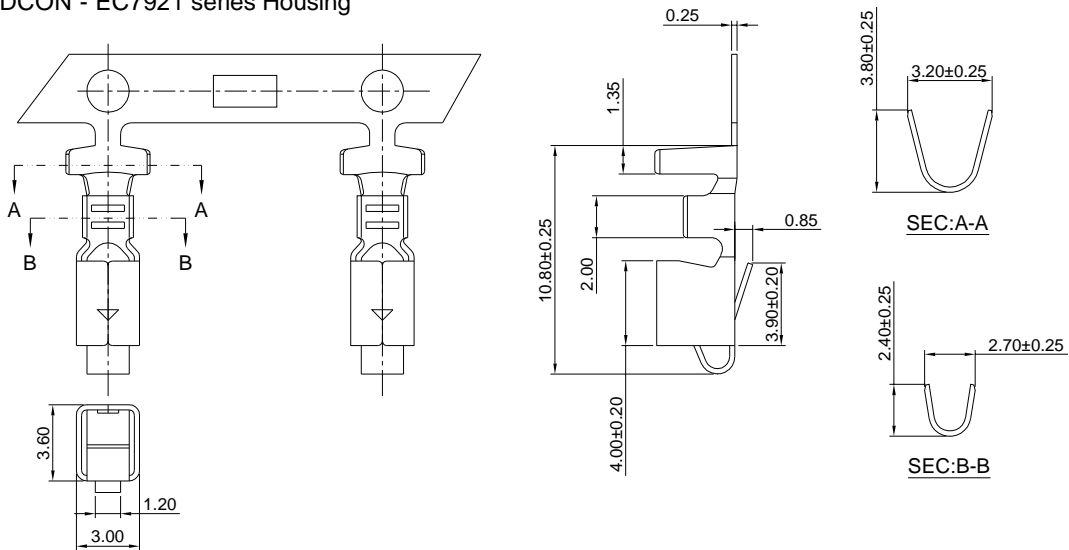

Ordering information & Specifications:

Unit:mm

Part NO.	Wire Range	Insulation O.D.	Material	Finish	Qty/reel
EC7921-TB	AWG#18-#22	3.00mm(max)	Brass	Tin over Nickel	4,000 PCS
EC7921-TP	AWG#18-#22	3.00mm(max)	Phosphor Bronze	Tin over Nickel	4,000 PCS
EC7921-GB	AWG#18-#22	3.00mm(max)	Brass	Gold over Nickel	4,000 PCS
EC7921-GP	AWG#18-#22	3.00mm(max)	Phosphor Bronze	Gold over Nickel	4,000 PCS

Optional Gold plating available but MOQ requested

EC7921-T-H

7.92mm pitch Crimp Terminal

Reference Informations:

*Used in EDCON - EC7921 series Housing

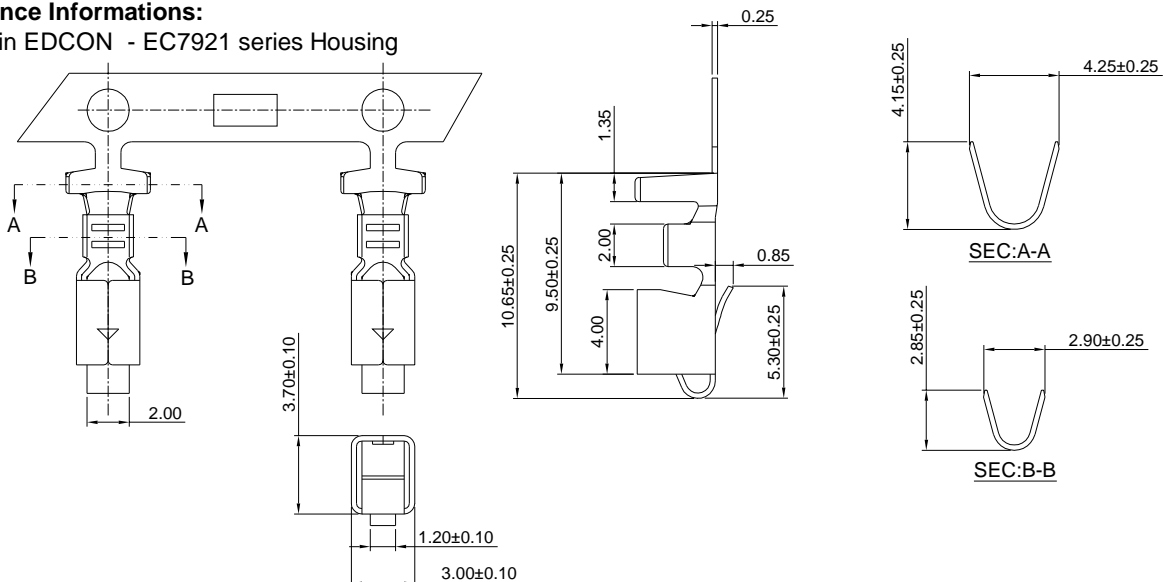

Ordering information & Specifications:

Part NO.	Wire Range	Insulation O.D.	Material	Finish	Qty/reel
EC7921-TB-H	AWG#16-#20	3.40mm(max)	Brass	Tin over Nickel	4,000 PCS
EC7921-TP-H	AWG#16-#20	3.40mm(max)	Phosphor Bronze	Tin over Nickel	4,000 PCS
EC7921-GB-H	AWG#16-#20	3.40mm(max)	Brass	Gold over Nickel	4,000 PCS
EC7921-GP-H	AWG#16-#20	3.40mm(max)	Phosphor Bronze	Gold over Nickel	4,000 PCS

Optional Gold plating available but MOQ requested

EC7921 SERIES

7.92mm pitch wire to board connector

EC7921H-2P

7.92mm pitch Housing

Reference Informations:

*Material:Nylon 66,UL94V-0

*Suitable EDCON - EC7921 series

Terminal / EC7921

*Mates with
EC series

Wafer

*Color:White

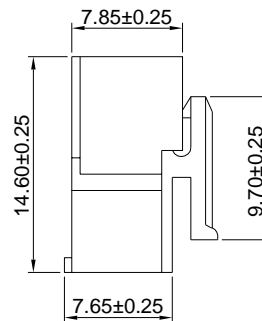
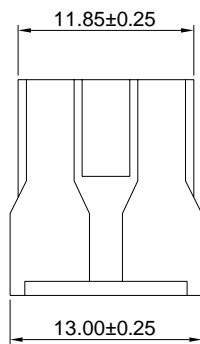
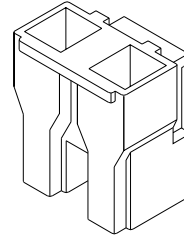
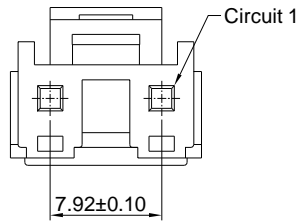

Unit: mm

EC7921WV-2P

7.92mm pitch 180° Wafer

Reference Informations:

*Material:Pin:Brass/Tin over Nickel

Insulator:Nylon 66,UL94V-0

*Mates with EDCON - EC7921 series Housing or EC3963 series

Housing *Color:White

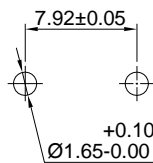
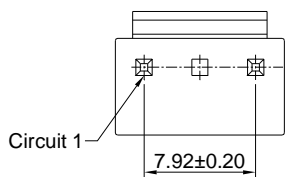

P.C.B LAYOUT

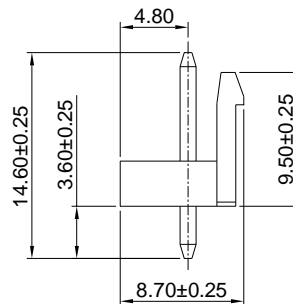
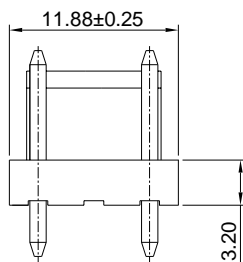
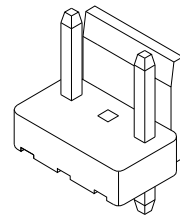

Unit: mm

EC7921 SERIES

7.92mm pitch wire to board connector

EC7921WR-2P

7.92mm pitch 90° Wafer

Reference Informations:

*Material:Pin:Brass/Tin over Nickel

Insulator:Nylon 66,UL94V-0

*Mates with EDCON - EC7921 series Housing or EC3963 series

Housing *Color:White

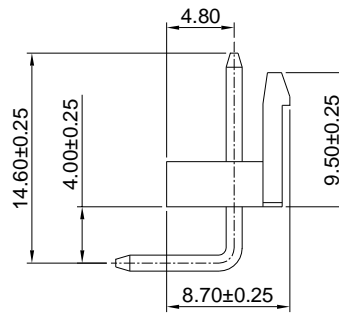
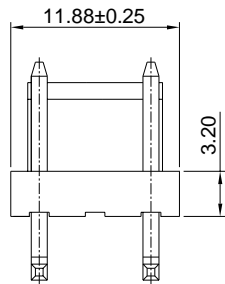
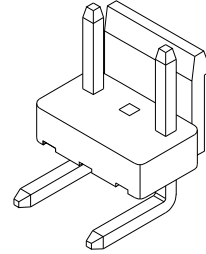
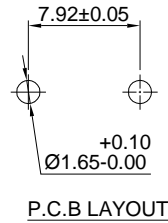
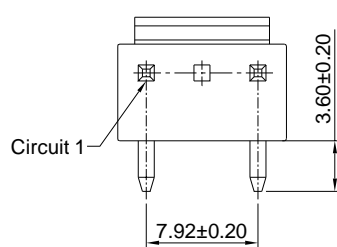

Unit: mm

EC7921WR-F-2P

7.92mm pitch 90° Wafer

Reference Informations:

*Material:Pin:Brass/Tin over Nickel

Insulator:PBT,UL94V-0

*Mates with EDCON - EC7921 series Housing or EC3963 series

Housing *Color:White

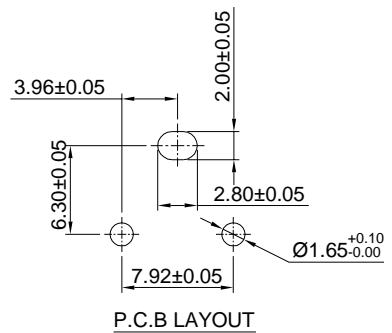
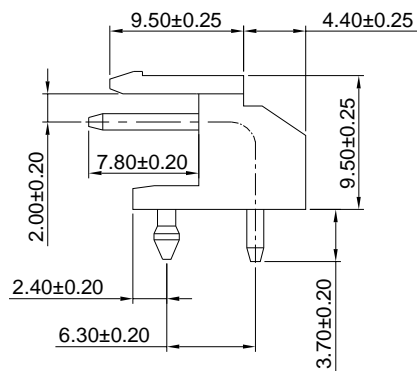
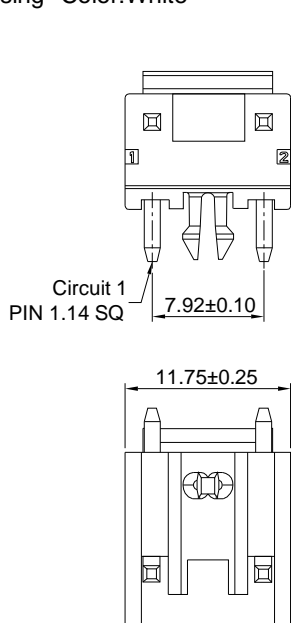

Unit: mm

EC921 SERIES

5.00mm pitch wire to board connector

EC7921-T-A

5.00mm pitch Crimp Terminal

Reference Informations:

*Used in EDCON - EC7921HC / EC7921HD series Housing

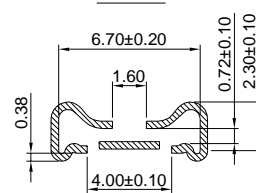
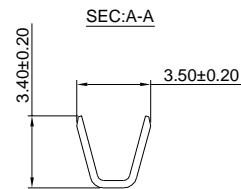
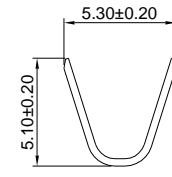
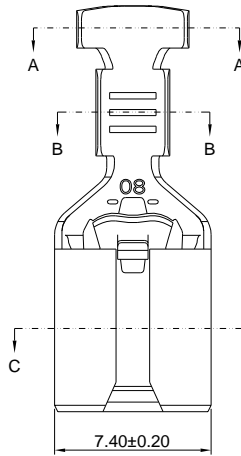
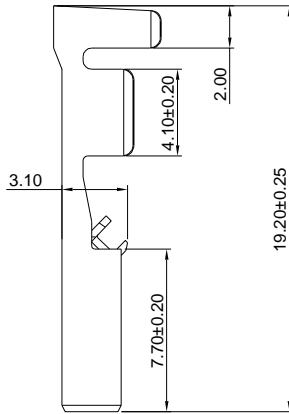

Ordering information & Specifications:

Unit:mm

Part NO.	Wire Range	Insulation O.D.	Material	Finish	Qty/reel
EC7921-TB-A	AWG#14-#18	3.30mm(max)	Brass	Tin over Nickel	5,000 PCS
EC7921-TP-A	AWG#14-#18	3.30mm(max)	Phosphor Bronze	Tin over Nickel	5,000 PCS
EC921-SUS-A	AWG#14-#18	3.30mm(max)	SUS 304	-----	5,000 PCS

Optional Gold plating available but MOQ requested

EC7921-T-A-L

5.00mm pitch Crimp Terminal

Reference Informations:

*Used in EDCON - EC7921HC / EC7921HD series Housing

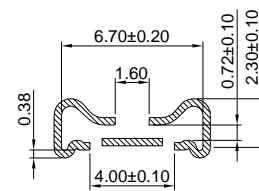
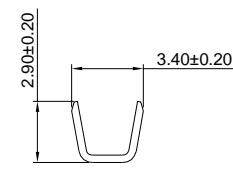
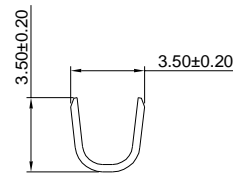
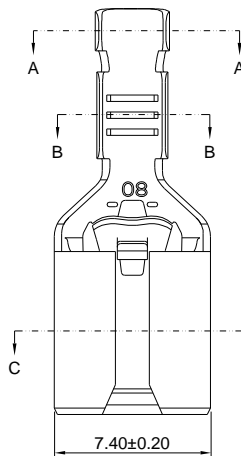
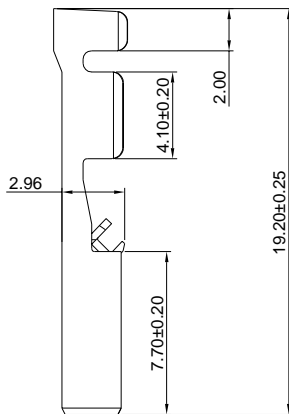

Ordering information & Specifications:

Unit:mm

Part NO.	Wire Range	Insulation O.D.	Material	Finish	Qty/reel
EC7921-TB-A-L	AWG#20-#22	1.80mm(max)	Brass	Tin over Nickel	5,000 PCS
EC7921-TP-A-L	AWG#20-#22	1.80mm(max)	Phosphor Bronze	Tin over Nickel	5,000 PCS
EC7921-SUS-A-L	AWG#20-#22	1.80mm(max)	SUS 304	-----	5,000 PCS

Optional Gold plating available but MOQ requested

EC7921 SERIES

5.00mm pitch wire to board connector

EC7921-T-B

5.00mm pitch Crimp Terminal

Reference Informations:

*Used in EDCON - EC7921HC / EC7921HD series Housing

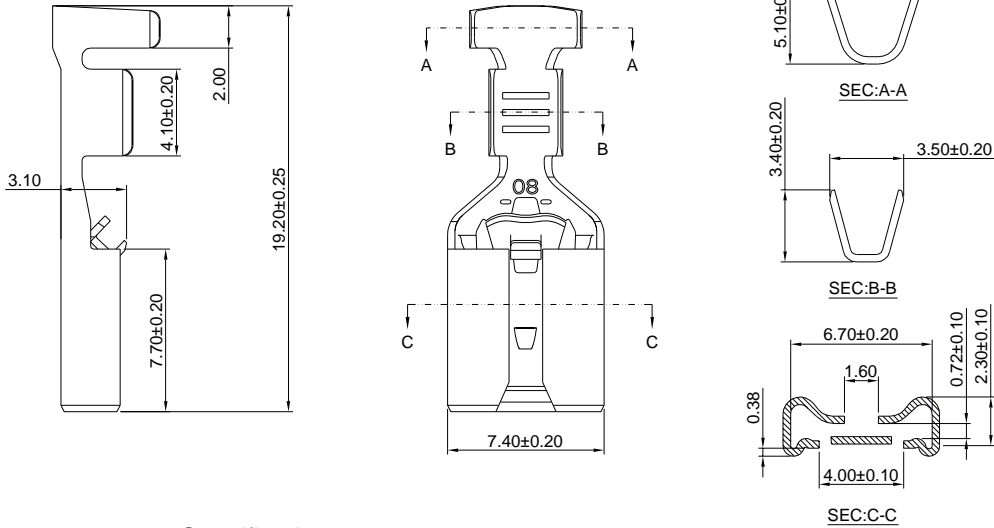

Ordering information & Specifications:

Unit:mm

Part NO.	Wire Range	Insulation O.D.	Material	Finish	Qty/reel
EC7921-TB-B	AWG#14-#18	3.30mm(max)	Brass	Tin over Nickel	5,000 PCS
EC7921-TP-B	AWG#14-#18	3.30mm(max)	Phosphor Bronze	Tin over Nickel	5,000 PCS
EC7921-SUS-B	AWG#14-#18	3.30mm(max)	SUS 304	-----	5,000 PCS

Optional Gold plating available but MOQ requested

EC7921-T-B-L

5.00mm pitch Crimp Terminal

Reference Informations:

*Used in EDCON - EC7921HC / EC7921HD series Housing

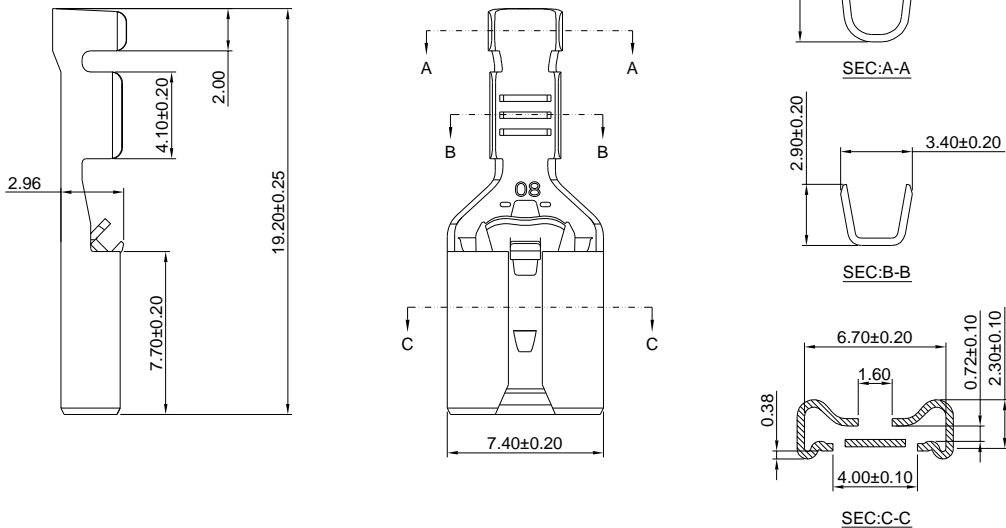

Ordering information & Specifications:

Unit:mm

Part NO.	Wire Range	Insulation O.D.	Material	Finish	Qty/reel
EC7921-TB-B-L	AWG#20-#22	1.80mm(max)	Brass	Tin over Nickel	5,000 PCS
EC7921-TP-B-L	AWG#20-#22	1.80mm(max)	Phosphor Bronze	Tin over Nickel	5,000 PCS
EC7921-SUS-B-L	AWG#20-#22	1.80mm(max)	SUS 304	-----	5,000 PCS

Optional Gold plating available but MOQ requested

EC7921 SERIES

5.00mm pitch wire to board connector

EC7921HC

5.00mm pitch Housing

Reference Informations:

*Material:Nylon 66,UL94V-0

*Suitable EDCON - EC7921-T-A/-L ,
EC7921-T-B/-L series Terminal

*Mates with EDCON - EC7921WVA , EC7921WRA series
Wafer *Color:Ivory

Ordering Information:

EC7921HC-XP - **
1 2

1.Part No.

2.Pleas find page 413~415 for details.

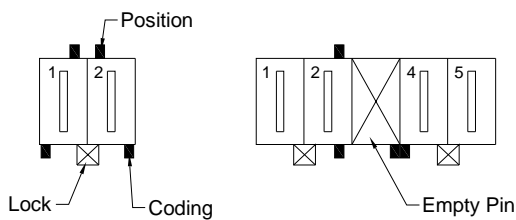
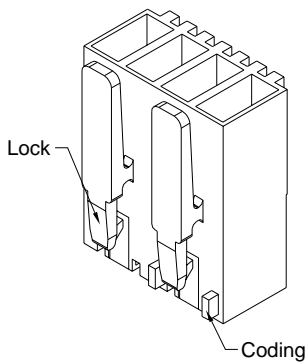
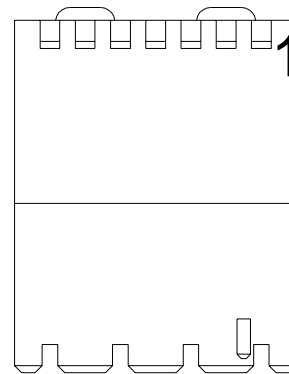
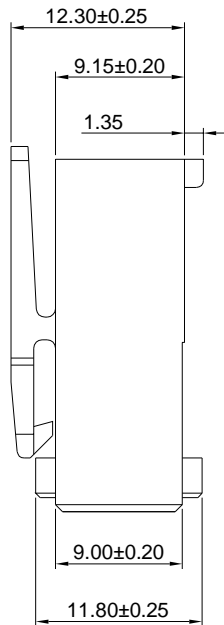
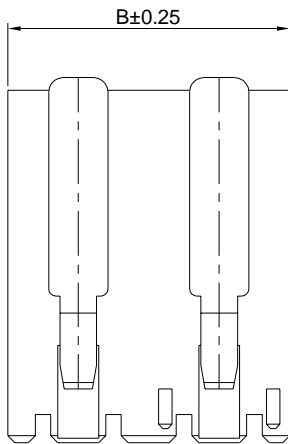
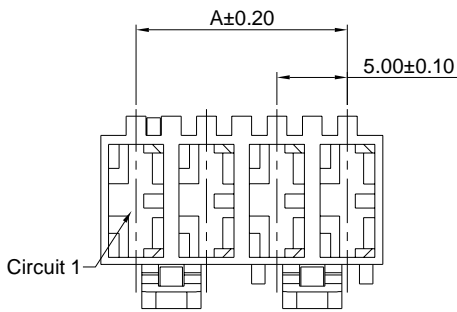
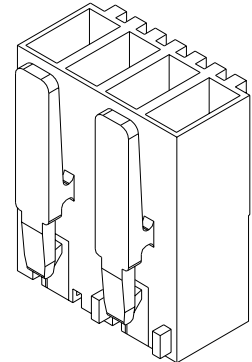

Ordering Information & Dimensions:

PART NO.	Dimensions	
	A	B
EC7921HC-2P	5.00	10.00
EC7921HC-3P	10.00	15.00
EC7921HC-4P	15.00	20.00
EC7921HC-5P	20.00	25.00
EC7921HC-6P	25.00	30.00
EC7921HC-7P	30.00	35.00
EC7921HC-8P	35.00	40.00
EC7921HC-9P	40.00	45.00
EC7921HC-10P	45.00	50.00
EC7921HC-11P	50.00	55.00
EC7921HC-12P	55.00	60.00

Unit: mm

EC7921 SERIES

5.00mm pitch wire to board connector

EC7921HD

5.00mm pitch Housing

Reference Informations:

*Material:Nylon 66,UL94V-0

*Suitable EDCON - EC7921-T-A/-L ,
EC7921-T-B/-L series Terminal

*Mates with EDCON - EC7921WVA , EC7921WRA
series Wafer *Color:Ivory

Ordering Information:

EC7921HD-XP - **
1 2

1.Part No.

2.Please find page for details.

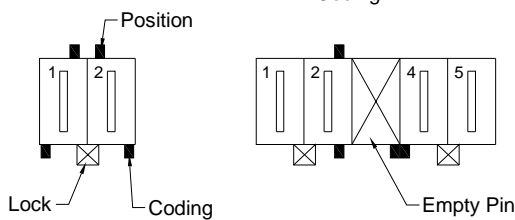
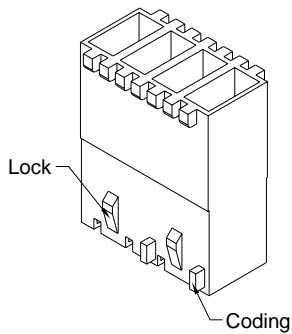
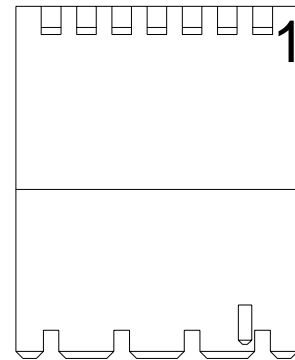
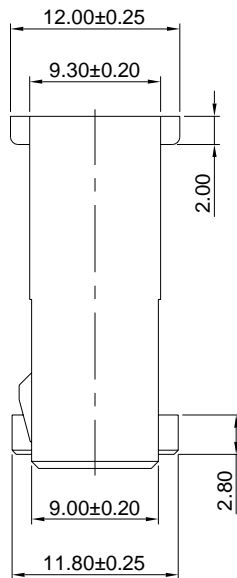
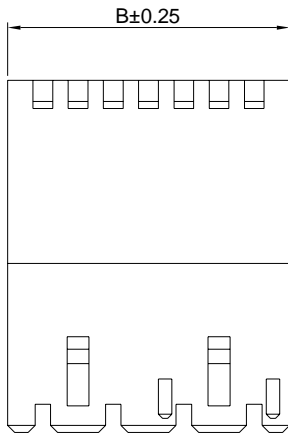
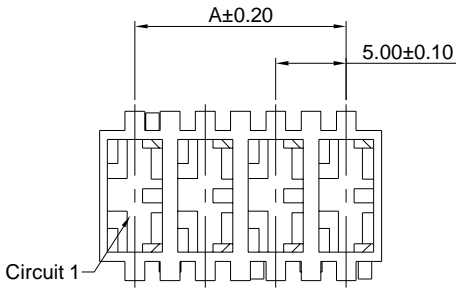
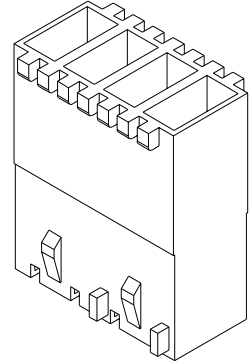

Ordering Information & Dimensions:

PART NO.	Dimensions	
	A	B
EC7921HD-2P	5.00	10.00
EC7921HD-3P	10.00	15.00
EC7921HD-4P	15.00	20.00
EC7921HD-5P	20.00	25.00
EC7921HD-6P	25.00	30.00
EC7921HD-7P	30.00	35.00
EC7921HD-8P	35.00	40.00
EC7921HD-9P	40.00	45.00
EC7921HD-10P	45.00	50.00
EC7921HD-11P	50.00	55.00
EC7921HD-12P	55.00	60.00

Unit: mm

EC7921 SERIES

5.00mm pitch wire to board connector

EC7921WVA

5.00mm pitch 180° Wafer

Reference Informations:

*Material:Insulator:Nylon 66+30%GF,UL94V-0

Terminal:Copper alloy

*Suitable EDCON -EC7921HC , EC7921HD series

Housing *Contact: Tin Plated 120u" over Ni 30u"min

Silver Plated 80~120u" over Ni 30u" min

*Compliant IEC 60695-2-11 and IEC 60335-1(750°C,Flamme<2S)

*Color:Ivory

Ordering Information:

EC7921WVA - $\frac{XP}{1}$ - $\frac{*}{2}$ - $\frac{**}{3}$ - $\frac{**}{4}$

1.Part No.

2.Circuit number.

3.Terminal Finish:

(blank):Tin over Nickel

S:Silver over Nickel

4.Pleas find page xxx~xxx for details.

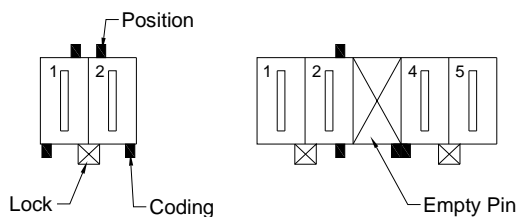
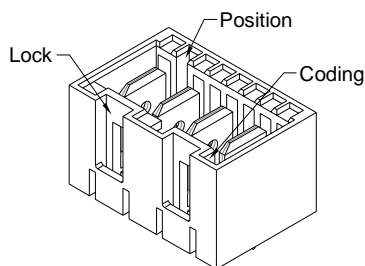
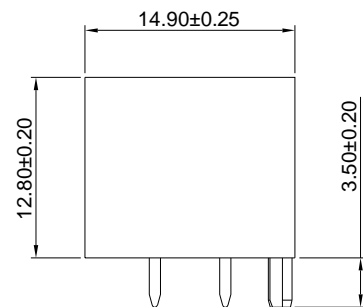
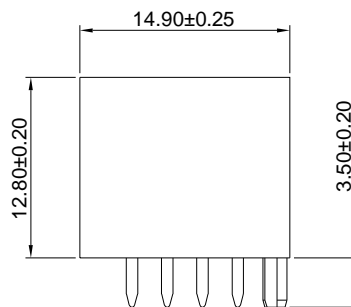
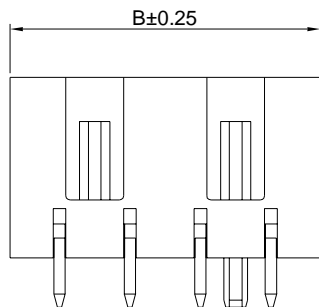
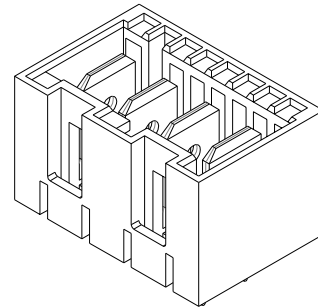
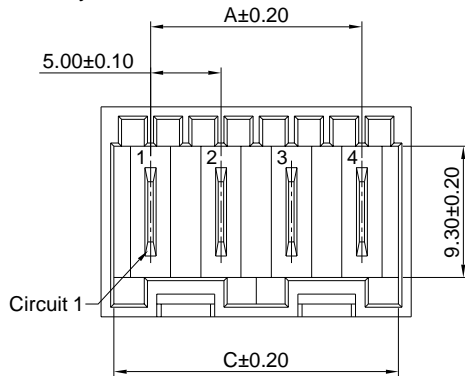

Ordering Information & Dimensions:

PART NO.	Dimensions		
	A	B	C
EC7921WVA-2P	5.00	10.00	10.20
EC7921WVA-3P	10.00	15.00	15.20
EC7921WVA-4P	15.00	20.00	20.20
EC7921WVA-5P	20.00	25.00	25.20
EC7921WVA-6P	25.00	30.00	30.20
EC7921WVA-7P	30.00	35.00	35.20
EC7921WVA-8P	35.00	40.00	40.20
EC7921WVA-9P	40.00	45.00	45.20
EC7921WVA-10P	45.00	50.00	50.20
EC7921WVA-11P	50.00	55.00	55.20
EC7921WVA-12P	55.00	60.00	60.20

Unit: mm

EC7921 SERIES

5.00mm pitch wire to board connector

EC7921WVA

5.00mm pitch 180° Wafer

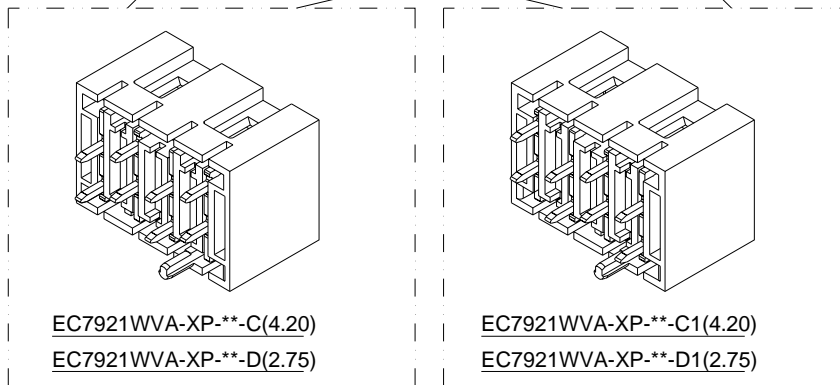
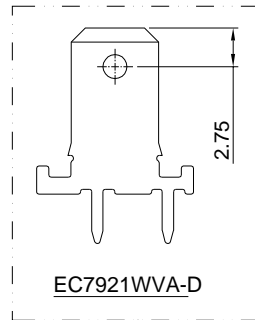
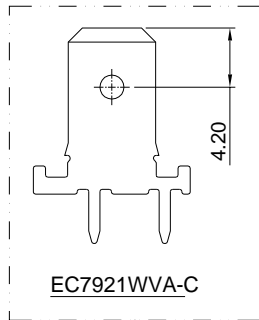
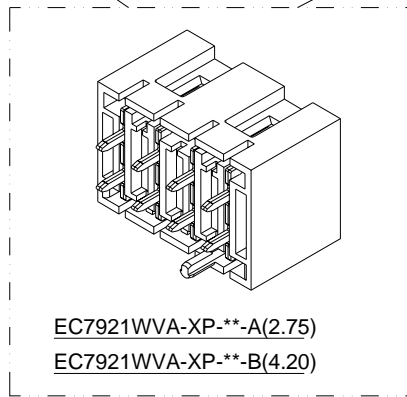
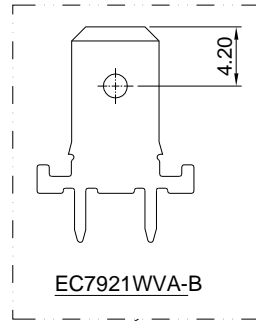
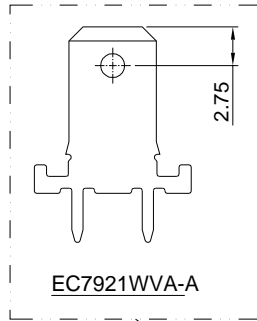

EC7921 SERIES

5.00mm pitch wire to board connector

EC7921WVA

5.00mm pitch 180° Wafer

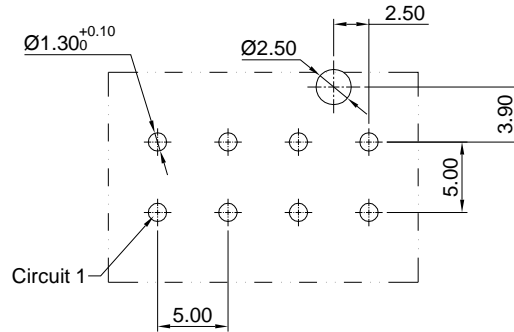

P.C.B LAYOUT
[EC7921WVA-XP-**-A(2.75)]
[EC7921WVA-XP-**-B(4.20)]

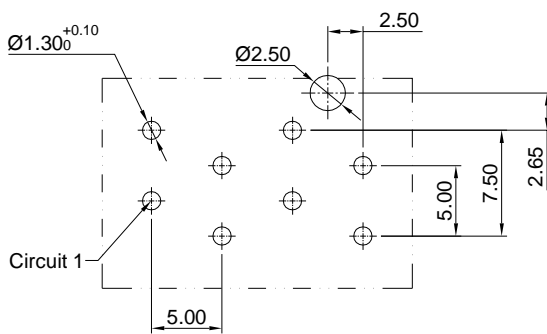

P.C.B LAYOUT
[EC7921WVA-XP-**-C(4.20)]
[EC7921WVA-XP-**-D(2.75)]

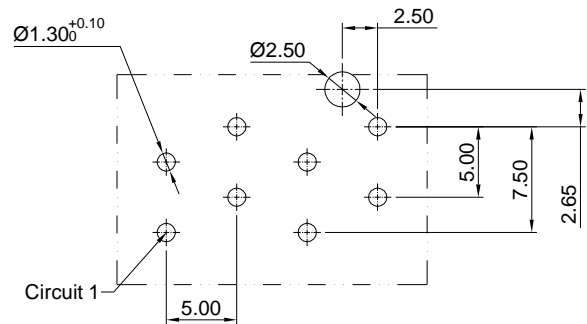

P.C.B LAYOUT
[EC7921WVA-XP-**-C1(4.20)]
[EC7921WVA-XP-**-D1(2.75)]

EC7921 SERIES

5.00mm pitch wire to board connector

EC7921WRA

5.00mm pitch 90° Wafer

Reference Informations:

*Material:Insulator:Nylon 66+30%GF,UL94V-0

Terminal:Copper alloy

*Suitable EDCON- EC7921HC , EC7921HD series

Housing *Contact: Tin Plated 120u" over Ni 30u"min

Silver Plated 80~120u" over Ni 30u" min

*Compliant IEC 60695-2-11 and IEC 60335-1(750°C,Flamme<2S)

*Color:Ivory

Ordering Information:

EC7921WRA - XP - * - **
 1 2 3 4 1.Part

No.

2.Circuit number.

3.Terminal Finish:

(blank):Tin over Nickel

S:Silver over Nickel

4.Pleas find page 413~415 for details.

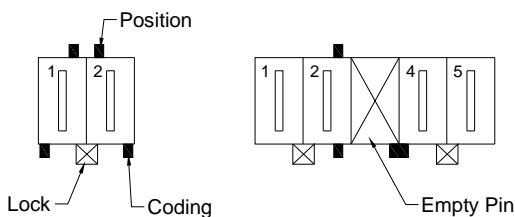
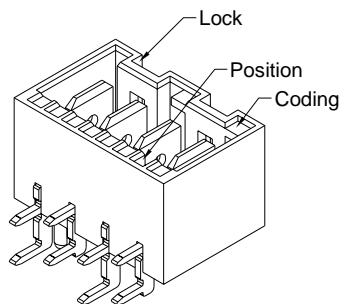
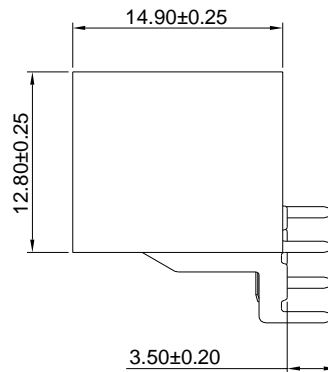
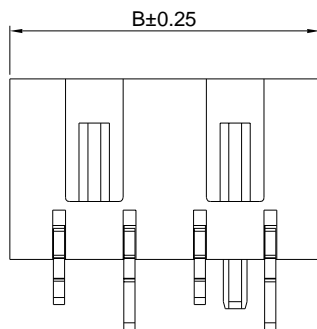
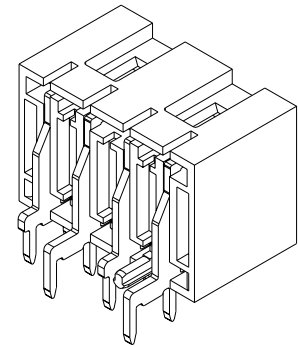
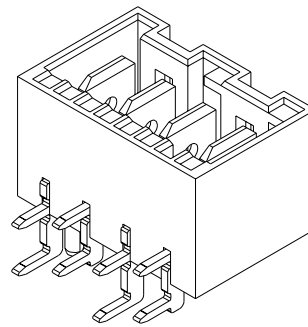
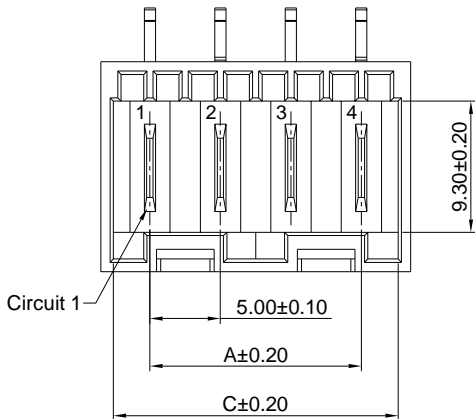

Ordering Information & Dimensions:

PART NO.	Dimensions		
	A	B	C
EC7921WRA-2P	5.00	10.00	10.20
EC7921WRA-3P	10.00	15.00	15.20
EC7921WRA-4P	15.00	20.00	20.20
EC7921WRA-5P	20.00	25.00	25.20
EC7921WRA-6P	25.00	30.00	30.20
EC7921WRA-7P	30.00	35.00	35.20
EC7921WRA-8P	35.00	40.00	40.20
EC7921WRA-9P	40.00	45.00	45.20
EC7921WRA-10P	45.00	50.00	50.20
EC7921WRA-11P	50.00	55.00	55.20
EC7921WRA-12P	55.00	60.00	60.20

Unit: mm

EC7921 SERIES

5.00mm pitch wire to board connector

EC7921WRA-R

5.00mm pitch 90° Wafer

Reference Informations:

*Material:Insulator:Nylon 66+30%GF,UL94V-0

Terminal:Copper alloy

*Suitable EDCON- EC7921HC , EC7921HD series

Housing *Contact: Tin Plated 120u" over Ni 30u"min

Silver Plated 80~120u" over Ni 30u" min

*Compliant IEC 60695-2-11 and IEC 60335-1(750°C,Flamme<2S)

*Color:Ivory

Ordering Information:

EC7921WRA - R - XP - * - **
 1 2 3 4 5

- 1.Part No.
- 2.Reverse Type
- 3.Circuit number.
- 4.Terminal Finish: (blank):Tin over Nickel S:Silver over Nickel
- 5.Pleas find page xxx~xxx for details.

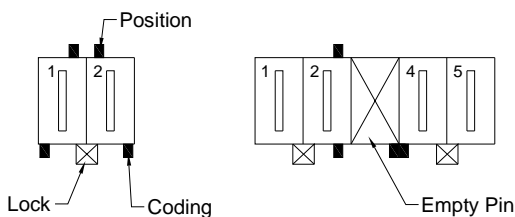
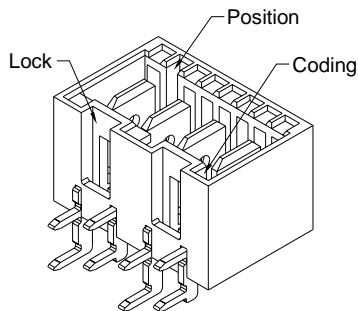
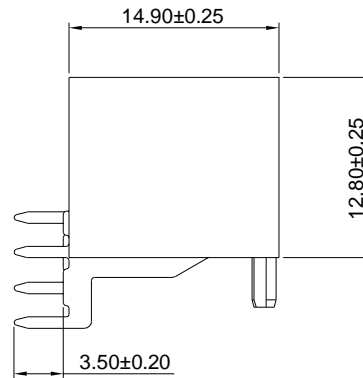
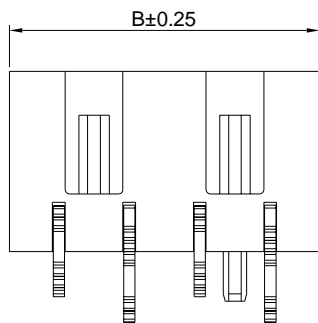
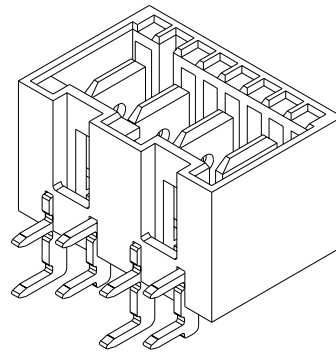
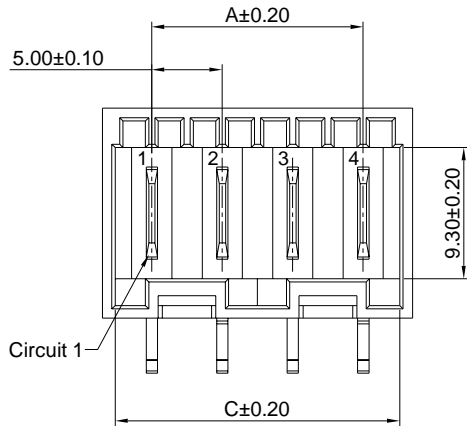

Ordering Information & Dimensions:

PART NO.	Dimensions		
	A	B	C
EC7921WRA-R-2P	5.00	10.00	10.20
EC7921WRA-R-3P	10.00	15.00	15.20
EC7921WRA-R-4P	15.00	20.00	20.20
EC7921WRA-R-5P	20.00	25.00	25.20
EC7921WRA-R-6P	25.00	30.00	30.20
EC7921WRA-R-7P	30.00	35.00	35.20
EC7921WRA-R-8P	35.00	40.00	40.20
EC7921WRA-R-9P	40.00	45.00	45.20
EC7921WRA-R-10P	45.00	50.00	50.20
EC7921WRA-R-11P	50.00	55.00	55.20
EC7921WRA-R-12P	55.00	60.00	60.20

Unit: mm

EC7921 SERIES

5.00mm pitch wire to board connector

EC7921WRA-RH

5.00mm pitch 90° Wafer

Reference Informations:

*Material:Insulator:Nylon 66+30%GF,UL94V-0

Terminal:Copper alloy

*Suitable EDCON- EC7921HC , EC7921HD series

Housing *Contact: Tin Plated 120u" over Ni 30u"min

Silver Plated 80~120u" over Ni 30u" min

*Compliant IEC 60695-2-11 and IEC 60335-1(750°C,Flamme<2S)

*Color:Ivory

Ordering Information:

EC7921WRA - RH - XP - * - **
 1 2 3 4 5

1.Part No.

2.Reverse Type

3.Circuit number.

4.Terminal Finish:

(blank):Tin over Nickel

S:Silver over Nickel

5.Pleas find page xxx~xxx for details.

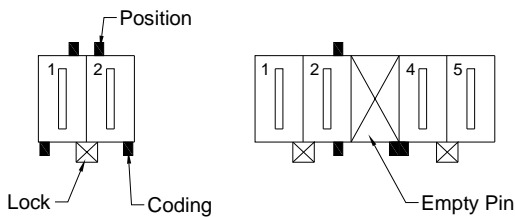
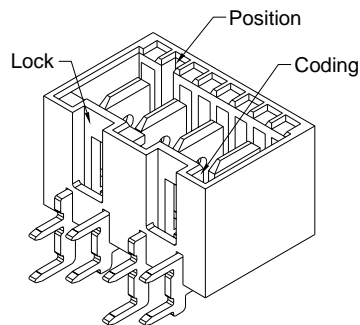
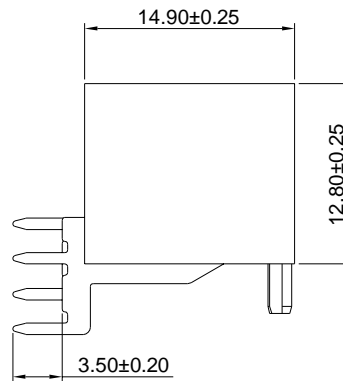
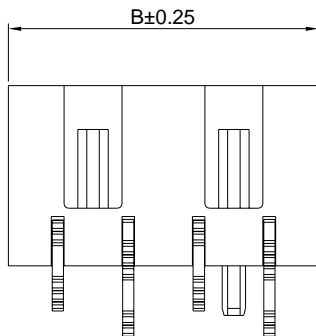
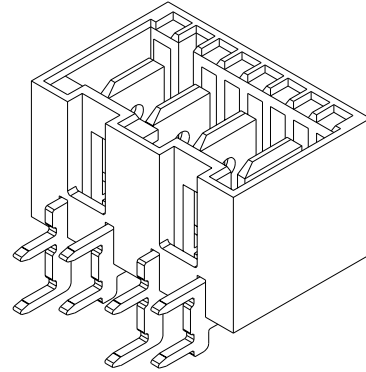
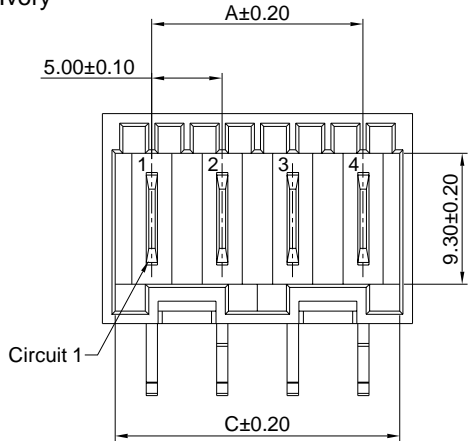

Ordering Information & Dimensions:

PART NO.	Dimensions		
	A	B	C
EC7921WRA-RH-2P	5.00	10.00	10.20
EC7921WRA-RH-3P	10.00	15.00	15.20
EC7921WRA-RH-4P	15.00	20.00	20.20
EC7921WRA-RH-5P	20.00	25.00	25.20
EC7921WRA-RH-6P	25.00	30.00	30.20
EC7921WRA-RH-7P	30.00	35.00	35.20
EC7921WRA-RH-8P	35.00	40.00	40.20
EC7921WRA-RH-9P	40.00	45.00	45.20
EC7921WRA-RH-10P	45.00	50.00	50.20
EC7921WRA-RH-11P	50.00	55.00	55.20
EC7921WRA-RH-12P	55.00	60.00	60.20

Unit: mm

EC7921 SERIES

5.00mm pitch wire to board connector

EC7921WRA-RH-F

5.00mm pitch 90° Wafer

Reference Informations:

- *Material: Insulator: Nylon 66+30%GF, UL94V-0
Terminal: Copper alloy
- *Suitable EDCON- EC7921HC, EC7921HD series
Housing *Contact: Tin Plated 120u" over Ni 30u"min
Silver Plated 80~120u" over Ni 30u" min
- *Compliant IEC 60695-2-11 and IEC 60335-1(750°C, Flamme<2S)
- *Color: Ivory

Ordering Information:

EC7921WRA - RH - F - XP - * - **
1 2 3 4 5 6

1. Part No.
2. Reverse Type
3. Foot
4. Circuit number.
5. Terminal Finish:
(blank): Tin over Nickel
S: Silver over Nickel
6. Please find page xxx-xxx for details.

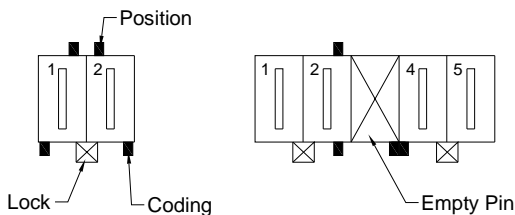
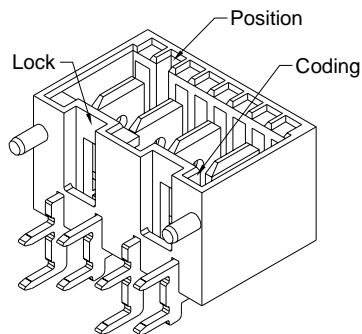
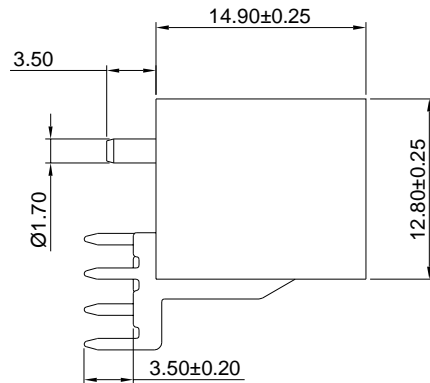
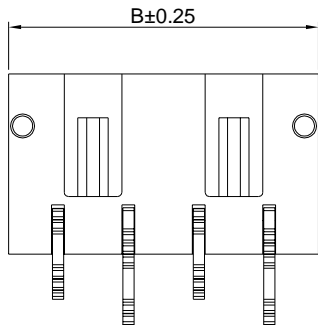
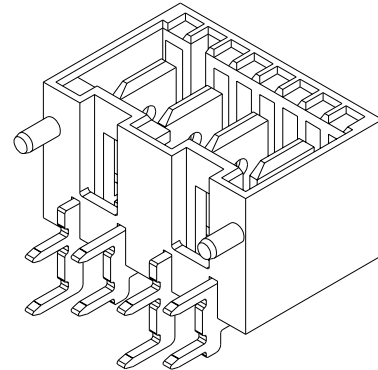
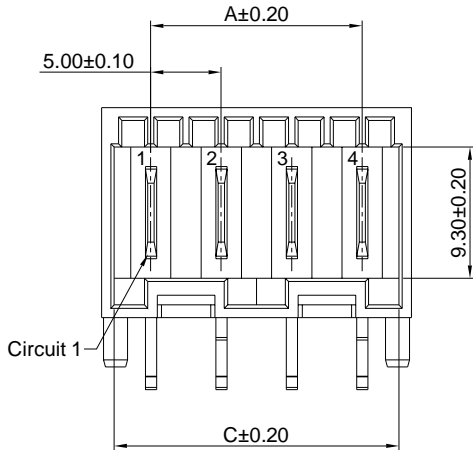

Ordering Information & Dimensions:

PART NO.	Dimensions		
	A	B	C
EC7921WRA-RH-F-2P	5.00	10.00	10.20
EC7921WRA-RH-F-3P	10.00	15.00	15.20
EC7921WRA-RH-F-4P	15.00	20.00	20.20
EC7921WRA-RH-F-5P	20.00	25.00	25.20
EC7921WRA-RH-F-6P	25.00	30.00	30.20
EC7921WRA-RH-F-7P	30.00	35.00	35.20
EC7921WRA-RH-F-8P	35.00	40.00	40.20
EC7921WRA-RH-F-9P	40.00	45.00	45.20
EC7921WRA-RH-F-10P	45.00	50.00	50.20
EC7921WRA-RH-F-11P	50.00	55.00	55.20
EC7921WRA-RH-F-12P	55.00	60.00	60.20

Unit: mm

EC7921 SERIES

5.00mm pitch wire to board connector

EC7921WVA

5.00mm pitch 180° Wafer

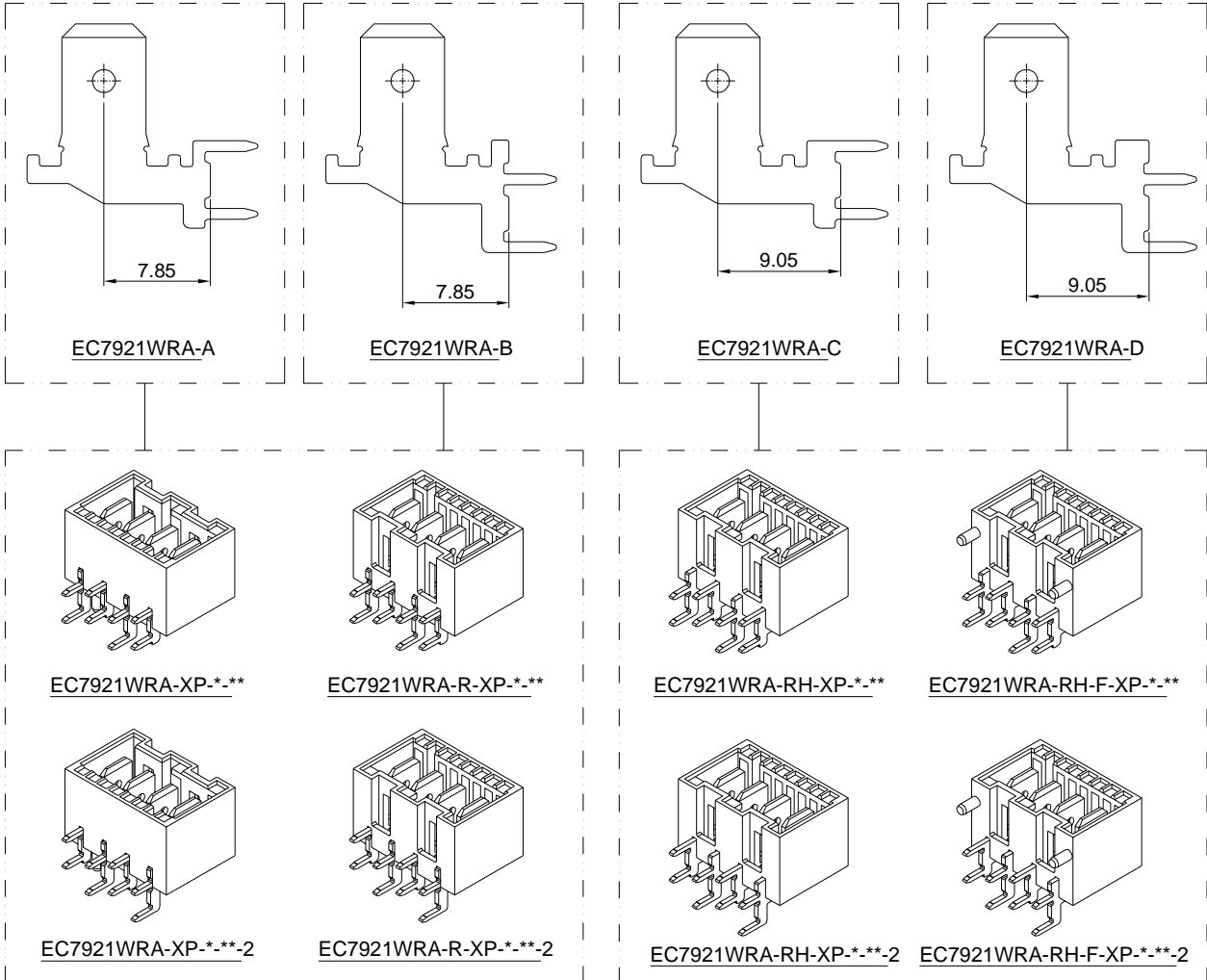

EC7921 SERIES

5.00mm pitch wire to board connector

EC7921WVA

5.00mm pitch 180° Wafer

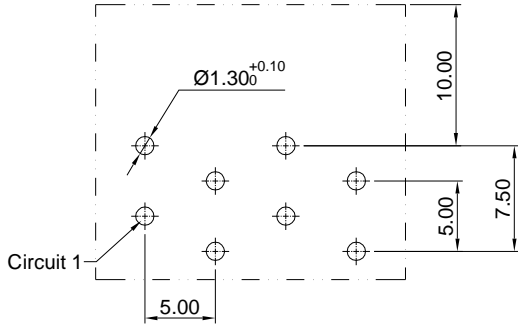

P.C.B LAYOUT
[EC7921WRA-XP-*]**

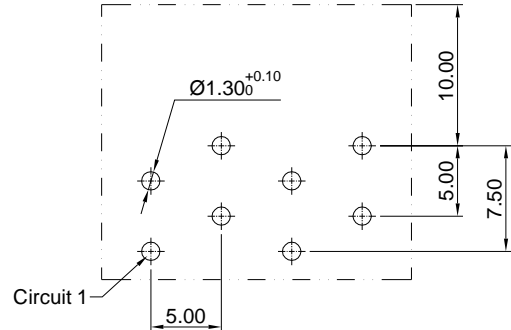

P.C.B LAYOUT
[EC7921WRA-XP-*]**-2]

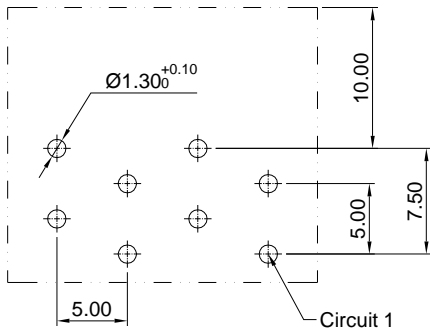

P.C.B LAYOUT
[EC7921WRA-R-XP-*]**
[EC7921WRA-RH-XP-*]**

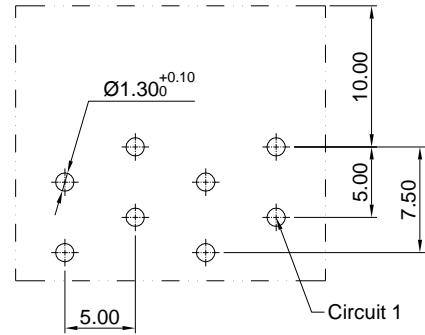

P.C.B LAYOUT
[EC7921WRA-R-XP-*]**-2]
[EC7921WRA-RH-XP-*]**-2]

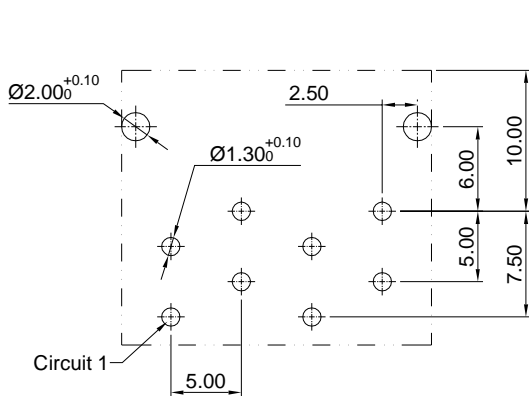

P.C.B LAYOUT
[EC7921WRA-RH-F-XP-*]**

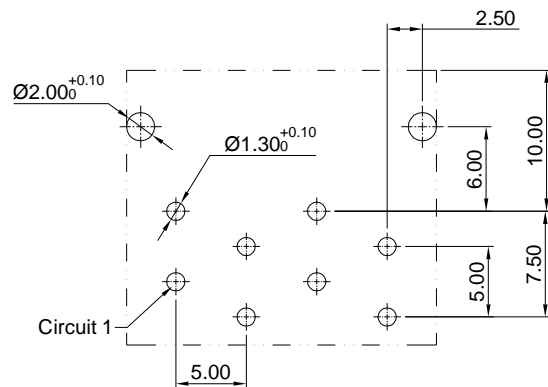

P.C.B LAYOUT
[EC7921WRA-RH-F-XP-*]**-2]

EC7921 SERIES

5.00mm pitch wire to board connector

Type	0A	0B	0C	0D	0E	0F	0G	0H	0I	0J	0K	0L	0M	0N	0P
2 PIN															
	0Q	0R	0S	0T	0U	0X	0Z	09	10	11	48	80	86		

Type	0A	0B	0C	0D	0E	0F	0G	0H	0I	0K	0L
3 PIN											
	0M	0N	0Q	0W	0Z	03	04	05	10	12	13
	1A	2N	2P	3Z	38	40	44	53	65	80	81
	98										

Type	0A	0B	0C	0D	0E	0F	0G	0H	0I
4 PIN									
	0J	0K	0L	0M	0W	01	02	03	04
	05	06	17	19	37	43	63	65	80
	81	82	84	86	GA(GREEN)	PA	PB		

Type	0A	0B	0C	0D	0E	0F	0G
5 PIN							
	01	02	03	04	05	06	07
	08	09	11	12	13	14	17
	18	20	21	22	23	24	25
	26	27	28	29	30	31	32
	33	34	35	36	43	49	50

EC7921 SERIES

5.00mm pitch wire to board connector

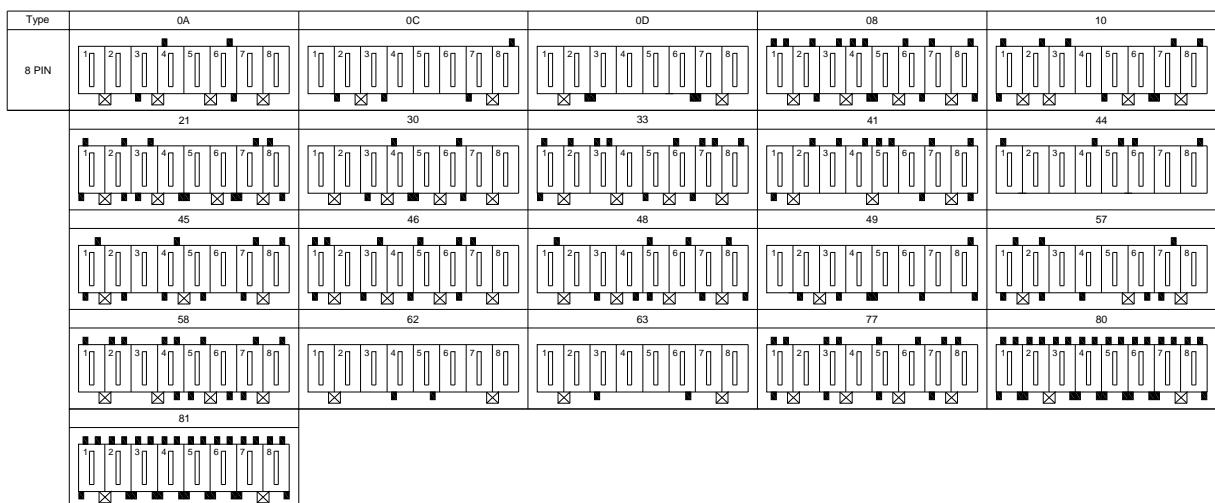
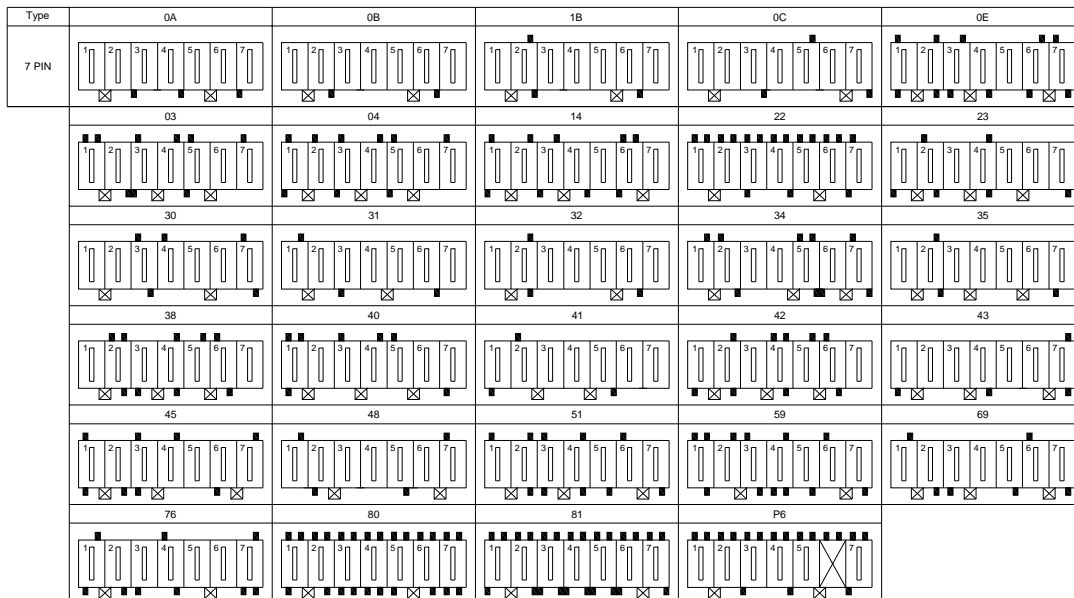
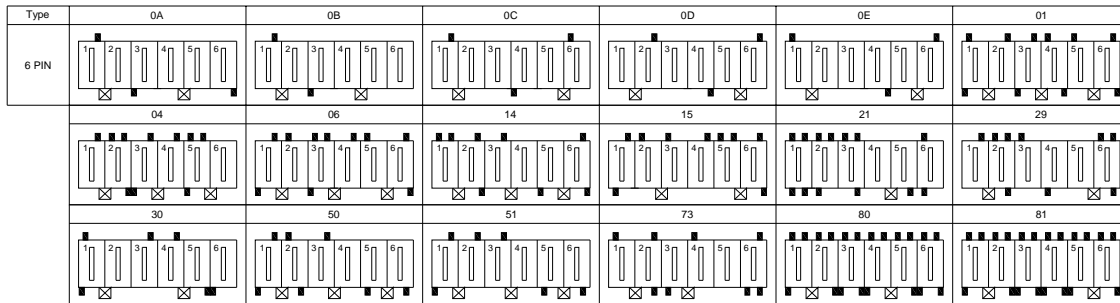
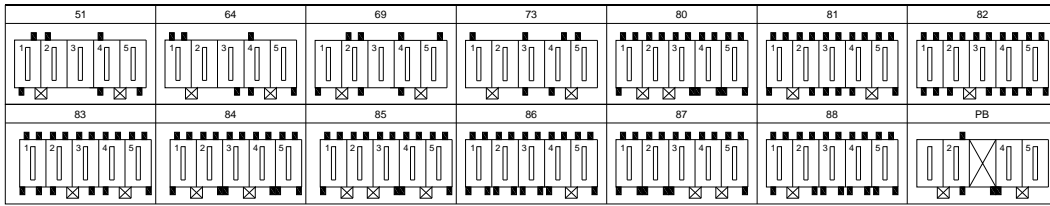

EC7921 SERIES

5.00mm pitch wire to board connector

Type	0A	0B	0C	0D
9 PIN				
	08	31	42	43
	48	49	52	53
57	58	80	81	

Type	0A	01	02	30
10 PIN				
	36	46	50	51
	52	64	70	72
74	75	76	80	

Type	0A	0B	0C
11 PIN			
	01	13	33
	55	60	64
80			

Type	27	30	59
12 PIN			
	27	30	59
65	80		