

EDCON-COMPONENTS

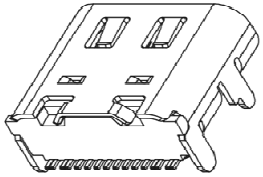

Contact



Specifications

Voltage Rating:	20 VAC
Current Rating:	5,0A max.
Operating Temperature:	- 30°C to + 85°C
Contact Resistance:	40m Ohm initial
Withstanding Voltage:	750VAC min.
Insulation Resistance:	>1000 M Ohm
Mating Force:	5~20N
UnMating Force:	8~20N
Salt Spray:	48H
Material Housing:	LCP
Insulator :	Black / White
Color:	Black / White
Contact Material:	Copper Alloy
Contact Plating:	Ni:50µ / Selective AU/GF
Shell:	SUS301
Lifetime:	10000 cycles

PCB Layout

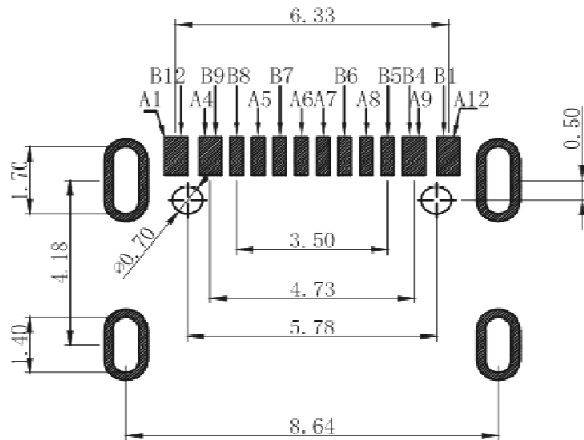

Drawing (dimensions all into mm)

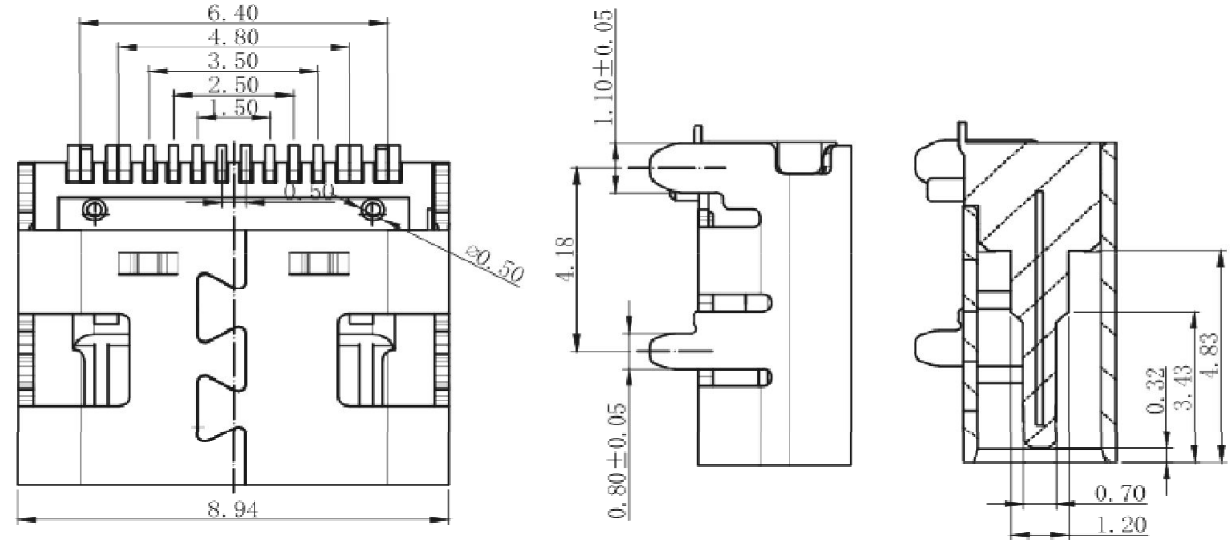

Tolerances unless otherwise specified (mm)

X	X.X	X.XX	X.XXX	Angle					
±	±	±	±	±3°					
DRW:	Jason	CHKD:	Wilson	MATL:	Wilson	TOLERANCE:	Mason	DATE:	09.03.2024
APPD:	Schumi	FINISH:	Jamy	Sheet No.:	1 from 3				

**SMT USB Connector Type C
12/16 Pin**

Part No.: **T64255**

Customer:

EDCON-COMPONENTS

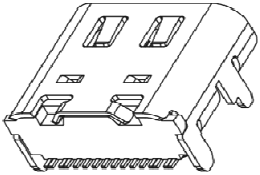

Contact

Dimension Information

A1	GND	B12	GND
A4	VBUS	B9	VBUS
A5	CC1	B8	SBU2
A6	DP1	B7	DN2
A7	DN1	B6	DP2
A8	SBU1	B5	CC2
A9	VBUS	B4	VBUS
A12	GND	B1	GND
PIN	SIGNAL NAME	PIN	SIGNAL NAME

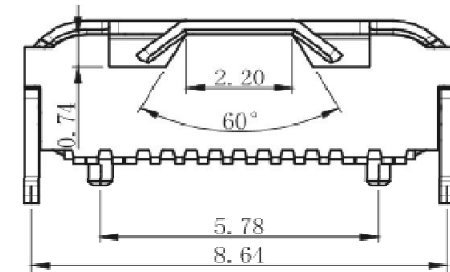
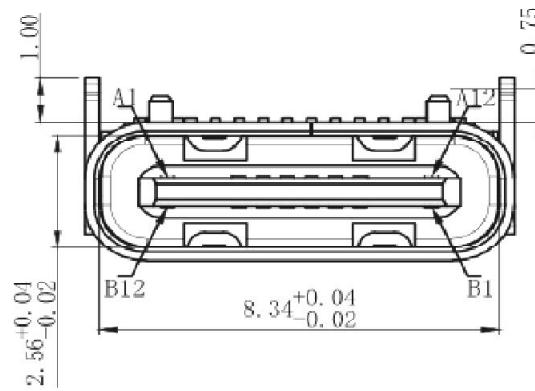

SMT USB Connector Type C 12/16 Pin	
Part No.:	T64255
Customer:	

DRW:	Jason	CHKD	Wilson	MATL:	Wilson	TOLERANCE	Mason	DATE	09.03.2024
APPD:	Schumi			FINISH	Jamy		Sheet No.	2 from 3	

EDCON-COMPONENTS

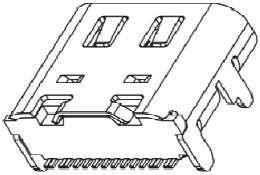

Contact



Ordering Informations

Serie	No of Pos.	Contact Plating	Contact Material	Body Colour	Shell Material	Insulator Material	Special function	ROHS	Packing
T64255	12	GF	PB	BK	SS	LC	N	R	TR

12= 16/12 No of Contacts	GF= Gold Flash		BK= Black	SS= Stainless Steel		N= No function	R= RoHS Conform	
		PB= Phosphor Bronze	WH= White		LC= LCP			TY= Tray Packing TR= Tape Reel Packing

SMT USB Connector Type C 12/16 Pin	
Part No.:	T64255
Customer:	

DRW:	Jason	CHKD	Wilson	MATL:	Wilson	TOLERANCE	Mason	DATE	09.03.2024
APPD:	Schumi			FINISH	Jamy		Sheet No.		2 from 3

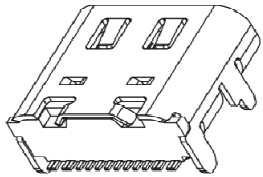

Contact



Soldering Profile Curve

Classification Reflow Profile (JEDEC J-STD-020C)

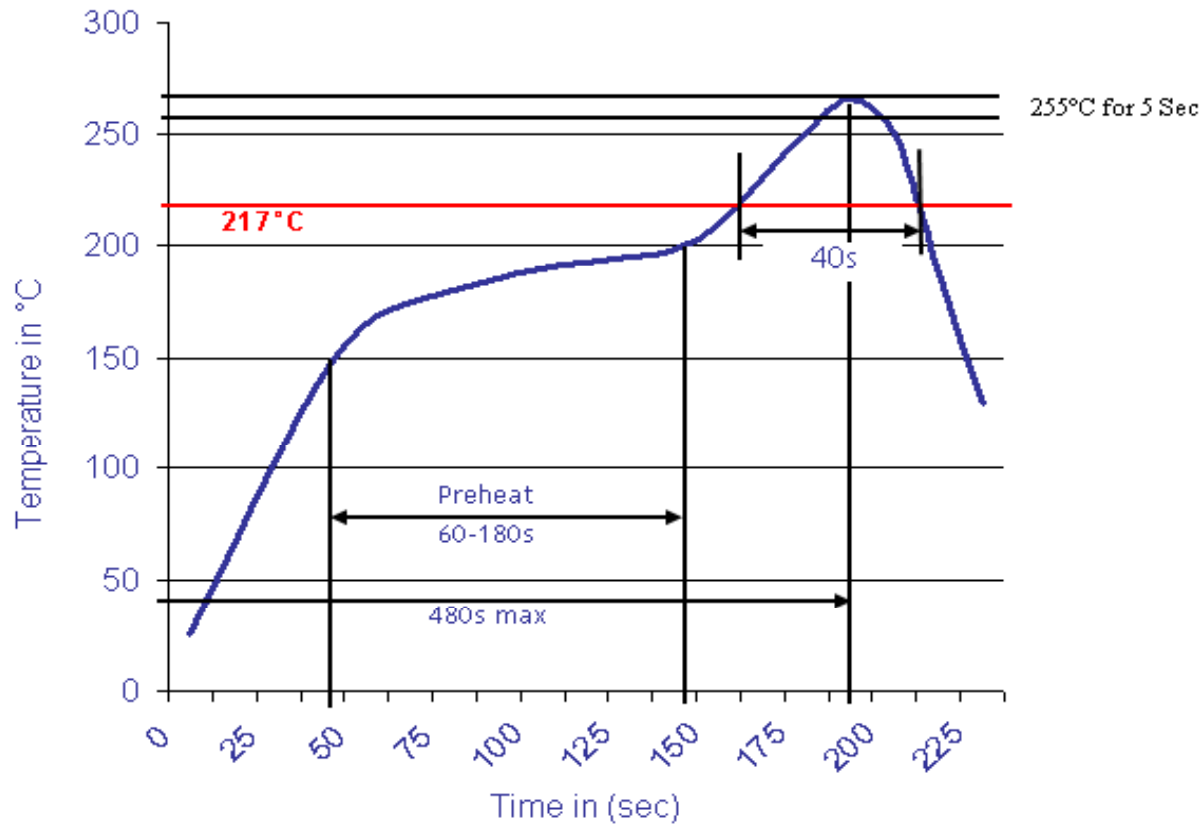

SMT USB Connector Type C 12/16 Pin

Part No.: **T64255**

Customer:

DRW:	Jason	CHKD	Wilson	MATL:	Wilson	TOLERANCE	Mason	DATE	09.03.2024
APPD:	Schumi			FINISH	Jamy		Sheet No.	3 from 3	