

# EDCON-COMPONENTS

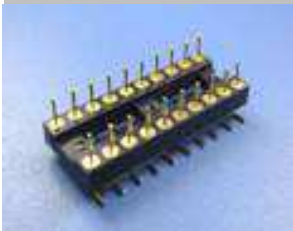

## Specifications

**Current Rating:** 1 Ampere  
**Insulator Resistance:** 1000 Megaohm min. V=100V  
**Contact Resistance:** 10m Ohm max.  
**Operating Temperature:** Gold Plated -40°C to +105°C  
 06P ~ 18P w/o center bar  
 20P ~ 28P with center bar  
**Contact Material:** Brass machined Contact  
**Insulator Material:** PPS, UL 94V-0  
**Operating Voltage:** 60 VAC/DC  
**Contact Plating:** Gold Flash Overall

## P.C.B Layout

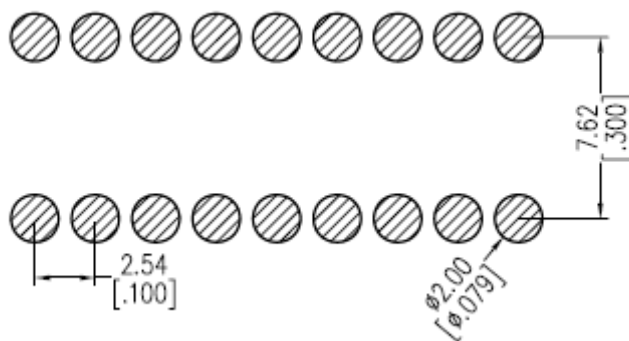

## Drawing

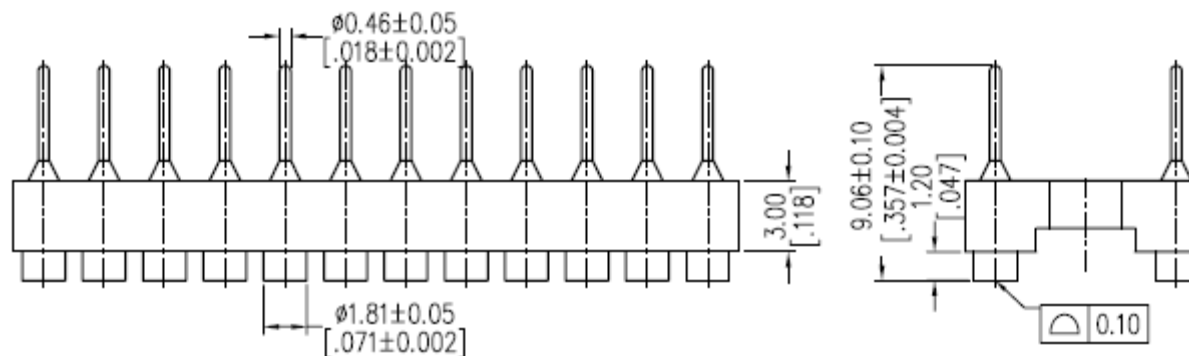
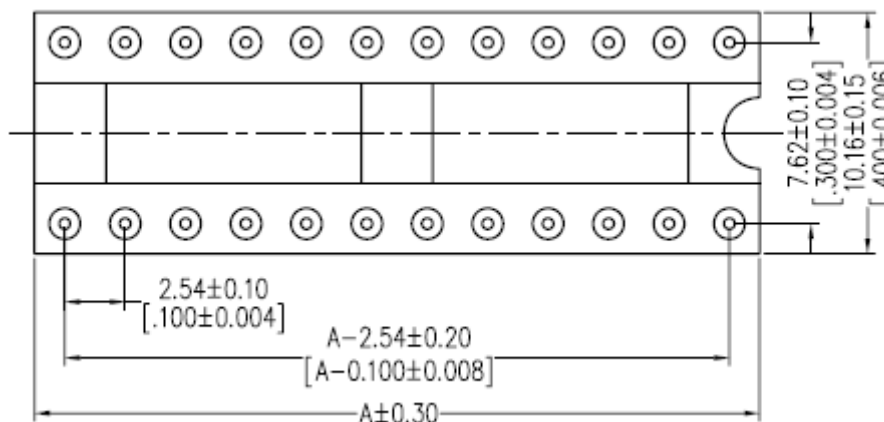

**SMT IC-Socket Male Type**

Part No.: **T34082-**

Customer:

DRW:	Jason	CHKD	Wilson	MATL:	Wilson	TOLERANCE	Mason	DATE	12.09.2013
APPD:	Schumi			FINISH	Jamy		Sheet No.	1 from 2	



## Pin Code length table free configuration

**No of Position ( Table 1)**

Order Code	Dimension (mm)			
	Width	Width		
306	7,62			
308	7,62			
310	7,62			
314	7,62			
316	7,62			
318	7,62			
320	7,62			
324	7,62			
328	7,62			
624		15,24		
628		15,24		
632		15,24		
640		15,24		
648		15,24		

**Pin Code length (Table 2)**

Order Code	Dimension		
	mm		
A01	9,06		
A02			
A03			
A04			
A05			
A06			
A07			
A08			
A09			
A10			
A11			
A12			
A13			
A14			
A15			
A16			
A17			
A18			
A19			
A20			
A21			
A22			

**Pin Code Diameter (Table 3)**

Order Code	Dimension		
	mm		
B01	0,46		
B02			
B03			
B04			
B05			
B06			
B07			
B08			
B09			
B10			
B11			
B12			
B13			
B14			
B15			
B16			
B17			
B18			
B19			
B20			
B21			
B22			

**SMT IC-Socket Male Type**

Part No.: **T34082-**

Customer:

DRW:	Jason	CHKD	Wilson	MATL:	Wilson	TOLERANCE	Mason	DATE	12.09.2013
APPD:	Schumi			FINISH	Jamy		Sheet No.		2 from 2

# EDCON-COMPONENTS

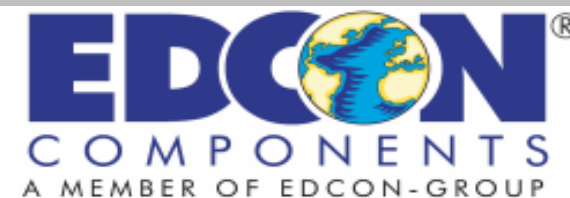
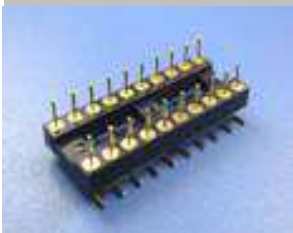

## Ordering Informations

Serie	No. of Pos. (table 1)	Contact Plating 1	Contact Plating 2	Isolator Material	Pin lenght (table 2)	Pin Diam. (table 3)	ROHS	Packing		
<b>T34082-</b>	<b>306</b>	<b>G0</b>	<b>G0</b>	<b>PP</b>	<b>A01</b>	<b>B01</b>	<b>R</b>	<b>TU</b>		

<b>306=</b> look table 1	<b>G0=</b> Gold Flash	<b>G0=</b> Gold Flash	<b>PP=</b> PPS	<b>A01=</b> look table 2	<b>B01=</b> look table 3	<b>N=</b> NO ROHS conform	<b>BU=</b> Bulk
	<b>T0=</b> Tin plated	<b>T0=</b> Tin plated					<b>TU=</b> Tube
	<b>GA=</b> 10µ Gold Plating	<b>GA=</b> 10µ Gold Plating				<b>R=</b> ROHS conform	<b>TY=</b> Tray Packing
	<b>GB=</b> 15µ Gold Plating	<b>GB=</b> 15µ Gold Plating					
	<b>GC=</b> 20µ Gold Plating	<b>GC=</b> 20µ Gold Plating					
	<b>S0=</b> Selectiv Plating Gold Flash / Tin	<b>S0=</b> Selectiv Plating Gold Flash / Tin					

### SMT IC-Socket Male Type

Part No.: **T34082-**

Customer:

DRW:	Jason	CHKD	Wilson	MATL:	Wilson	TOLERANCE	Mason	DATE	12.09.2013
APPD:	Schumi			FINISH	Jamy		Sheet No.		2 from 2