

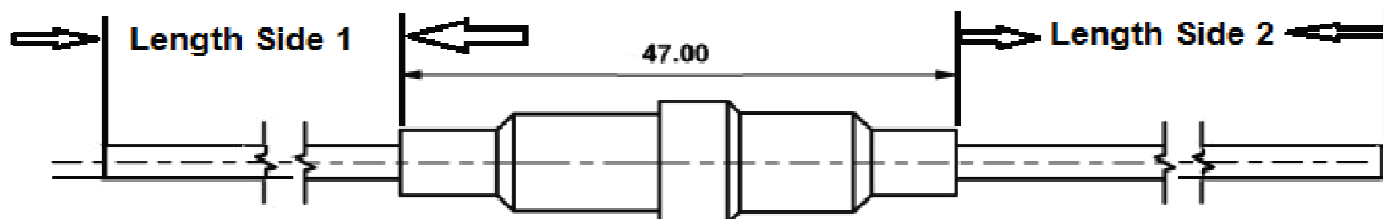

Electrical Specification

Suitable for Fuse: 5,0x20mm
 Max. Current: 10A / 6,3A=VDE
 Voltage: 300VAC / 250VAC=VDE
 Wire size: AWG14 ~AWG22
 Wire length: like ordering code
 Colour of wire: Red
 Colour of housing: Black
 Material of housing: PA66
 Approval: UL, VDE
 Contact Resistance: <20m Ω
 Insulation Resistance: >100M Ω
 Dielectric Strength: >1500VAX / 1Min

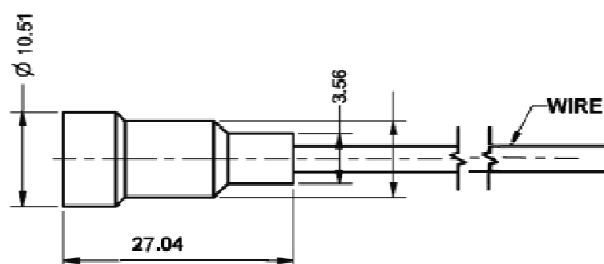
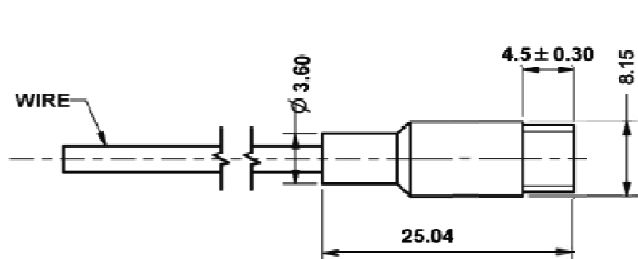

Serie	Case Colour	Wire Size	Wire Colour	Wire Length Side 1	Wire Length Side 1	ROHS	Packing
-------	-------------	-----------	-------------	--------------------	--------------------	------	---------

R55025	B	18	RD	050	351	R	BU
		18= AWG18	RD= Red	181= 180mm (Example)	351= 350mm (Example)	R= ROHS Conform	BU= Bulk- Ware
	B= Black	20= AWG20		050= 50mm Example	050= 50mm Example	N= NON ROHS	IV= Individual Packing
		22= AWG22	00= no wire	000= without Wire	000= without Wire		
		16= AWG16					
		14= AWG14					
		00= without Wire					

**Inline Fuse Holder for
 5,0x20mm Fuse w. Approval**
 Part No.: **R55025**
 Customer:

DRW:	Jason	CHKD	Jules	MATL:	Wu	DATE	02.02.2023
APPD:	Join			FINISH	Shieh	Sheet	1 from 1