

# EDCON-COMPONENTS



## SPECIFICATION:

Current Rating:	3 Ampere
Max. Voltage Rating:	250V AC/DC
Mim. Voltage Rating:	5V AC/DC 1mA
Insulator Resistance:	50 Megaohm min.
Dielectric Withstanding:	AC 2000V
Operating Temperature:	.-25°C to +55°C
Contact Material:	Copper, Alloy
Insulator Material:	Polyester, UL 94V-0
Standard:	P.B.T.
Contact Plating Standard:	Gold Flash Overall
Vibrations Resistance:	10 to 55Hz.
Protection Degree:	IP40
Ellectrical Lifetime:	100000 cyles
Mechanical Lifetime:	1000000 Cycles
Approval:	UL, CE

## Drawing

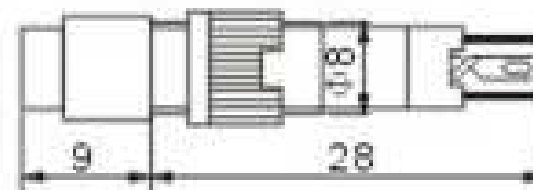
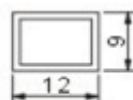

## Hole Dimension (mm)

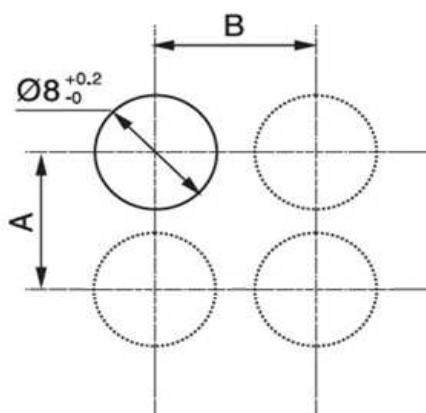

A	B	Form
≥10mm	≥10mm	Round
≥10mm	≥10mm	Square
≥10mm	≥14mm	Rectangle

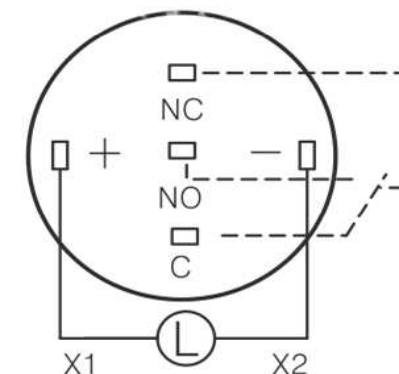
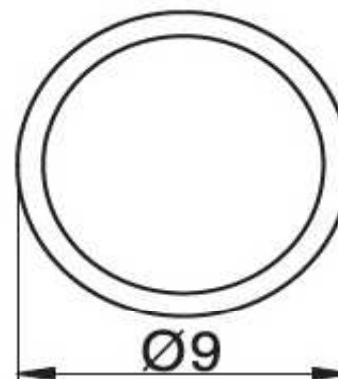

**8mm Switch with Indicator (Square)**

Part No.: **Q58044**

DRW:	Jason	CHKD	Wilson	MATL:	Wilson	TOLERANCE	Mason	DATE	06.05.2021
APPD:	Schumi			FINISH	Jamy		Sheet No.		1 from 2

Customer:  
email: [info@edcon-components.com](mailto:info@edcon-components.com)

# EDCON-COMPONENTS



## Ordering Informations

Serie	Knob Colour	Lamp Voltage	Contact Form	Special function	Special function	Special function	ROHS	Packing		
<b>Q58044</b>	<b>RD</b>	<b>0</b>	<b>NO</b>	<b>A</b>	<b>N</b>	<b>N</b>	<b>R</b>	<b>BU</b>		

<b>RD= Red</b>	<b>0= without LED</b>	<b>NO = Form NO</b>	<b>A = Momentary function SPDT</b>	<b>N = No special function</b>	<b>N = No special function</b>	<b>N= Non ROHS</b>	<b>BU= Bulk Ware</b>
<b>GN= Green</b>	<b>F= 6,3VDC</b>	<b>NC = Form NC</b>	<b>L = Self-Locking function SPDT</b>			<b>R= ROHS conform</b>	
<b>YE= Yellow</b>	<b>E= 12VDC</b>						
<b>BL= Blue</b>	<b>D= 24VDC</b>						
<b>WH= White</b>	<b>A= 220VAC</b>						
<b>BK= Black</b>							
<b>OR= Orange</b>							

<b>8mm Switch with Indicator (Square)</b>
Part No.: <b>Q58044</b>
Customer:

DRW:	Jason	CHKD	Wilson	MATL:	Wilson	TOLERANCE	Mason	DATE	06.05.2021
APPD:	Schumi			FINISH	Jamy		Sheet No.		2 from 2