

EDCON-COMPONENTS



SPECIFICATION:

Circuit: SPST
 Function: Momentary
 Current Rating: 50mA
 Voltage Rating: 12 VDC
 Dielectric withstanding Volt: 250VAC for 1 minute
 Full Travel: 3,2mm (2,15mm)
 Insulation resistance: 300M Ω min.
 Operating Force: 390nm max.
 Total travel: 0,25mm +/- 0,1mm
 Operating lifetime: 50000 cycles min.
 Operating Temperature: -10°C ~ +70°C
 Storage Temperature: -30°C ~ +85°C
 Material:
 Contact Material: Brass
 Contact Plating: silver or tin plated
 Contact resistance: 100m Ω max.
 Body: Nylon 66 UL rated 94V-2
 Frame: Nylon 66 UL rated 94V-2

Drawing / Dimension (mm)

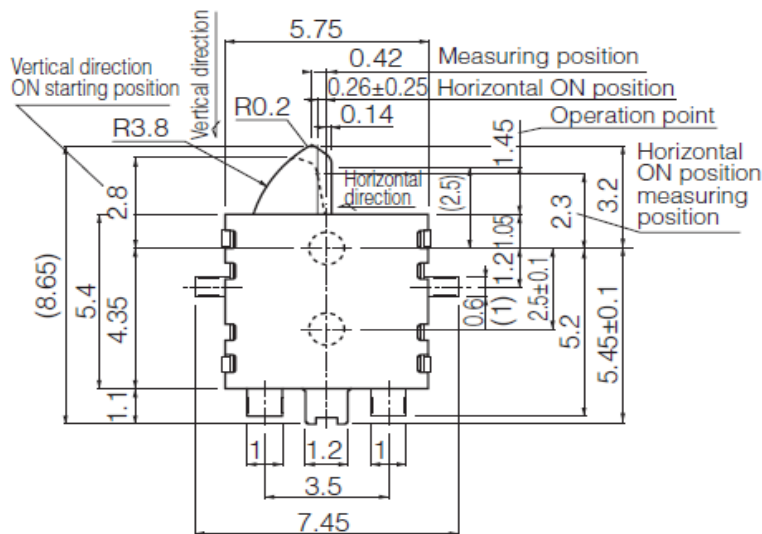

Illuminated: No
 Illuminated colors: look order code

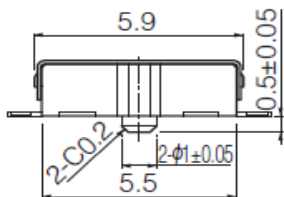

Tolerances unless otherwise specified (mm)				
x	x.x	x.xx	x.xxx	Angle
±	±	±	±	±3°
DRW:	Jason	CHKD	Wilson	MATL:
APPD:	Schumi			FINISH
				Jamy
				Sheet No.
				17.03.2021
				1 from 4

SMD Detector SWITCH	
Part No.:	Q22063
Customer:	

EDCON-COMPONENTS



P.C.B Layout (mm)

Circuit

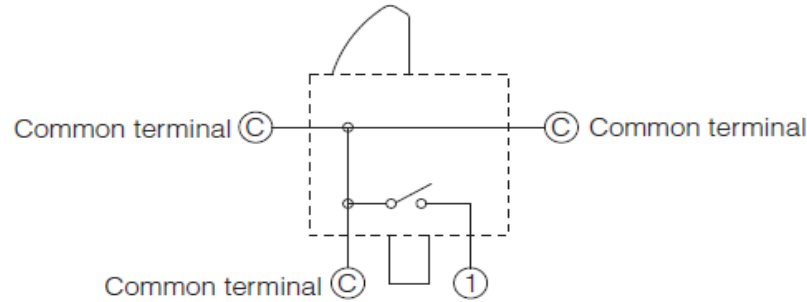
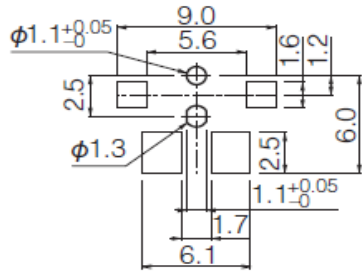

SMD Detector SWITCH

Part No.: **Q22063**

Customer:

DRW:	Jason	CHKD	Wilson	MATL:	Wilson	TOLERANCE	Mason	DATE	17.03.2021
APPD:	Schumi			FINISH	Jamy		Sheet No.	2 from 4	

www.edcon-components.com

email: info@edcon-components.com

EDCON-COMPONENTS



Ordering Informations

Serie	Knob Type	Knob Height	Circuit	Solder Pin Length	Special function E	Special function F	Special function G	ROHS	Packing
Q22063	A0	B0	C0	D0	E0	F0	G0	R	BU

A0= No function	B0= No function	C0= No function	D0= No function	E0= No function	F0= No function	G0= No function	R= ROHS conform	BU= Bulk Ware
							N= Non ROHS	TY= Tray Packing
								TR102 = Tape/Reel
								IV= Individual Packing

SMD Detector SWITCH	
Part No.:	Q22063
Customer:	

DRW:	Jason	CHKD	Wilson	MATL:	Wilson	TOLERANCE	Mason	DATE	17.03.2021
APPD:	Schumi			FINISH	Jamy		Sheet No.		3 from 4



Soldering Profile for Lead Free Soldering

Soldering Profile for Reflow Soldering

Classification Reflow Profile (JEDEC J-STD-020C)

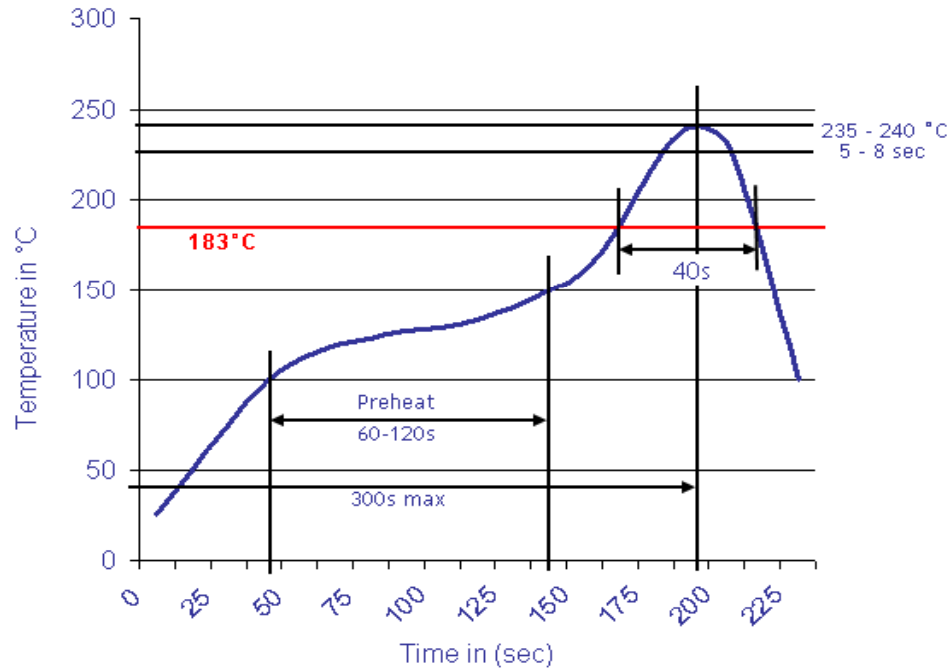

SMD Detector SWITCH

Part No.: **Q22063**

DRW:	Jason	CHKD	Wilson	MATL:	Wilson	TOLERANCE	Mason	DATE	17.03.2021
APPD:	Schumi			FINISH	Jamy		Sheet No.	4 from 4	

Customer: