

EDCON-COMPONENTS



SPECIFICATION:

Voltage Rating:	12VDC
Current Rating:	50mA
Mechanical Life:	500000 cycles
Contact Resistance:	<200m Ω max. (initial)
Insulation Resistance:	>100M Ω min. 500VDC
Dielectric Strength:	100VAC/1min.
Operating Temperature:	.-10°C ~ +60°C
Operating Force:	look Ordering Code

Drawing / Dimensions (mm)

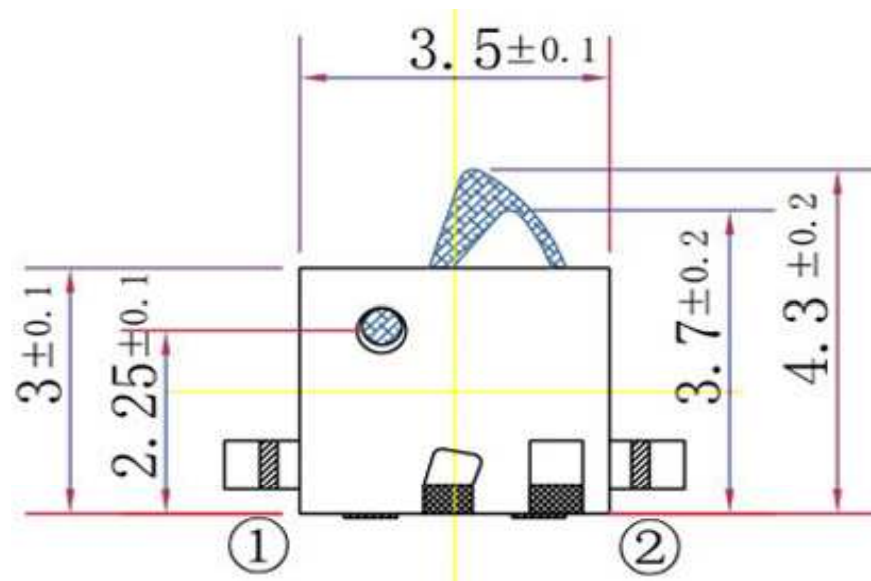

PCB-Layout TOP VIEW

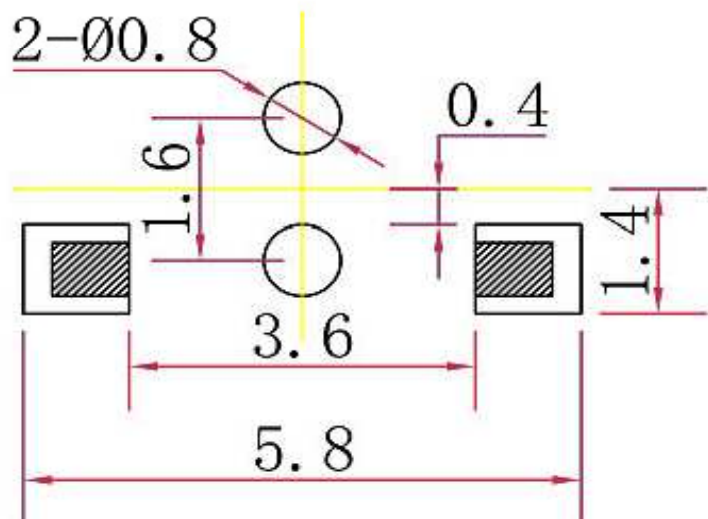

Tolerances unless otherwise specified (mm)				
x	x.X	x.XX	x.XXX	Angle
±	±	±	±	±3°
DRW:	Jason	CHKD	Wilson	MATL:
APPD:	Schumi			FINISH

SMT Detector Switch	
Part No.:	Q22027
Customer:	

EDCON-COMPONENTS



Circuit

Drawing / Dimensions (mm)

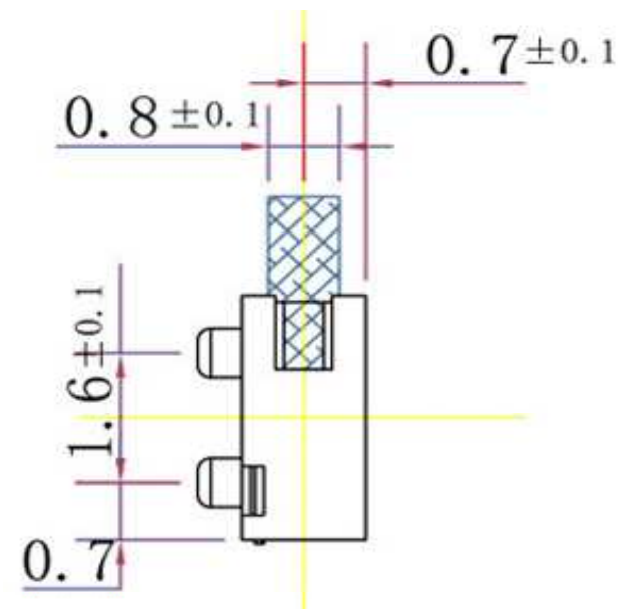
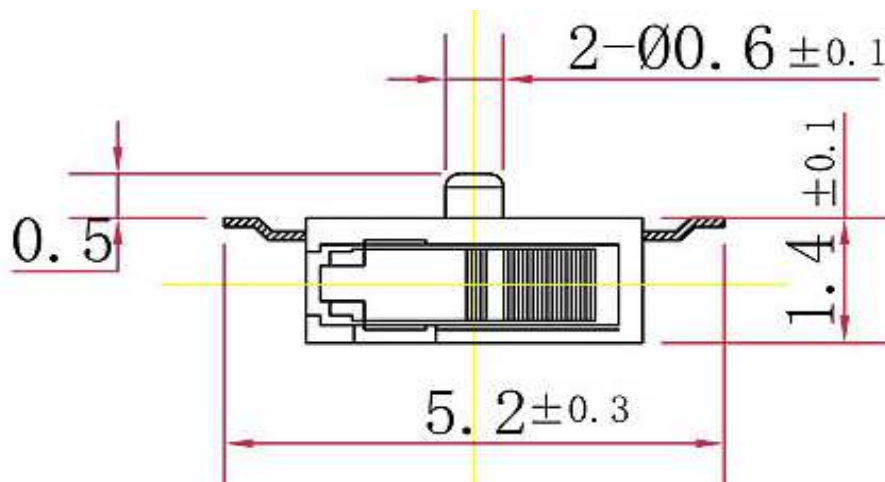

SMT Detector Switch

Part No.: **Q22027**
Customer:

DRW:	Jason	CHKD	Wilson	MATL:	Wilson	TOLERANCE	Mason	DATE	18.04.2021
APPD:	Schumi			FINISH	Jamy		Sheet No.	2 from 4	

EDCON-COMPONENTS



Ordering Informations

Serie	Total height w. Body	Fill with 0	Operating Force	Polarisation Peg	Electrical life	Cap Option	Cap Colour	Special function	ROHS	Packing
Q22027	014	X	030	Y	503	N	N	N	R	TR

050 = 5,0mm	X = no function	030 = 30gr	N = without Peg	503 = 50000 Cycles	N = No Cap option	N = No Cap Option	N = No Function	N = Non ROHS	TR = Tape/Reel Packing
			Y = with Peg					R = ROHS conform	TU = Tube Packing
									BU = Bulk Ware

SMT Detector Switch

Part No.: **Q22027**

DRW:	Jason	CHKD	Wilson	MATL:	Wilson	TOLERANCE	Mason	DATE	18.04.2021
APPD:	Schumi			FINISH	Jamy		Sheet No.		3 from 4

Customer:



Soldering Profile Lead Free Curve

Classification Reflow Profile (JEDEC J-STD-020C)

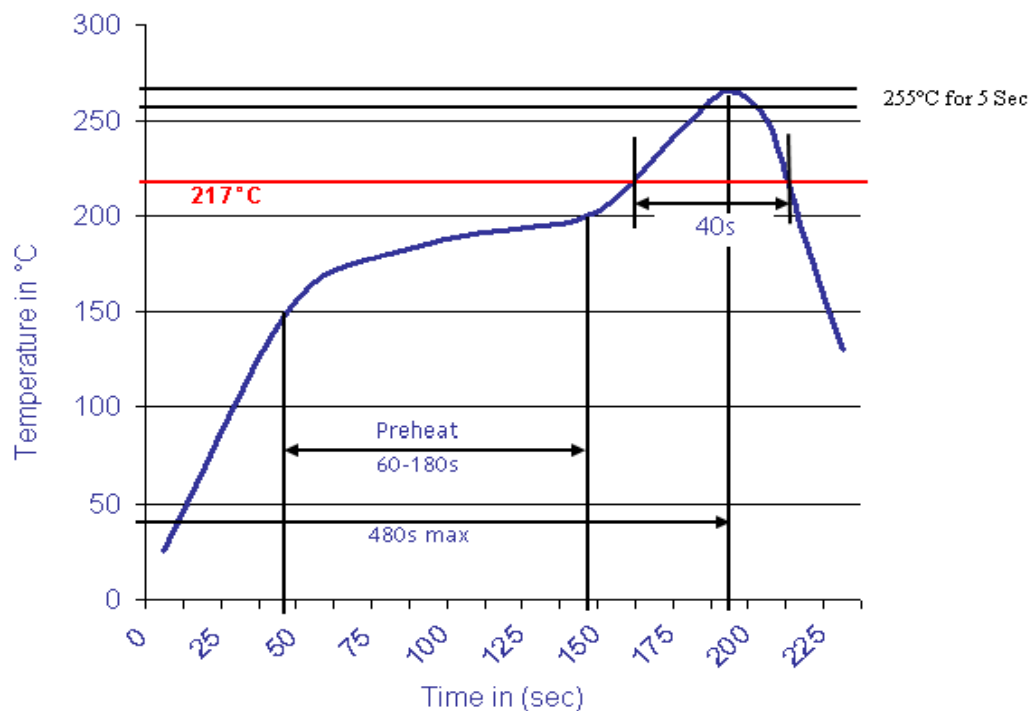

SMT Detector Switch	
Part No.:	Q22027
Customer:	

DRW:	Jason	CHKD	Wilson	MATL:	Wilson	TOLERANCE	Mason	DATE	18.04.2021
APPD:	Schumi			FINISH	Jamy		Sheet No.	4 from 4	