

EDCON-COMPONENTS



Technical Discription

Material: Phosphor Bronze
 Surface Plating: Silver Plate
 Plastic: Nylon 46



Drawing

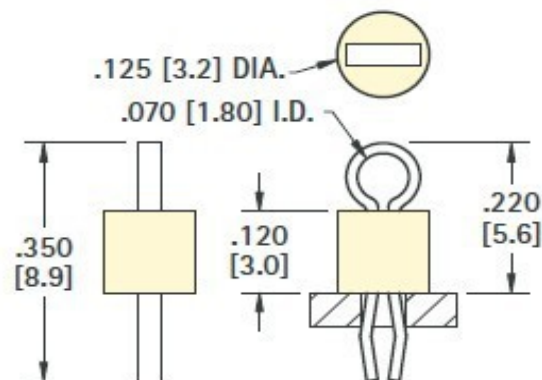

THT Test Point Type 2

Part No.: **N22006**

Customer:

DRW:	Jason	CHKD	Wilson	MATL:	Wilson	TOLERANCE	Mason	DATE	12.02.2019
APPD:	Schumi			FINISH	Jamy		Sheet No.		1 from 2

EDCON-COMPONENTS



Ordering Informations

Serie	Colour	Material	Special Function	ROHS	Packing	
-------	--------	----------	------------------	------	---------	--

N22006	BK	PB	00	R	BU	
---------------	-----------	-----------	-----------	----------	-----------	--

BK= Black	PB= Phosphor Bronze	00= No Function	R= ROHS Conform	BU= Bulk-Ware
BL= Blue			N= NON ROHS Conform	
RD= Red				
PU= Purple				
OR= Orange				
GN= Green				
GY= Gray				
WH= White				
YE= Yellow				

Aquivalent to EDCON

EDCON

5005	Red	RD
5006	Black	BK
5007	White	WH
5008	Orange	OR
5009	Yellow	YE
5120	Brown	RN
5121	Green	GN
5122	Blue	BL
5123	Grey	GY
5124	Purple	PU

THT Test Point Type 2

Part No.: **N22006**

Customer:

DRW:	Jason	CHKD	Wilson	MATL:	Wilson	TOLERANCE	Mason	DATE	12.02.2019
APPD:	Schumi			FINISH	Jamy		Sheet No.		2 from 2