

# EDCON-COMPONENTS



## Technical Informations

Material: Nylon 66  
 Flame Class: UL 94V-2 / V0  
 Color: Natural / Black  
 Temperature Range: . -40°C ~ +85°C

## Dimension (mm)

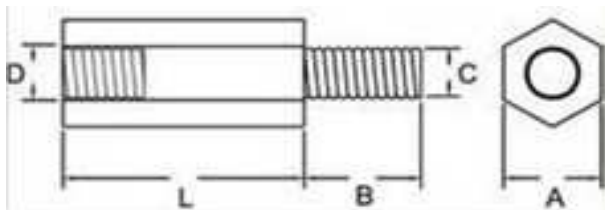

We can make custom specifications

## Ordering Code table

Order Code	A	B	C	D	L
A01	5,0	8,0	M3	M3	10,0
A02	5,0	8,0	M3	M3	12,0
A03	5,0	8,0	M3	M3	15,0
A04	5,0	8,0	M3	M3	18,0
A05	5,0	8,0	M3	M3	20,0
A06	5,0	8,0	M3	M3	25,0
A07	5,5	6,0	M3	M3	5,0
A08	5,5	6,0	M3	M3	6,0
A09	5,5	6,0	M3	M3	7,0
A10	5,5	6,0	M3	M3	7,5
A11	5,5	6,0	M3	M3	8,0
A12	5,5	6,0	M3	M3	9,0
A13	5,5	6,0	M3	M3	10,0
A14	5,5	6,0	M3	M3	10,5
A15	5,5	6,0	M3	M3	11,0
A16	5,5	6,0	M3	M3	12,0
A17	5,5	6,0	M3	M3	12,7
A18	5,5	6,0	M3	M3	13,0
A19	5,5	6,0	M3	M3	14,0
A20	5,5	6,0	M3	M3	15,0
A21	5,5	6,0	M3	M3	15,5
A22	5,5	6,0	M3	M3	16,0
A23	5,5	6,0	M3	M3	16,5
A24	5,5	6,0	M3	M3	17,0
A25	5,5	6,0	M3	M3	18,0
A26	5,5	6,0	M3	M3	18,5
A27	5,5	6,0	M3	M3	19,0

Order Code	A	B	C	D	L
A28	5,5	6,0	M3	M3	19,5
A29	5,5	6,0	M3	M3	20,0
A30	5,5	6,0	M3	M3	21,0
A31	5,5	6,0	M3	M3	22,0
A32	5,5	6,0	M3	M3	24,5
A33	5,5	6,0	M3	M3	25,0
A34	5,5	6,0	M3	M3	27,0
A35	5,5	6,0	M3	M3	28,5
A36	5,5	6,0	M3	M3	30,0
A37	5,5	6,0	M3	M3	33,0
A38	5,5	6,0	M3	M3	34,5
A39	5,5	6,0	M3	M3	35,0
A40	5,5	6,0	M3	M3	40,0
A41	5,5	6,0	M3	M3	45,0
A42	5,5	6,0	M3	M3	53,5
A43	6,0	8,0	M3	M3	5,0
A44	6,0	8,0	M3	M3	6,0
A45	6,0	8,0	M3	M3	7,0
A46	6,0	8,0	M3	M3	8,0
A47	6,0	8,0	M3	M3	9,0
A48	6,0	8,0	M3	M3	10,0
A49	6,0	8,0	M3	M3	11,0

**Metric Hexagonal Male/Female  
Nylon Threaded Spacer M3**

Part No.: **N14213**

Customer:

DRW:	Jason	CHKD	Wilson	MATL:	Wilson	TOLERANCE	Mason	DATE	01.02.2013
APPD:	Schumi			FINISH	Jamy		Sheet No.		1 from 4

# EDCON-COMPONENTS



## Ordering Code table

Order Code	A	B	C	D	L
A50	6,0	8,0	M3	M3	12,0
A51	6,0	8,0	M3	M3	13,0
A52	6,0	8,0	M3	M3	14,0
A53	6,0	8,0	M3	M3	15,0
A54	6,0	8,0	M3	M3	16,0
A55	6,0	8,0	M3	M3	17,0
A56	6,0	8,0	M3	M3	18,0
A57	6,0	8,0	M3	M3	19,0
A58	6,0	8,0	M3	M3	20,0
A59	6,0	8,0	M3	M3	21,0
A60	6,0	8,0	M3	M3	22,0
A61	6,0	8,0	M3	M3	23,0
A62	6,0	8,0	M3	M3	24,0
A63	6,0	8,0	M3	M3	25,0
A64	6,0	8,0	M3	M3	26,0
A65	6,0	8,0	M3	M3	27,0
A66	6,0	8,0	M3	M3	28,0
A67	6,0	8,0	M3	M3	29,0
A68	6,0	8,0	M3	M3	30,0
A69	6,0	8,0	M3	M3	31,0
A70	6,0	8,0	M3	M3	32,0
A71	6,0	8,0	M3	M3	33,0
A72	6,0	8,0	M3	M3	34,0
A73	6,0	8,0	M3	M3	35,0
A74	6,0	8,0	M3	M3	36,0
A75	6,0	8,0	M3	M3	37,0
A76	6,0	8,0	M3	M3	38,0

Order Code	A	B	C	D	L
A77	6,0	8,0	M3	M3	39,0
A78	6,0	8,0	M3	M3	40,0
A79	6,0	8,0	M3	M3	41,0
A80	6,0	8,0	M3	M3	42,0
A81	6,0	8,0	M3	M3	43,0
A82	6,0	8,0	M3	M3	44,0
A83	6,0	8,0	M3	M3	45,0
A84	6,0	8,0	M3	M3	46,0
A85	6,0	8,0	M3	M3	47,0
A86	6,0	8,0	M3	M3	48,0
A87	6,0	8,0	M3	M3	49,0
A88	6,0	8,0	M3	M3	50,0
A89	6,0	8,0	M3	M3	51,0
A90	6,0	8,0	M3	M3	52,0
A91	6,0	8,0	M3	M3	53,0
A92	6,0	8,0	M3	M3	54,0
A93	6,0	8,0	M3	M3	55,0
A94	6,0	8,0	M3	M3	56,0
A95	6,0	8,0	M3	M3	57,0
A96	6,0	8,0	M3	M3	58,0
A97	6,0	8,0	M3	M3	59,0
A98	6,0	8,0	M3	M3	60,0
A99	8,0	8,0	M3	M3	5,0
B01	8,0	8,0	M3	M3	6,0
B02	8,0	8,0	M3	M3	7,0
B03	8,0	8,0	M3	M3	8,0
B04	8,0	8,0	M3	M3	9,0

Order Code	A	B	C	D	L
B05	8,0	8,0	M3	M3	10,0
B06	8,0	8,0	M3	M3	11,0
B07	8,0	8,0	M3	M3	12,0
B08	8,0	8,0	M3	M3	13,0
B09	8,0	8,0	M3	M3	14,0
B10	8,0	8,0	M3	M3	15,0
B11	8,0	8,0	M3	M3	16,0
B12	8,0	8,0	M3	M3	17,0
B13	8,0	8,0	M3	M3	18,0
B14	8,0	8,0	M3	M3	19,0
B15	8,0	8,0	M3	M3	20,0
B16	8,0	8,0	M3	M3	21,0
B17	8,0	8,0	M3	M3	22,0
B18	8,0	8,0	M3	M3	23,0
B19	8,0	8,0	M3	M3	24,0
B20	8,0	8,0	M3	M3	25,0
B21	8,0	8,0	M3	M3	26,0
B22	8,0	8,0	M3	M3	27,0
B23	8,0	8,0	M3	M3	28,0
B24	8,0	8,0	M3	M3	29,0
B25	8,0	8,0	M3	M3	30,0
B26	8,0	8,0	M3	M3	31,0
B27	8,0	8,0	M3	M3	32,0

**Metric Hexagonal Male/Female  
Nylon Threaded Spacer M3**

Part No.: **N14213**

Customer:

DRW:	Jason	CHKD	Wilson	MATL:	Wilson	TOLERANCE	Mason	DATE	01.02.2013
APPD:	Schumi			FINISH	Jamy		Sheet No.		2 from 4

# EDCON-COMPONENTS



## Ordering Code table

Order Code	A	B	C	D	L
B28	8,0	8,0	M3	M3	33,0
B29	8,0	8,0	M3	M3	34,0
B30	8,0	8,0	M3	M3	35,0
B31	8,0	8,0	M3	M3	36,0
B32	8,0	8,0	M3	M3	37,0
B33	8,0	8,0	M3	M3	38,0
B34	8,0	8,0	M3	M3	39,0
B35	8,0	8,0	M3	M3	40,0
B36	8,0	8,0	M3	M3	41,0
B37	8,0	8,0	M3	M3	42,0
B38	8,0	8,0	M3	M3	43,0
B39	8,0	8,0	M3	M3	44,0
B40	8,0	8,0	M3	M3	45,0
B41	8,0	8,0	M3	M3	46,0
B42	8,0	8,0	M3	M3	47,0
B43	8,0	8,0	M3	M3	48,0
B44	8,0	8,0	M3	M3	49,0
B45	8,0	8,0	M3	M3	50,0
B46	8,0	8,0	M3	M3	51,0
B47	8,0	8,0	M3	M3	52,0
B48	8,0	8,0	M3	M3	53,0
B49	8,0	8,0	M3	M3	54,0
B50	8,0	8,0	M3	M3	55,0
B51	8,0	8,0	M3	M3	56,0
B52	8,0	8,0	M3	M3	57,0
B53	8,0	8,0	M3	M3	58,0
B54	8,0	8,0	M3	M3	59,0

Order Code	A	B	C	D	L
B55	8,0	8,0	M3	M3	60,0
B56					
B57					
B58					
B59					
B60					
B61					
B62					
B63					
B64					
B65					
B66					
B67					
B68					
B69					
B70					
B71					
B72					
B73					
B74					
B75					
B76					
B77					
B78					
B79					
B80					
B81					

Order Code	A	B	C	D	L
B82					
B83					
B84					
B85					
B86					
B87					
B88					
B89					
B90					
B91					
B92					
B93					
B94					
B95					
B96					
B97					
B98					
B99					
C01					
C02					
C03					
C04					
C05					

**Metric Hexagonal Male/Female  
Nylon Threaded Spacer M3**

Part No.: **N14213**

Customer:

DRW:	Jason	CHKD	Wilson	MATL:	Wilson	TOLERANCE	Mason	DATE	01.02.2013
APPD:	Schumi			FINISH	Jamy		Sheet No.	3 from 4	

# EDCON-COMPONENTS



## Ordering Informations

Serie	Order Code	Material	Color	ROHS	Packing					
<b>N14213</b>	<b>A01</b>	<b>NY</b>	<b>WH</b>	<b>R</b>	<b>BU</b>					

<b>A01</b> = Look orde table	<b>NY</b> = Nylon 66	<b>WH</b> = White	<b>R</b> = ROHS Conform	<b>BU</b> = Bulk-Ware			
		<b>BK</b> = Black	<b>N</b> = NON ROHS Conform	<b>IV</b> = Individual Packing			

<b>Metric Hexagonal Male/Female Nylon Threaded Spacer M3</b>	
Part No.:	<b>N14213</b>
Customer:	

DRW:	Jason	CHKD	Wilson	MATL:	Wilson	TOLERANCE	Mason	DATE	01.02.2013
APPD:	Schumi			FINISH	Jamy		Sheet No.	4 from 4	