

EDCON-COMPONENTS



Technical Informations

Material: Nylon 66
 Flame Class: UL 94V-2
 Color: Natural
 Temperature Range: -40°C ~ +85°C

Ordering Code table

Order Code	Screw	OD	ID	H	Fig.		
A01	M3	5,0	2,5	0,6	1		
A02	M3	6,7	2,5	0,8	1		
A03	M3	6,7	2,5	1,2	1		
A04	M4	8,0	3,3	1,0	1		
A05	M4	15,0	4,6	0,9	1		
A06	M5	15,0	5,0	0,9	1		
A07	M6	15,0	6,0	0,9	1		
A08	M2	4,8	2,2	0,5	2		
A09	M2	4,8	2,2	0,8	2		
A10	M2	4,8	2,2	1,0	2		
A11	M2	8,0	2,5	0,5	2		
A12	M4	11,5	4,60	0,9	3		
A13	M4	7,0	3,70	0,5	2		
A14	M4	7,0	3,20	0,5	2		
A15							
A16							
A17							
A18							
A19							
A20							
A21							
A22							
A23							
A24							
A25							
A26							
A27							

Dimension (mm)

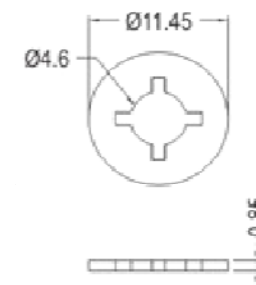
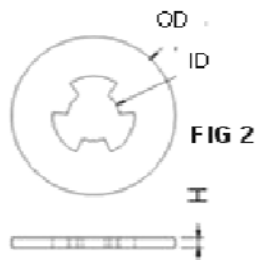
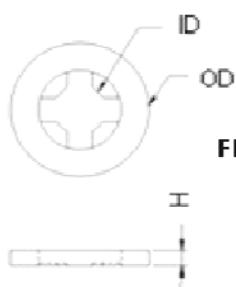

Figur 3

Srew Retaining Washer

Part No.: **N14185**

Customer:

DRW:	Jason	CHKD	Wilson	MATL:	Wilson	TOLERANCE	Mason	DATE	13.09.2017
APPD:	Schumi			FINISH	Jamy		Sheet No.		1 from 1

EDCON-COMPONENTS



Ordering Informations

Serie	Order Code	Material	Color	ROHS	Packing					
N14185	A01	NY	WH	R	BU					

A01= Length	NY= Nylon	WH= White	R= ROHS Conform	BU= Bulk-Ware					
			N= NON ROHS Conform	IV= Individual Packing					

Srew Retaining Washer	
Part No.:	N14185
Customer:	

DRW:	Jason	CHKD	Wilson	MATL:	Wilson	TOLERANCE	Mason	DATE	13.09.2017
APPD:	Schumi			FINISH	Jamy			Sheet No.	2 from 2