

EDCON-COMPONENTS



Technical Informations

Material: Nylon 66 (UL)
 Flame Class: 94V-2
 Color: Natural
 Temperature Range: -40°C ~ +85°C

Ordering Code table

Order Code	D	B	A	C
A01	M4	6,0	7,0	2,6
A02	M4	8,0	7,0	2,6
A03	M4	10,0	7,0	2,6
A04	M4	12,0	7,0	2,6
A05	M4	16,0	7,0	2,6
A06	M4	20,0	7,0	2,6
A07	M4	25,0	7,0	2,6
A08	M4	30,0	7,0	2,6
A09	M4	35,0	7,0	2,6
A10	M4	40,0	7,0	2,6
A11				
A12				
A13				
A14				
A15				
A16				
A17				
A18				
A19				
A20				
A21				
A22				
A23				
A24				
A25				
A26				
A27				

Dimension (mm)

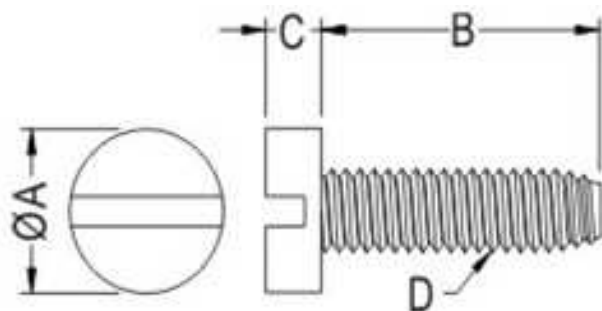

**Metric Slotted Cheese
Head Screw**

Part No.: **N14020**

DRW:	Jason	CHKD	Wilson	MATL:	Wilson	TOLERANCE	Mason	DATE	31.01.2013	Customer:
APPD:	Schumi			FINISH	Jamy		Sheet No.	1 from 1		

EDCON-COMPONENTS



Ordering Informations

Serie	Order Code	Material	Color	ROHS	Packing					
N14020	A01	NY	WH	R	BU					

A01= Length	NY= Nylon	WH= White	R= ROHS Conform	BU= Bulk-Ware			
			N= NON ROHS Conform	IV= Individual Packing			

Metric Slotted Cheese Head Screw	
Part No.:	N14020
Customer:	

DRW:	Jason	CHKD	Wilson	MATL:	Wilson	TOLERANCE	Mason	DATE	31.01.2013
APPD:	Schumi			FINISH	Jamy			Sheet No.	2 from 2