

EDCON-COMPONENTS

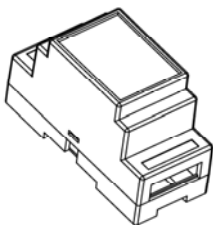

Technical Discription

Temperature Range:	ABS= -40°C ~ +80°C
Material:	ABC / PC
Dimension	88x59x37mm
Order Size Code:	A01

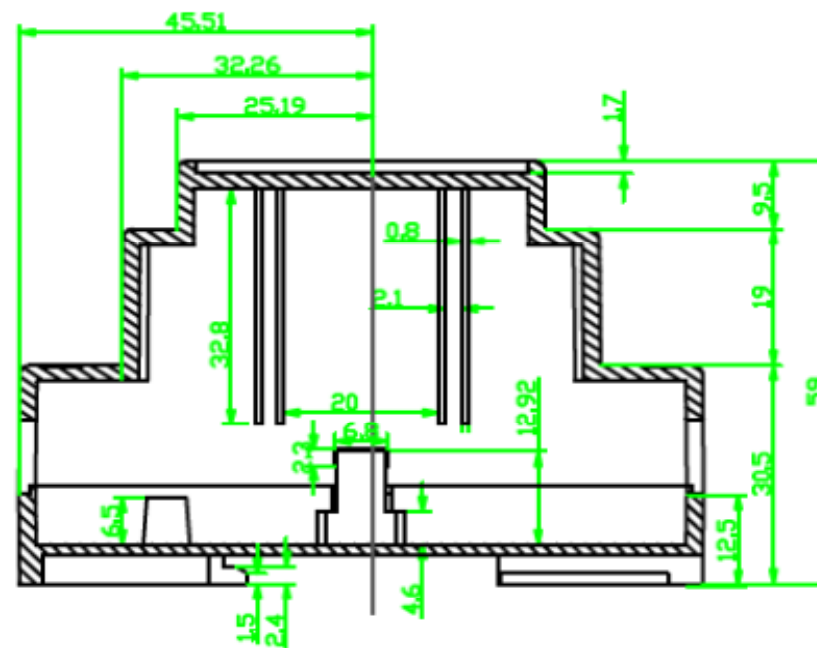

截面 A-A

DIN Rail Enclosure	
Part No.:	H17001
Customer:	

DRW:	Jason	CHKD	Wilson	MATL:	Wilson	TOLERANCE	Mason	DATE	05.12.2019
APPD:	Schumi			FINISH	Jamy		Sheet No.	1 from 3	

www.edcon-components.com

email: info@edcon-components.com

EDCON-COMPONENTS

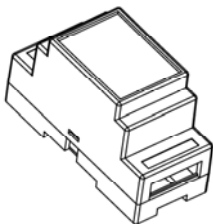

Technical Drawing

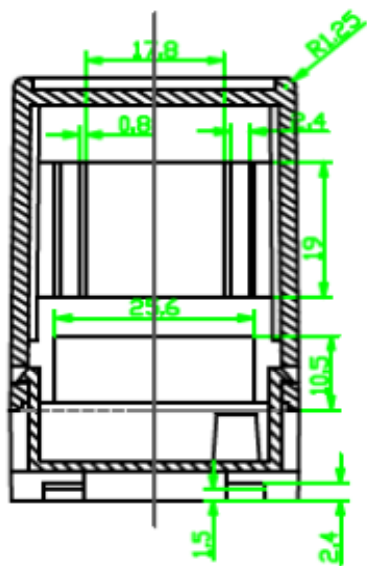

截面 B-B

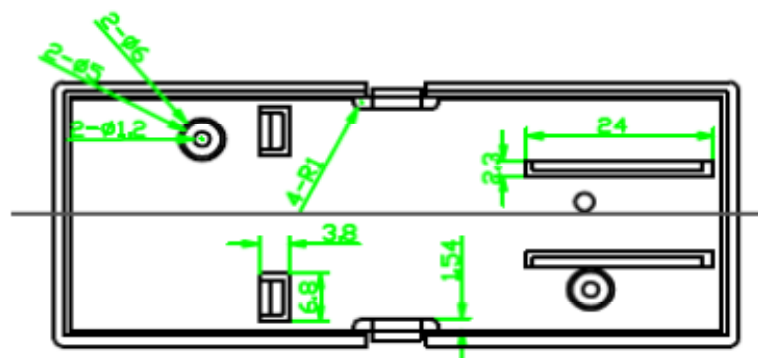
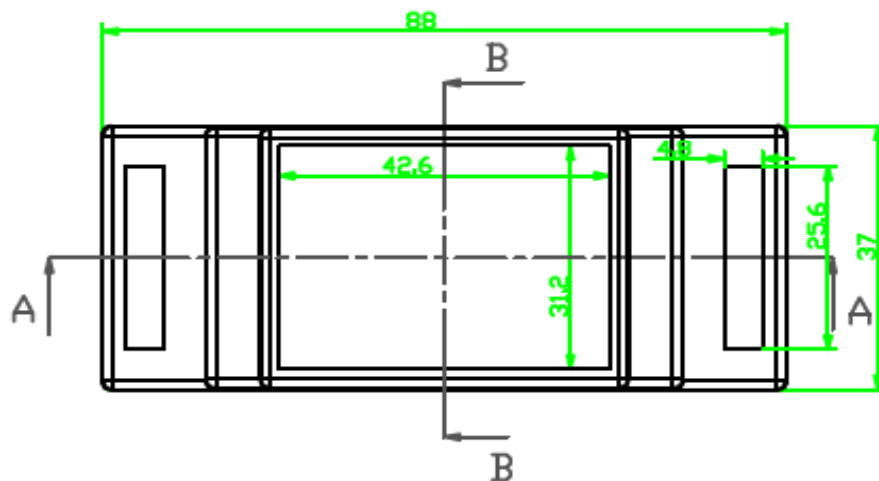

下壳俯视图

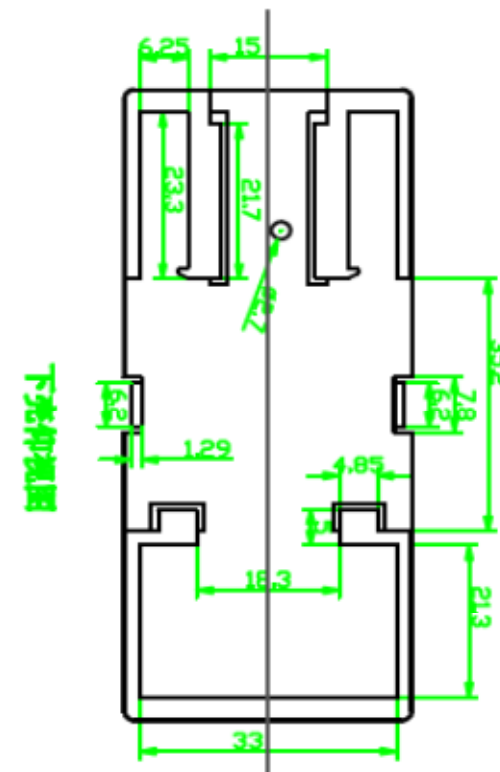

下壳仰视图

DIN Rail Enclosure	
Part No.:	H17001
Customer:	

DRW:	Jason	CHKD	Wilson	MATL:	Wilson	TOLERANCE	Mason	DATE	05.12.2019
APPD:	Schumi			FINISH	Jamy		Sheet No.		2 from 3

EDCON-COMPONENTS

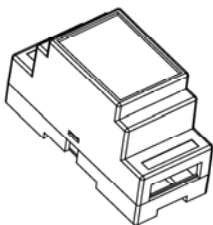

Ordering Informations

Serie	Size Order Code	Material Base	Color Base	Material Cover	Color Cover	Special function	Special function	Special function	ROHS	Packing
H17001	A01	A	G	A	G	N	N	N	R	S
A01= Size like table	A= ABS P= Polycar - bonat	G= Gray L= Light Gray	A= ABS P= Polycar - bonat	G= Gray	N= No special function	N= No special function	N= No special function	R= ROHS Conform N= NON ROHS Conform	S= Standard Packing I= Individual Packing	

DIN Rail Enclosure
Part No.: H17001
Customer:

DRW:	Jason	CHKD	Wilson	MATL:	Wilson	TOLERANCE	Mason	DATE	05.12.2019
APPD:	Schumi			FINISH	Jamy		Sheet No.	3 from 3	