

# EDCON-COMPONENTS



Drawing inch / mm

**Note**

Material: Stainless Steel  
 Thickness: 0.01 / 0,25 inch/mm  
 Surface: TIN NICKEL PLATE

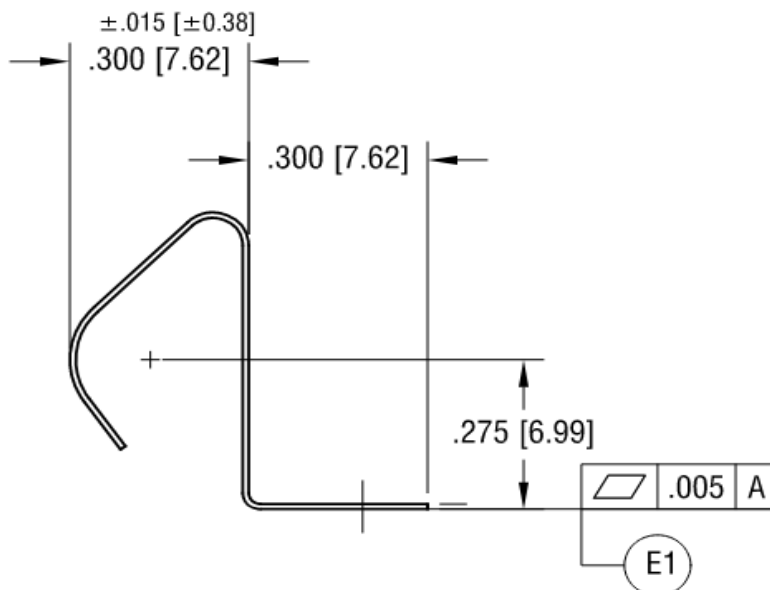
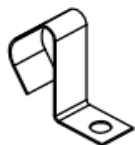
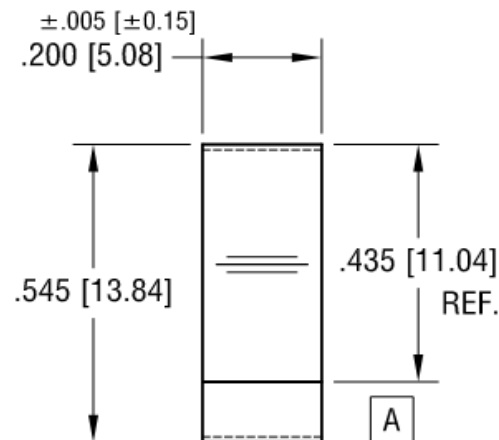
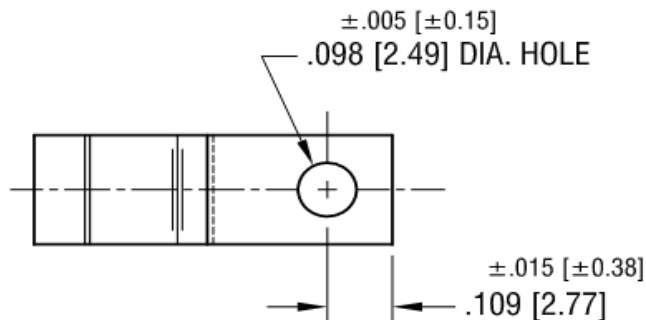

Tolerances  
 Inch .+/-0,01  
 mm .+/-0,25  
 Angle .+/-2°

<b>SMD-PCB Battery-Clip</b>	
<b>A, AA, N, CR2, CR123, 9V</b>	
Part No.:	<b>B38013</b>
Customer:	

Unless otherwise specified									
DRW:	Jason	CHKD	Wilson	MATL:	Wilson	TOLERANCE	Mason	DATE	19.09.2021
APPD:	Schumi			FINISH	Jamy		Sheet No.		1 from 3

[www.edcon-components.com](http://www.edcon-components.com)

email: [info@edcon-components.com](mailto:info@edcon-components.com)

# EDCON-COMPONENTS



## Ordering Informations

## PCB Layout inch/mm AAA / N Battery-Clip

Serie	Special function	Special Code	ROHS	Packing	
-------	------------------	--------------	------	---------	--

<b>B38013</b>	<b>N</b>	<b>N</b>	<b>R</b>	<b>BU</b>	
---------------	----------	----------	----------	-----------	--

<b>N</b> = No special function	<b>N</b> = No special function	<b>R</b> = ROHS Conform	<b>BU</b> = Bulk-Ware

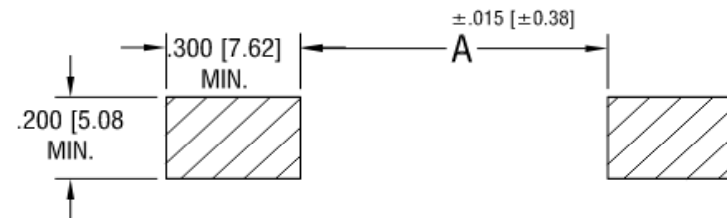

Battery Size	A= Dim
2/3A	1.71 / 43,4
AA	2.380 / 60,45

<b>SMD-PCB Battery-Clip</b>	
<b>A, AA, N, CR2, CR123, 9V</b>	
Part No.:	<b>B38013</b>
Customer:	

DRW:	Jason	CHKD	Wilson	MATL:	Wilson	TOLERANCE	Mason	DATE	19.09.2021
APPD:	Schumi			FINISH	Jamy		Sheet No.		2 from 3



Soldering Profile Curve

Classification Reflow Profile (JEDEC J-STD-020C)

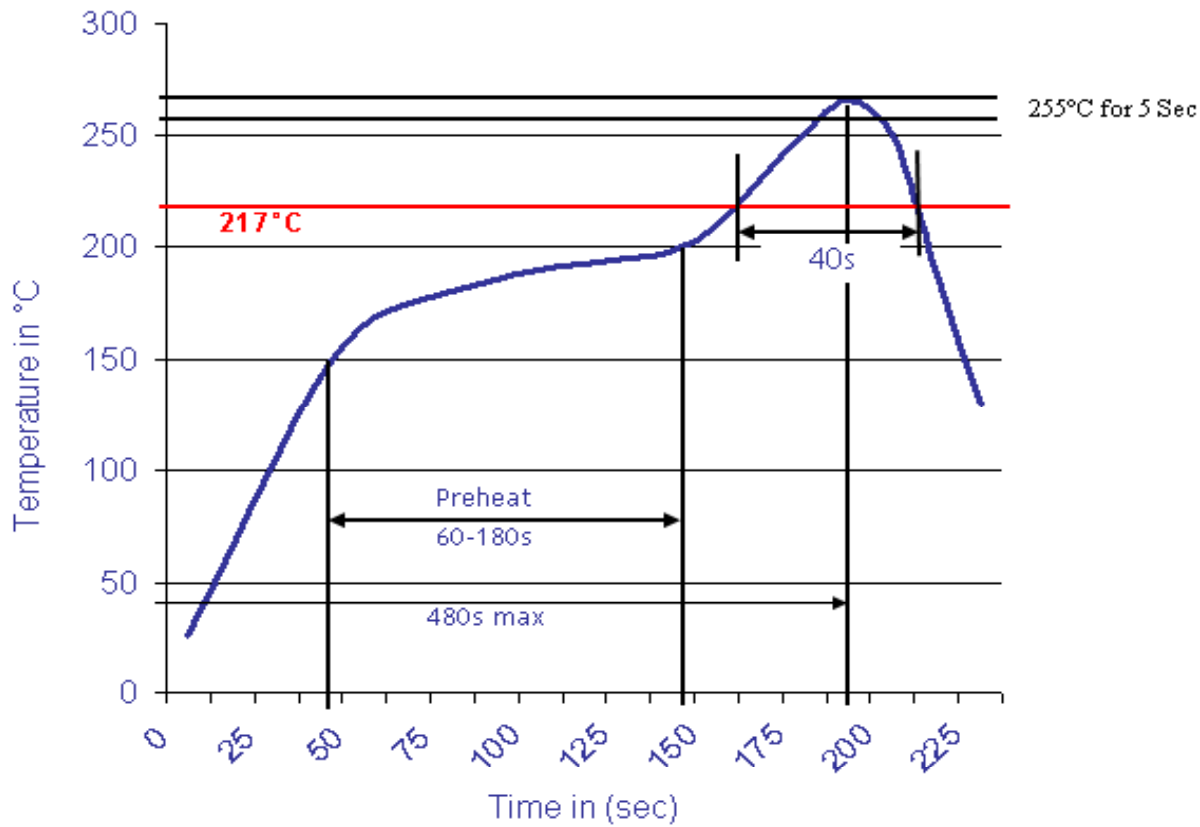

<b>SMD-PCB Battery-Clip</b>	
<b>A, AA, N, CR2, CR123, 9V</b>	
Part No.:	<b>B38013</b>
Customer:	

DRW:	Jason	CHKD	Wilson	MATL:	Wilson	TOLERANCE	Mason	DATE	19.09.2021
APPD:	Schumi			FINISH	Jamy		Sheet No.		3 from 3