



### Technical Specification

Insulator Material:	PBT UL94V-0
Contact Resistance:	30m Ohm max.
Insulator Resistance:	1000M Ohm max.
Temperature Rating:	.-50°C ~ 145°C
Contact Material:	Steel
Contact:	Tin-Nickel Plate
Dielectric Voltage:	750VAC
Durability:	50 Cycles min.
Application for:	Coin Type
Battery Type: 1Cell	2354
Battery Type: 2Cell	2320, 2325, 2330

### Dimension of Holder

Inch					
H	L	O.D			
0,452	1,219	1,093			

mm					
H	L	O.D			
11,5	31,0	27,8			

### Ordering Information

Serie	Contact Material	Contact Plating	ROHS	Packing		
-------	------------------	-----------------	------	---------	--	--

<b>B23120</b>	-	<b>ST</b>	<b>NI</b>	<b>R</b>	<b>BU</b>	
---------------	---	-----------	-----------	----------	-----------	--

		<b>N=</b> Non ROHS	<b>BU=</b> Bulk-Ware
		<b>R=</b> ROHS Conform	<b>TR=</b> Tape / Reel
<b>ST=</b> Steel	<b>NI=</b> Nickel plated		

### Battery Coin Cell Holder THT

Part No.: **B23120**

Customer:

DRW:	Jason	CHKD	Jules	MATL:	Wu	DATE	04.11.2018
APPD:	Join			FINISH	Shieh	Sheet	1 from 3



**Technical Dimensions (inch / mm)**

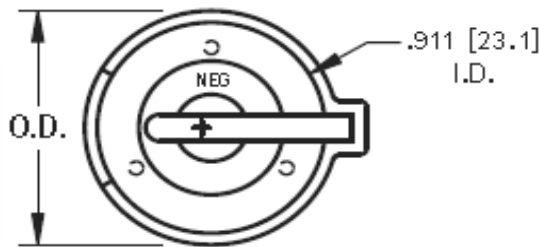
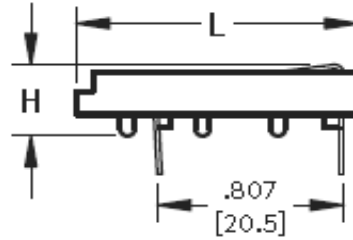
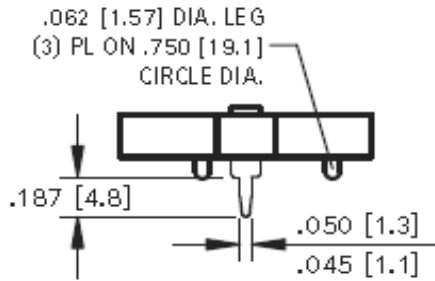

**PCB Layout (inch / mm)**

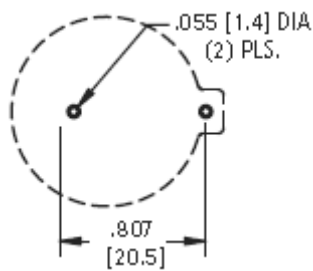

<b>Battery Coin Cell Holder</b>	
<b>THT</b>	
Part No.:	<b>B23120</b>
Customer:	

DRW:	Jason	CHKD	Jules	MATL:	Wu	DATE	04.11.2018
APPD:	Join			FINISH	Shieh	Sheet	2 from 3



**Soldering Profile Curve**

**Classification Reflow Profile (JEDEC J-STD-020C)**

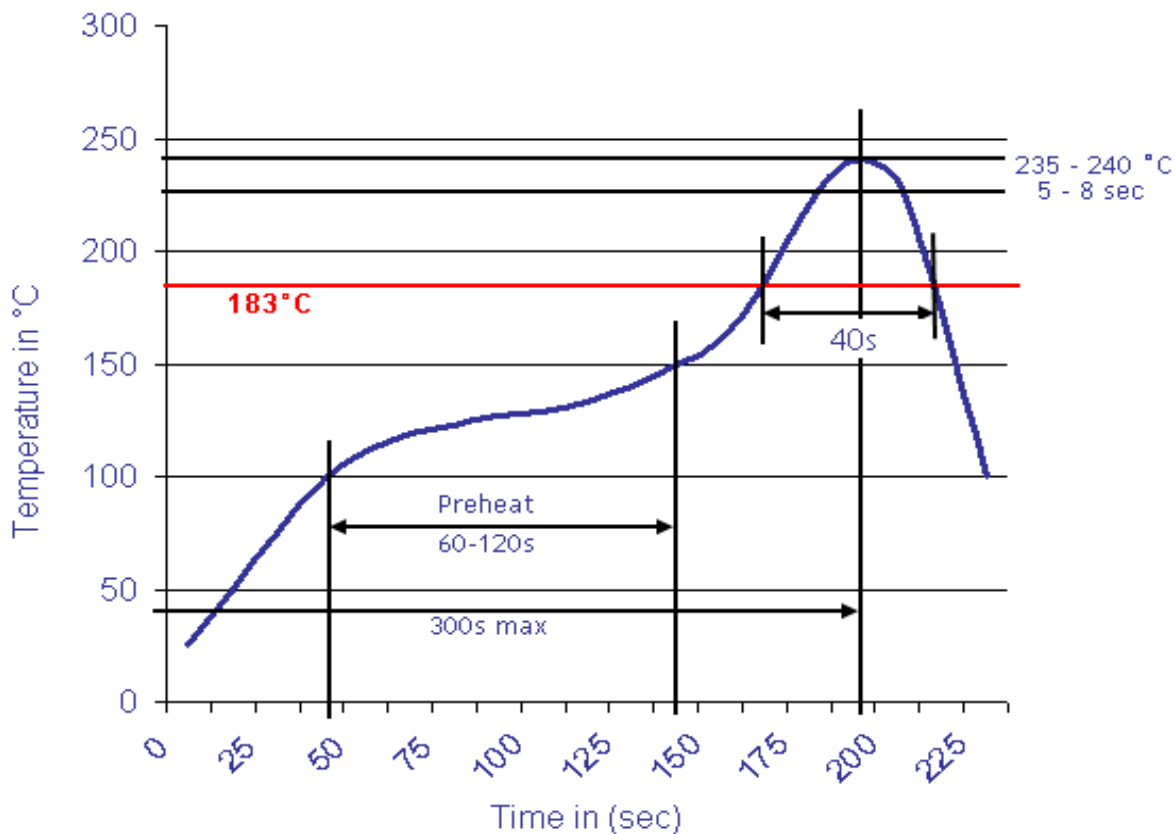

**Battery Coin Cell Holder  
THT**

Part No.: **B23120**

Customer:

DRW:	Jason	CHKD	Jules	MATL:	Wu	DATE	04.11.2018
APPD:	Join			FINISH	Shieh	Sheet	3 from 3