

Data Sheet

Plug Screwless-Type w/o mounting Flange

Pitch: 5,08 mm

Serie: A14M192

Customer Information for special Item

EDCON Customer : 0

Customer Version No. : 0

EDCON-COMPONENTS

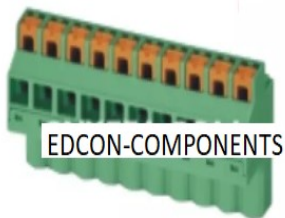

Technical Description

UL/CUL Techn.Data			
Use Group	B	C	D
Rated Voltage: (V)	300	-	300
Rated Current: (A)	12	-	10
Wire Range Solid / Stranged	24~12AWG		
Withstanding Voltage:	1600V/1Min		
IEC Techn. Data VDE			
Overvoltage Category	III	III	II
Contamination Class	3	2	2
Rated Voltage: (V)	250	320	630
Rated Current: (A)	12	12	12
Impulse withstand Voltage (KV)	4,0	4,0	4,0
Conductor Cross Section (mm ²)	0,5~2,5mm ²		

Material

Insulator Material:	PA66
Imflammability:	UL94V-0
Contact Material	Copper Alloy
Surface Coating:	Tin Plated

Other Informations

Pitch:(mm)	5,08
Poles: (P)	2 ~ 24
Stripping Length: (mm)	10~11
Srew Torque max.(Nm)	
Operating Temp.: (°C)	-.40°C to +105°C
Pin Dimension: (mm)	
PCB Hole Diamter (mm)	
Screw-Size	

Drawing (Dimension in mm)

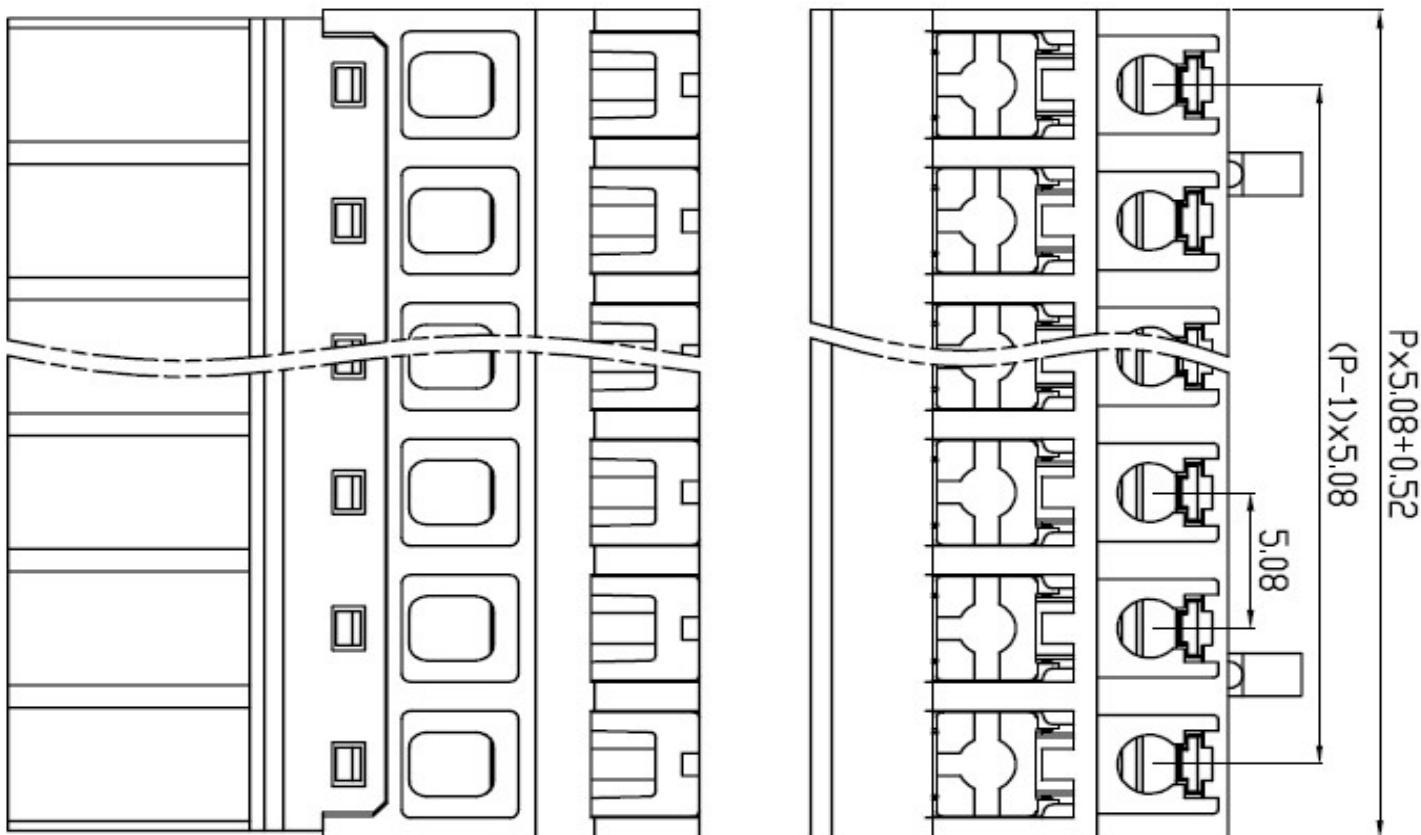

Tolerances unless otherwise specified (mm)

x	x.x	x.xx	x.xxx	Angle
±	±0,60	±0,30	±0,10	±3°

Plug Screwless-Type w/o mounting Flange

Part No.: **A14M192**

Customer:

DRW:	Jason	CHKD	Wilson	MATL:	Wilson	TOLERANCE	Mason	DATE	23.07.2023
APPD:	Schumi			FINISH	Jamy			Sheet No.	1 from 3

www.edcon-components.com

email: info@edcon-components.com

EDCON-COMPONENTS

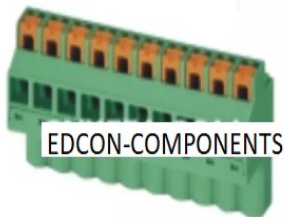

Drawing (Dimension in mm)

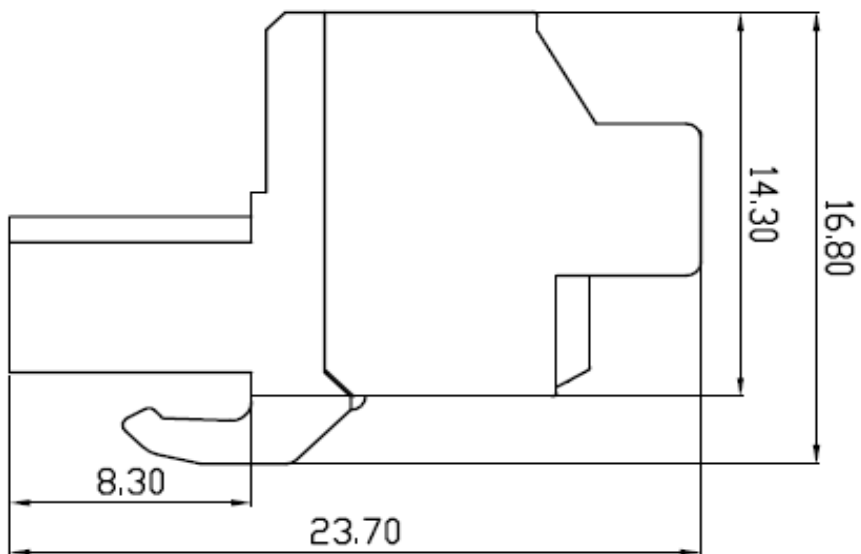

Plug Screwless-Type w/o mounting Flange	
Part No.:	A14M192
Customer:	

DRW:	Jason	CHKD	Wilson	MATL:	Wilson	TOLERANCE	Mason	DATE	23.07.2023
APPD:	Schumi			FINISH	Jamy		Sheet No.		2 from 3

www.edcon-components.com

email: info@edcon-components.com

EDCON-COMPONENTS

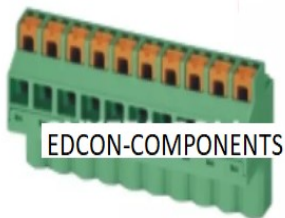

Ordering Informations

Serie	No. of Pos.	Body Color	Screw Type	Approval Code	ROHS	Packing	EDCON Cust. No.	Customer Version		
-------	-------------	------------	------------	---------------	------	---------	-----------------	------------------	--	--

A14M192	XX	PG	C	N	R	B				
----------------	-----------	-----------	----------	----------	----------	----------	--	--	--	--

Pitch
5,08

02 = Number of Pos. Standard 2 ~ 24Pos.	PG = Phoenix Green (Standard) WH = White GN = Green GY = Gray LG = Light Gray OR = Orange BL = Blue BK = Black	 C = Screwless Type	N = NON Approval A = UL /UR Approval Please consult EDCON for available B = VDE Approval Please consult EDCON for available C = TÜV Approval Please consult EDCON for available	R = ROHS Conform N = NON ROHS Conform	B = Bulk-Ware I = Individual Package	xxxxxx = Customer Number	xxx = Customer Version ??(Printing)
---	---	---	---	--	---	---------------------------------	---

Plug Screwless-Type w/o mounting Flange
Part No.: A14M192
Customer:

DRW:	Jason	CHKD	Wilson	MATL:	Wilson	TOLERANCE	Mason	DATE	23.07.2023
APPD:	Schumi			FINISH	Jamy		Sheet No.		3 from 3