

# EDCON-COMPONENTS

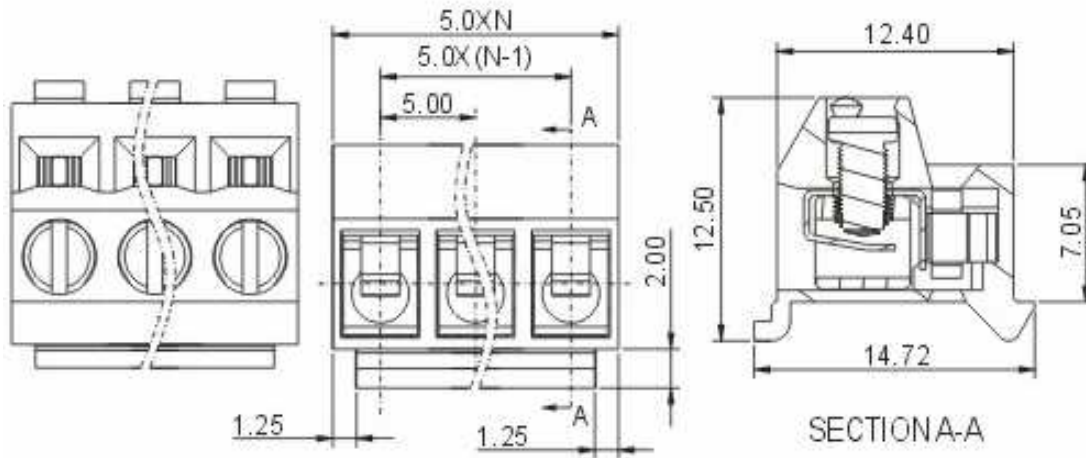

## Drawing



## P.C.B. Layout

## Specification

APPROVAL	ULus	CE
<b>Electrical</b>	UL	IEC
Standard	300V	250V
Rated voltage	10A	12A
Rated current	28-14 AWG	2.5mm <sup>2</sup>
Wire range	Withstanding voltage AC2000V/1Min	
Withstanding voltage	<b>Mechanical</b>	
<b>Mechanical</b>	Ambient temperature -40°C ~ +105°C	
Ambient temperature	Strip length 5 ~ 6mm	
Strip length	Screw, Torque M2.5, 0.4Nm (3.5Lb-In.)	
Screw, Torque	<b>Dimensions</b>	
<b>Dimensions</b>	Pitch 5.00mm	
Pitch	Poles 2P - 20P	
Poles	<b>Material</b>	
<b>Material</b>	Housing PA66 (UL94V-0)	
Housing	Contact Phosphor Bronze	
Contact	Screw steel, Cr <sup>3+</sup> Zn plated	
Screw	Cage Brass, Ni plated	
Cage		



## Certification



Wire Protector Terminal Block /  
Pitch 5.00mm

Part No.: A12L012

Customer:

DRW:	Bill	CHKD	Lord	MATL:	Jimmy	TOLERANCE	Sam	DATE	14.03.2009
APPD:	Louis			FINISH	Georg		Sheet No.		1 from 3

[www.edcon-components.com](http://www.edcon-components.com)

email: [info@edcon-components.com](mailto:info@edcon-components.com)

# EDCON-COMPONENTS



## Ordering Informations

Serie	-	No. of Pole	Body-Color	wire protector	Screw	-	Customer Request
A12L012	-	XX	XX	X	X	-	X

XX = total	WH - white	1 - with wire protector	A - Slotted screw (standard)
	GN - green	2 - without wire protector	B - Cross-slotted screw
	GR - gray		
	LG - light gray		



PG - Phoenix Green
OR - orange
BL - blue
BK - black



wire protector

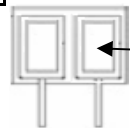

without wire protector



**Certification**



Wire Protector Terminal Block /  
Pitch 5.00mm

Part No.: A12L012

Customer:

DRW:	Bill	CHKD	Lord	MATL:	Jimmy	TOLERANCE	Sam	DATE	14.03.2009
APPD:	Louis			FINISH	Georg			Sheet No.	2 from 3

[www.edcon-components.com](http://www.edcon-components.com)

email: [info@edcon-components.com](mailto:info@edcon-components.com)



Soldering - Profil

Classification Reflow Profile (JEDEC J-STD-020C)

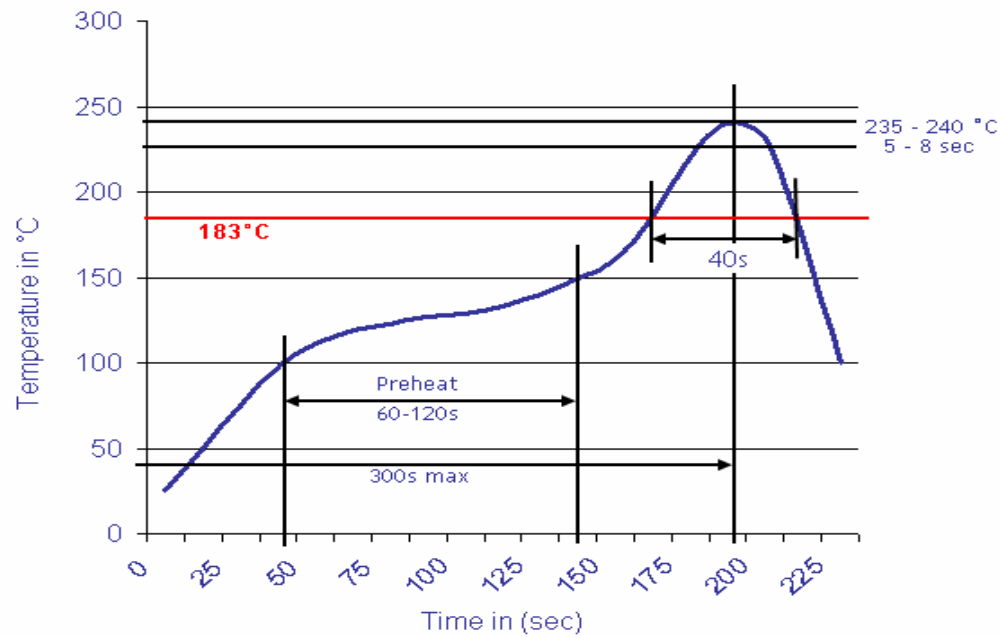

Wire Protector Terminal Block /  
Pitch 5.00mm

Part No.: A12L012

DRW:	Bill	CHKD	Lord	MATL:	Jimmy	TOLERANCE	Sam	DATE	14.03.2009
APPD:	Louis			FINISH	Georg		Sheet No.	3 from 3	

Customer: