

Data Sheet

Screwless Terminal Block Pitch 7,62mm

Pitch: 7,62 mm

Serie: A11R037

Customer Information for special Item

EDCON Customer : xxxxxx

Customer Version No. : xx

EDCON-COMPONENTS



Technical Discription

Electrical:

	UL	IEC	VDE
Rated voltage:	300V	300V	
Rated current:	20A	18A	
Withstanding Voltage: AC/1min:	2000V	2000V	
Operating Temperature:	-40°C ~ +105°C		

Mechanical:

	8-9mm	8-9mm	
Strip length: mm	8-9mm	8-9mm	
Wire range: Solid wire: AWG	28-12	2,5mm ²	
Wire range: Stranded wire:AWG			

Material:

Housing Terminal Body:	PA66 UL94V-0
Housing Left-side:	PA66 UL94V-0
Housing Right side:	PA66 UL94V-0
Lever:	
Terminal:	Copper Matte Tin plated over Nickel
Spring Clamp:	Stainless steel

Drawing (Dimension in mm)

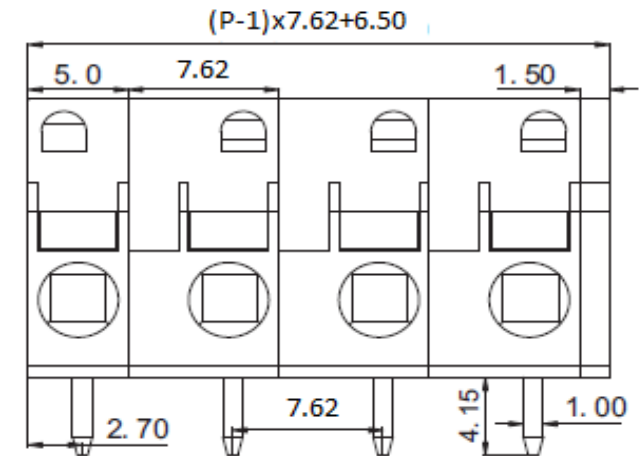
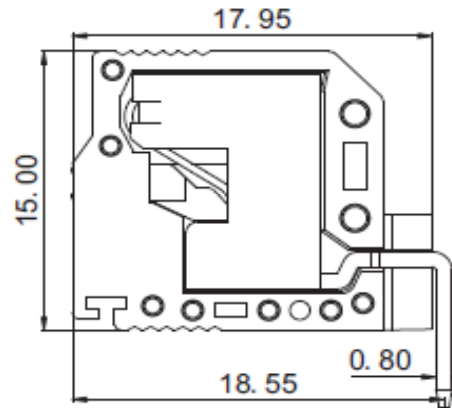

Item No.		
1		
2		
3		
4		
5		
6		
7		
8		
9		

Tolerances unless otherwise specified (mm)				
X	X.X	X.XX	X.XXX	Angle
±	±	±	±	±3°
DRW:	Jason	CHKD	Wilson	MATL:
APPD:	Schumi			FINISH

Screwless Terminal Block Pitch 7,62mm	
Part No.:	A11R037
Customer:	

DRW:	Jason	CHKD	Wilson	MATL:	Wilson	TOLERANCE	Mason	DATE	30.11.2020
APPD:	Schumi			FINISH	Jamy			Sheet No.	1 from 4

EDCON-COMPONENTS



PCB Layout Dimension (mm)
TOP-VIEW

Dimensions (mm)

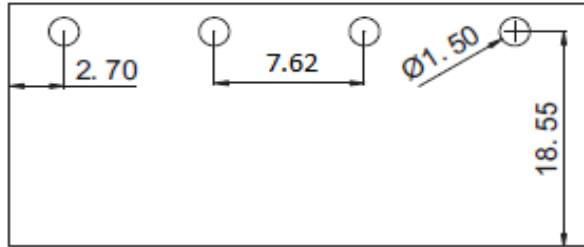

Frontside

**Screwless Terminal Block Pitch
7,62mm**

Part No.: **A11R037**

DRW:	Jason	CHKD	Wilson	MATL:	Wilson	TOLERANCE	Mason	DATE	30.11.2020
APPD:	Schumi			FINISH	Jamy		Sheet No.	2 from 4	Customer:

www.edcon-components.com

email: info@edcon-components.com

EDCON-COMPONENTS



Ordering Informations

Serie	No. of Pos.	Body Color	Srew Type	Approval Code	ROHS	Packing	EDCON Cust. No.	Customer Version		
A11R037	02	GY	C	N	R	B	xxxxxx	xx		

Pitch
7,62

02 = Number of Pos.	GY = Gray (Standard)	C = Screwless Type	N = NON Approval	R = ROHS Conform	B = Standard Package Box/ Polybag	xxxxxx = Customer Number	xx = Customer Version (Printing) ??
Standard 2 ~ 16Pos.			1 = UL-Approval for Body Material	N = NON ROHS Conform	I = Individual Package		
			A = UL /UR Approval Please consult EDCON for available				
			B = VDE Approval Please consult EDCON for available				
			C = TÜV Approval Please consult EDCON for available				

Screwless Terminal Block Pitch	
7,62mm	
Part No.:	A11R037
Customer:	

DRW:	Jason	CHKD	Wilson	MATL:	Wilson	TOLERANCE	Mason	DATE	30.11.2020
APPD:	Schumi			FINISH	Jamy		Sheet No.		3 from 4

www.edcon-components.com

email: info@edcon-components.com

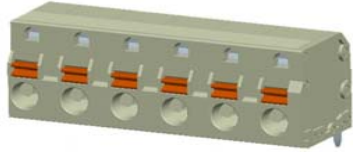

Soldering Profile Curve

Classification Reflow Profile (JEDEC J-STD-020C)

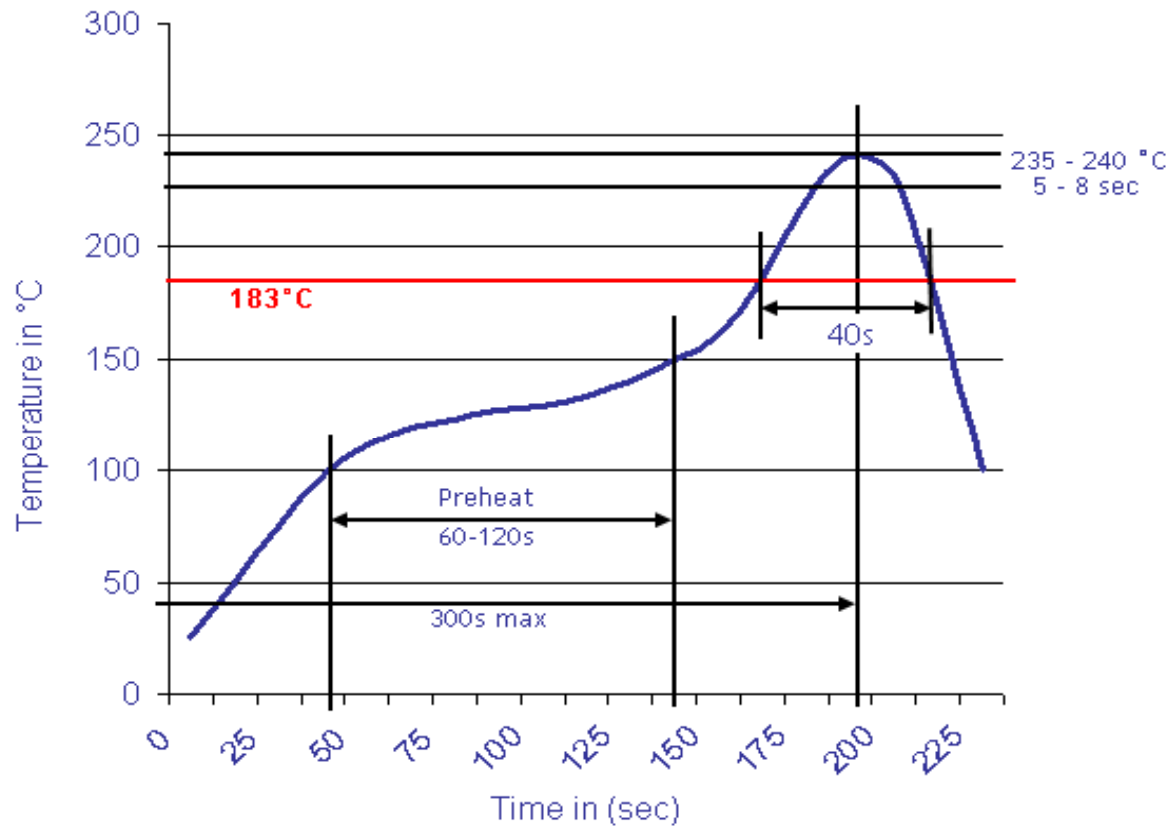

Screwless Terminal Block Pitch
7,62mm

Part No.: **A11R037**

Customer:

DRW:	Jason	CHKD	Wilson	MATL:	Wilson	TOLERANCE	Mason	DATE	30.11.2020
APPD:	Schumi			FINISH	Jamy		Sheet No.		4 from 4