

# Data Sheet

## Screwless Terminal Block

**Pitch: 7,50 mm**

**Serie: A11Q011**

### Customer Information for special Item

**EDCON Customer : 0**

**Customer Version No. : 0**

# EDCON-COMPONENTS

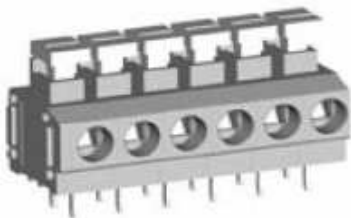

## Technical Discription

## Drawing (Dimension in mm)

### Electrical

Standard  
 Rated voltage  
 Rated current  
 Solid / Stranded wire  
 Withstanding voltage

cULus	VDE
300V	450V
10A	6A
20-14 AWG	0.5mm <sup>2</sup>
1.6KV	2.5KV

### Mechanical

Wire strip length  
 Ambient temperature  
 Soldering temperature

6 ~ 7mm  
 -40°C ~ +115°C  
 250°C ±10°C/5 sec

### Dimensions

Pitch  
 Poles

7.50mm  
 2P - 24P

### Material

Housing  
 Pin header  
 Wire guard

Thermoplastic (UL94V-0)  
 Brass, Tin plated  
 Stainless steel

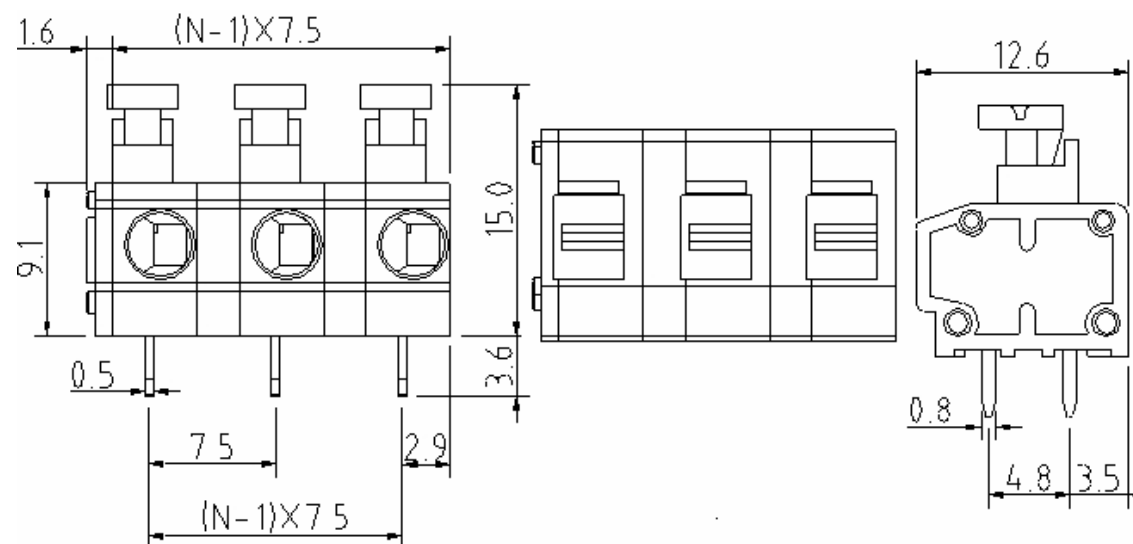

### Screwless Terminal Block

Part No.: **A11Q011**

Customer:

DRW:	Jason	CHKD	Wilson	MATL:	Wilson	TOLERANCE	Mason	DATE	04.02.2014
APPD:	Schumi			FINISH	Jamy		Sheet No.	1 from 4	

# EDCON-COMPONENTS

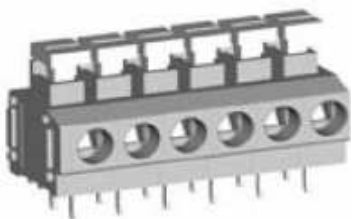

PCB Layout (Dimension in mm)

Dimensions (mm)

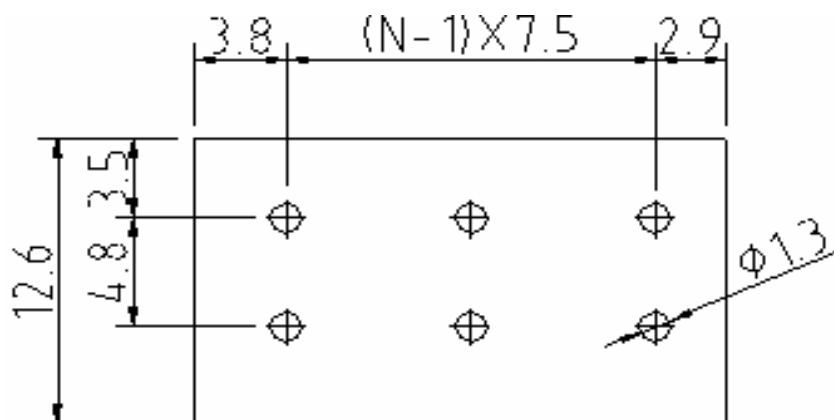

No. of Pos.	A	Tol. P	B	Tol. P
02	16,60	± 0,35	7,50	± 0,35
03	24,10	± 0,35	15,00	± 0,35
04	31,60	± 0,35	22,50	± 0,35
05	39,10	± 0,35	30,00	± 0,35
06	46,60	± 0,35	37,50	± 0,35
07	54,10	± 0,35	45,00	± 0,35
08	61,60	± 0,35	52,50	± 0,35
09	69,10	± 0,35	60,00	± 0,35
10	76,60	± 0,35	67,50	± 0,35
11	84,10	± 0,35	75,00	± 0,35
12	91,60	± 0,35	82,50	± 0,35
13	99,10	± 0,35	90,00	± 0,35
14	106,60	± 0,35	97,50	± 0,35
15	114,10	± 0,35	105,00	± 0,35
16	121,60	± 0,35	112,50	± 0,35
17	129,10	± 0,35	120,00	± 0,35
18	136,60	± 0,35	127,50	± 0,35
19	144,10	± 0,35	135,00	± 0,35
20	151,60	± 0,35	142,50	± 0,35
21	159,10	± 0,35	150,00	± 0,35
22	166,60	± 0,35	157,50	± 0,35
23	174,10	± 0,35	165,00	± 0,35
24	181,60	± 0,35	172,50	± 0,35

**Screwless Terminal Block**

Part No.: **A11Q011**

Customer:

DRW:	Jason	CHKD	Wilson	MATL:	Wilson	TOLERANCE	Mason	DATE	04.02.2014
APPD:	Schumi			FINISH	Jamy		Sheet No.	2 from 4	

# EDCON-COMPONENTS

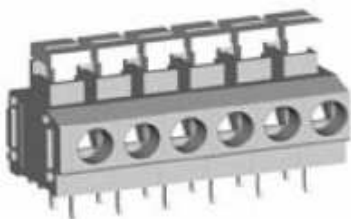

## Ordering Informations

Serie	No. of Pos.	Body Color	Approval	Approval Code	ROHS	Packing	EDCON Cust. No.	Customer Version		
<b>A11Q011</b>	<b>02</b>	<b>GY</b>	<b>N</b>	<b>N</b>	<b>R</b>	<b>B</b>				

Pitch  
7,50

<b>02=</b> Number of Pos. Standard 2~24 Pos.	<b>GY=</b> Gray (Standard)  <b>GN=</b> Green  <b>OR=</b> Orange  <b>BK=</b> Black	<b>N=</b> No Approval  <b>1=</b> Approval for Material  <b>2=</b> Approval for Terminal Block	<b>N=</b> NON Approval  <b>A=</b> UL /UR Approval Please consult EDCON for available  <b>B=</b> VDE Approval Please consult EDCON for available  <b>C=</b> TÜV Approval Please consult EDCON for available	<b>R=</b> ROHS Conform  <b>N=</b> NON ROHS Conform	<b>B=</b> Standard Package  <b>I=</b> Individual Package	<b>xxxxxx=</b> Customer Number	<b>xxx=</b> Customer Version ??(Printing)
---	---	---	--	--	--	--------------------------------	---

<b>Screwless Terminal Block</b>	
Part No.:	<b>A11Q011</b>
Customer:	

DRW:	Jason	CHKD	Wilson	MATL:	Wilson	TOLERANCE	Mason	DATE	04.02.2014
APPD:	Schumi			FINISH	Jamy		Sheet No.		3 from 4

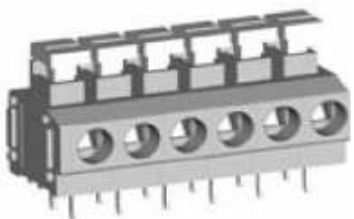

Soldering Profile Curve

Classification Reflow Profile (JEDEC J-STD-020C)



**Screwless Terminal Block**

Part No.: **A11Q011**

Customer:

DRW:	Jason	CHKD	Wilson	MATL:	Wilson	TOLERANCE	Mason	DATE	04.02.2014
APPD:	Schumi			FINISH	Jamy		Sheet No.	4 from 4	



