

# Data Sheet

## Screwless Terminal Block

**Pitch: 2,50 mm**

**Serie: A11E005**

### Customer Information for special Item

**EDCON Customer : 0**

**Customer Version No. : 0**

# EDCON-COMPONENTS

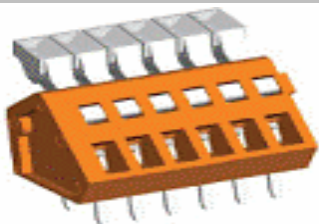

## Technical Discription

## Drawing (Dimension in mm)

### Electrical

Standard	UL
Rated voltage	150V
Rated current	4A
Solid wire	28-22 AWG
Stranded wire	28-22 AWG
Withstanding voltage	1.3 KV

### Mechanical

Ambient temperature	-40°C ~ 115°C
Soldering temperature	250°C ± 10°C/5sec
Strip length	6 ~ 7mm

### Dimensions

Pitch	2.50mm
Poles	1P - xxP

### Material

Housing	Thermoplastic, UL94V-0
Pin header	Brass
Wire guard	Stainless steel

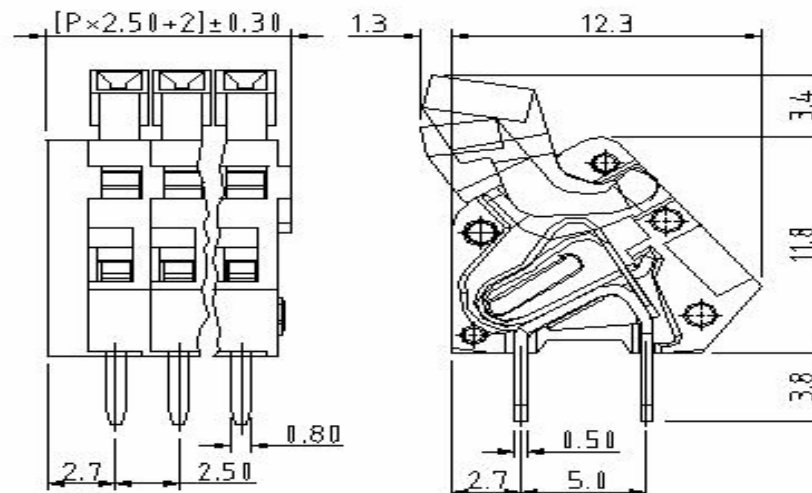

### Screwless Terminal Block

Part No.: **A11E005**

Customer:

DRW:	Jason	CHKD	Wilson	MATL:	Wilson	TOLERANCE	Mason	DATE	27.01.2014
APPD:	Schumi			FINISH	Jamy		Sheet No.	1 from 4	

# EDCON-COMPONENTS

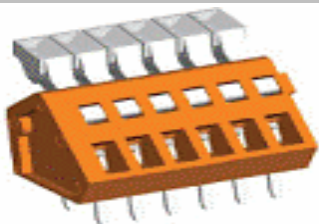

PCB Layout (Dimension in mm)

Dimensions (mm)

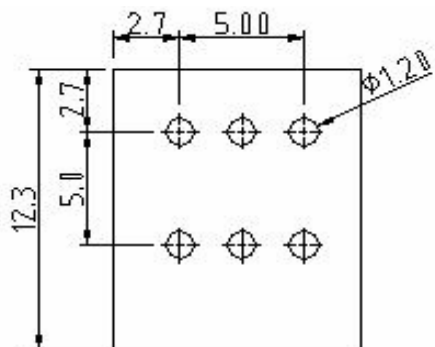

No. of Pos.	A	Tol. P	B	Tol. P
02	7,00	$\pm 0,35$	2,50	$\pm 0,35$
03	9,50	$\pm 0,35$	5,00	$\pm 0,35$
04	12,00	$\pm 0,35$	7,50	$\pm 0,35$
05	14,50	$\pm 0,35$	10,00	$\pm 0,35$
06	17,00	$\pm 0,35$	12,50	$\pm 0,35$
07	19,50	$\pm 0,35$	15,00	$\pm 0,35$
08	22,00	$\pm 0,35$	17,50	$\pm 0,35$
09	24,50	$\pm 0,35$	20,00	$\pm 0,35$
10	27,00	$\pm 0,35$	22,50	$\pm 0,35$
11	29,50	$\pm 0,35$	25,00	$\pm 0,35$
12	32,00	$\pm 0,35$	27,50	$\pm 0,35$
13	34,50	$\pm 0,35$	30,00	$\pm 0,35$
14	37,00	$\pm 0,35$	32,50	$\pm 0,35$
15	39,50	$\pm 0,35$	35,00	$\pm 0,35$
16	42,00	$\pm 0,35$	37,50	$\pm 0,35$
17	44,50	$\pm 0,35$	40,00	$\pm 0,35$
18	47,00	$\pm 0,35$	42,50	$\pm 0,35$
19	49,50	$\pm 0,35$	45,00	$\pm 0,35$
20	52,00	$\pm 0,35$	47,50	$\pm 0,35$
21	54,50	$\pm 0,35$	50,00	$\pm 0,35$
22	57,00	$\pm 0,35$	52,50	$\pm 0,35$
23	59,50	$\pm 0,35$	55,00	$\pm 0,35$
24	62,00	$\pm 0,35$	57,50	$\pm 0,35$
25	64,50	$\pm 0,36$	60,00	$\pm 0,36$

**Screwless Terminal Block**

Part No.: **A11E005**

DRW:	Jason	CHKD	Wilson	MATL:	Wilson	TOLERANCE	Mason	DATE	27.01.2014
APPD:	Schumi			FINISH	Jamy		Sheet No.		2 from 4

Customer:

# EDCON-COMPONENTS

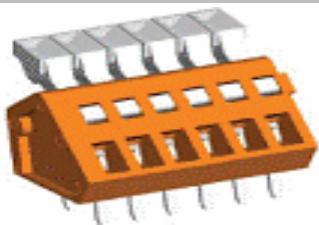

## Ordering Informations

Serie	No. of Pos.	Body Color	Approval	Approval Code	ROHS	Packing	EDCON Cust. No.	Customer Version		
-------	-------------	------------	----------	---------------	------	---------	-----------------	------------------	--	--

<b>A11E005</b>	<b>02</b>	<b>OR</b>	<b>N</b>	<b>N</b>	<b>R</b>	<b>B</b>				
----------------	-----------	-----------	----------	----------	----------	----------	--	--	--	--

Pitch 2,50	02= Number of Pos. Standard 2 ~ 24Pos.	GY= Gray (Standard) GN= Green OR= Orange BK= Black	N= No Approval 1= Approval for Material 2= Approval for Terminal Block	N= NON Approval A= UL /UR Approval Please consult EDCON for available B= VDE Approval Please consult EDCON for available C= TÜV Approval Please consult EDCON for available	R= ROHS Conform N= NON ROHS Conform	B= Standard Package I= Individual Package	xxxxxx= Customer Number	xxx= Customer Version ??(Printing)
---------------	---	---	--	--	--	--	-------------------------	------------------------------------

**Screwless Terminal Block**

Part No.: **A11E005**

Customer:

DRW:	Jason	CHKD	Wilson	MATL:	Wilson	TOLERANCE	Mason	DATE	27.01.2014
APPD:	Schumi			FINISH	Jamy		Sheet No.		3 from 4

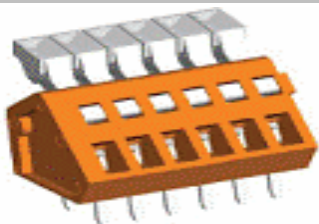

Soldering Profile Curve

Classification Reflow Profile (JEDEC J-STD-020C)

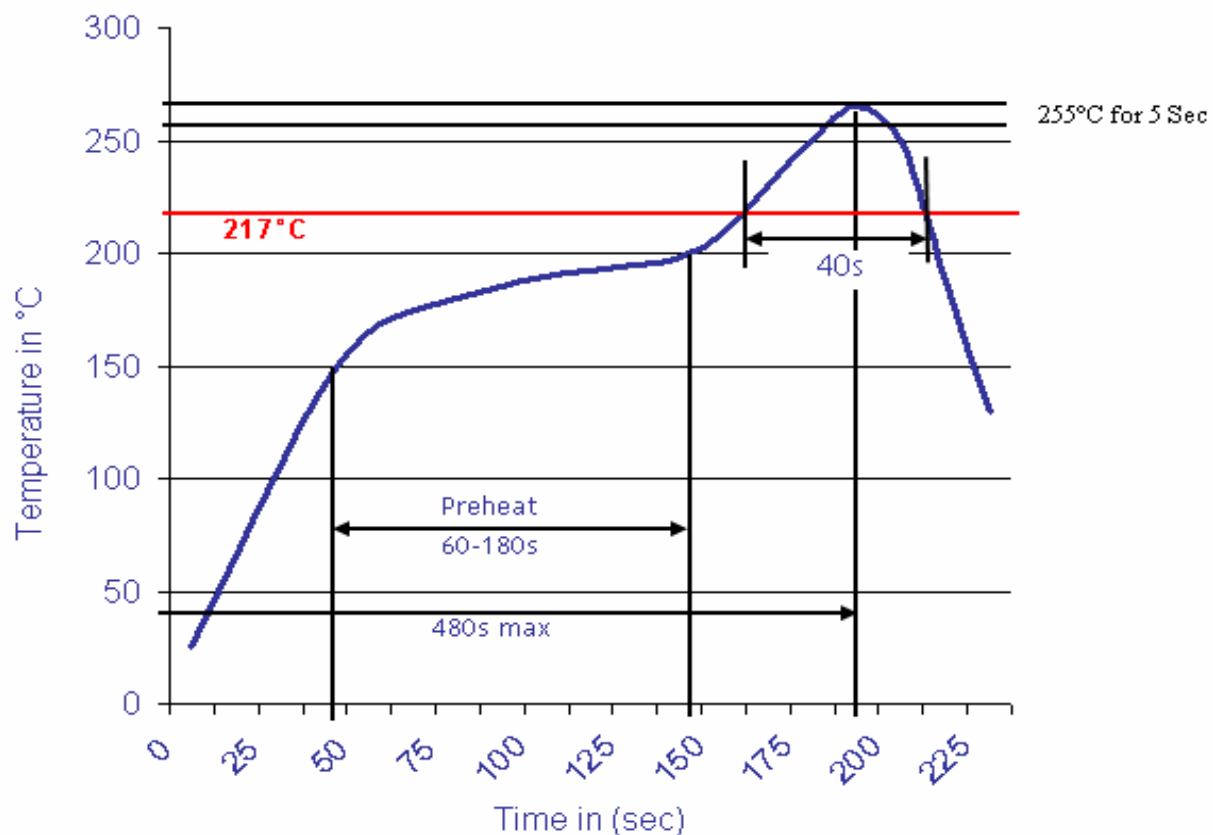

**Screwless Terminal Block**

Part No.: **A11E005**

Customer:

DRW:	Jason	CHKD	Wilson	MATL:	Wilson	TOLERANCE	Mason	DATE	27.01.2014
APPD:	Schumi			FINISH	Jamy		Sheet No.	4 from 4	



